

# This Is A Manual.

Chill Out Ice Maker

### **BEFORE FIRST USE:**

To prevent any internal damage, it is very important to keep refrigeration units (like this one) upright throughout their journey. Please leave it standing upright and outside the box for **24 HOURS** before plugging it in.

### **TABLE OF CONTENTS**

Important Safety Instructions	5
Product Overview	6
Preparing to Use	7
Using Your Ice Maker	7
Cleaning & Maintenance	8
Troubleshooting	8
Specifications	9
Warranty	9
Manufacturing Info	10
Warning	10
Contact Us	10

# IMPORTANT SAFETY INSTRUCTIONS

To reduce the risk of fire, explosion, electric shock, or injury when using your ice maker, follow these important safety instructions. If physical injury or damage is caused by failure to follow these instructions, the warranty does not apply.

## WARNING RELATED TO ELECTRICITY

- Make sure that the available AC power corresponds to the voltage requirements of this Ice Maker.
- Do not remove any safety, warning, or product information labels from your Ice Maker.
- This Ice Maker is equipped with a 3-conductor cord that has a 3-prong grounding plug. It should be properly plugged into an exclusive 3-prong grounding outlet. No other appliance should be plugged into the same outlet. Make sure that the plug is fully inserted into the receptacle.
- Never attempt to modify or extend the power cord. If you must use an extension cord, use only a 3-conductor extension cord with a 3-prong grounding plug, and the marked rating of the extension cord should be equal to or greater than that of this Ice Maker.
- If the power cord is damaged, please contact us at **646.490.9904**.
- Protect the power cord from being walked on or pinched particularly around the plug, electrical sockets or at their point of contact with the Ice Maker.
- Unplug the power cord by holding the plug, never by pulling the cord.
- Use attachments or accessories specified by the manufacturer only.
- Turn off the Ice Maker before unplugging it. Do not turn on or off by plugging or unplugging the power cord.
- Unplug this Ice Maker before cleaning and maintaining or when not in use for an extended period of time.
- Unplug this Ice Maker during lightning storms.
- Do not handle the plug with wet hands. This could result in an electric shock.

## WARNING RELATED TO USE

- Do not use this Ice Maker outdoors. Do not expose to direct sunlight.
- Do not block any ventilation openings. Keep a minimum distance of 6 inches on each side of this Ice Maker.
- Do not touch the Evaporator when operating to avoid potential injury.
- Do not expose to dripping or splashing liquids, and no objects filled with liquids should be placed on top of this Ice Maker.
- Keep far away from heat sources, such as ovens, heaters, corrosive gases or other flammable articles. Never use this Ice Maker when there is flammable gas leakage.
- If the Ice Maker tips or falls, it may cause damage. If it is overturned accidentally, upright it and let it sit for 24 hours before use. Please allow time for the fluids in the compressor to settle after the Ice Maker is moved or transported.
- Unplug the Ice Maker before moving it to avoid damaging the refrigerating system.
- Never attempt to disassemble, repair, modify, or replace any part of this Ice Maker.
- Do not leave it unattended while in use.
- Keep out of reach of children. Never allow children to play with or operate this Ice Maker.
- Do not fill the Water Tank with hot water, which may cause damage to the Ice Maker.
- Do not operate this Ice Maker at an extreme ambient temperature.
- Comply with federal and local regulations when disposing of this Ice Maker, due to its flammable refrigerant and blowing gas.

**SAVE THESE INSTRUCTIONS**

For Household Use Only

## Product Overview

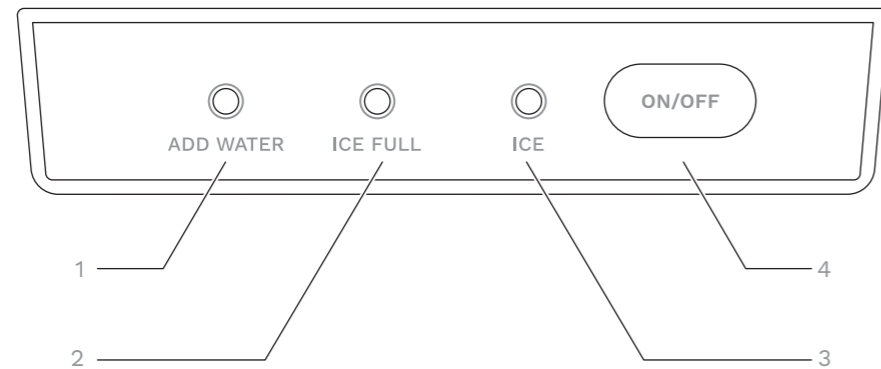
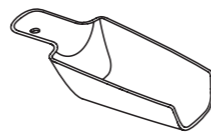
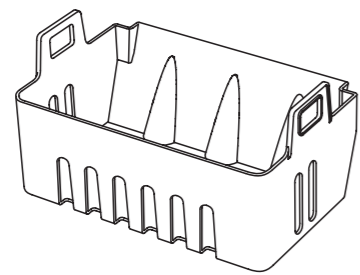
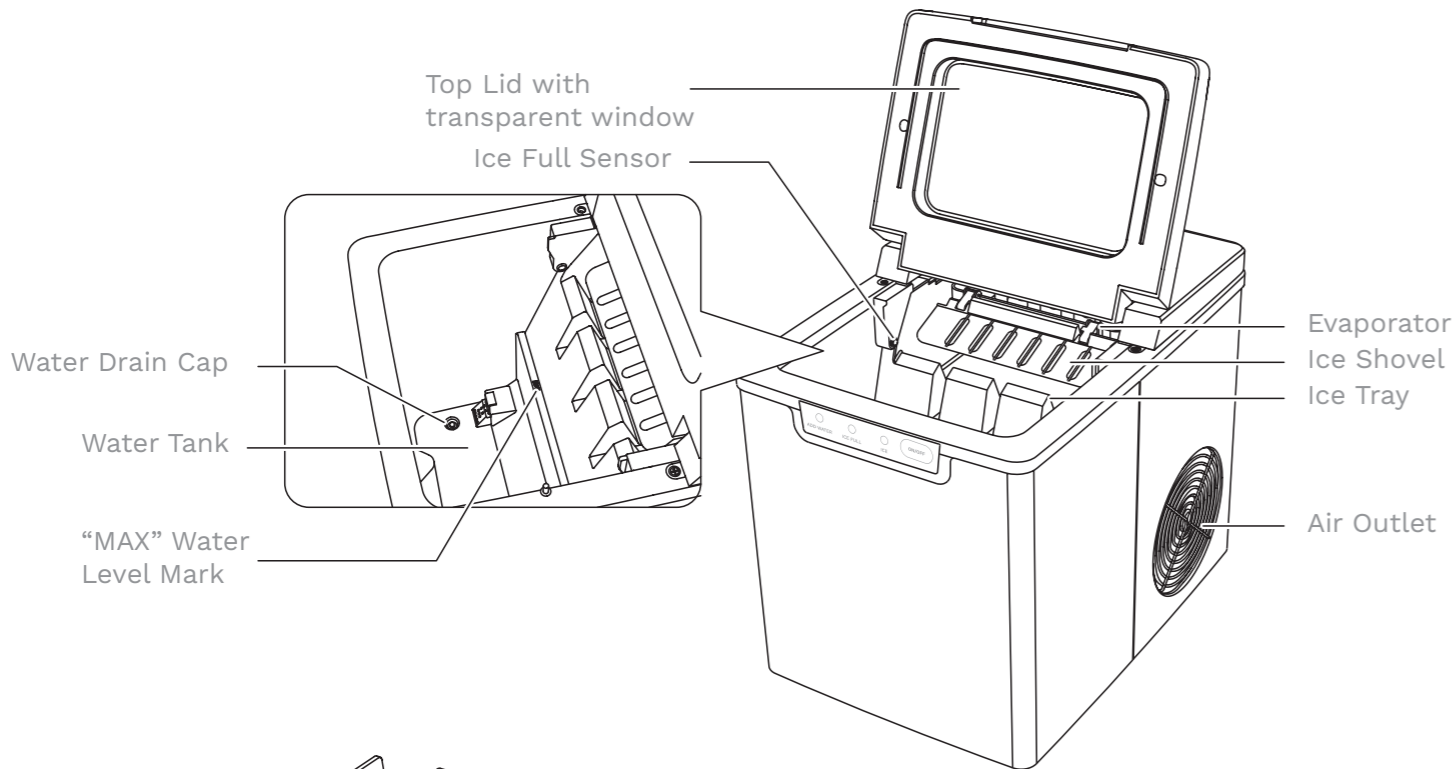

1. Water Shortage Indicator
2. Ice Full Indicator
3. Status Indicator (flashes when standby mode and solidly lights when working)
4. Power Button

## Preparing to Use

1. Clean the Water Tank and Ice Basket with warm water, diluted detergent, and a soft cloth. See **"Cleaning & Maintenance"** for more details.
2. Place your Ice Maker on a dry, flat, and sturdy surface. Leave a clearance of 8 inches (20 cm) on each side of the Ice Maker for proper ventilation (see Fig. 3).
3. Wait for 24 hours to allow the refrigerant fluid to settle, then plug the Ice Maker into a 3-prong grounding wall outlet.
4. Discard the first few batches of ice when using it for the first time or after an extended period of time.

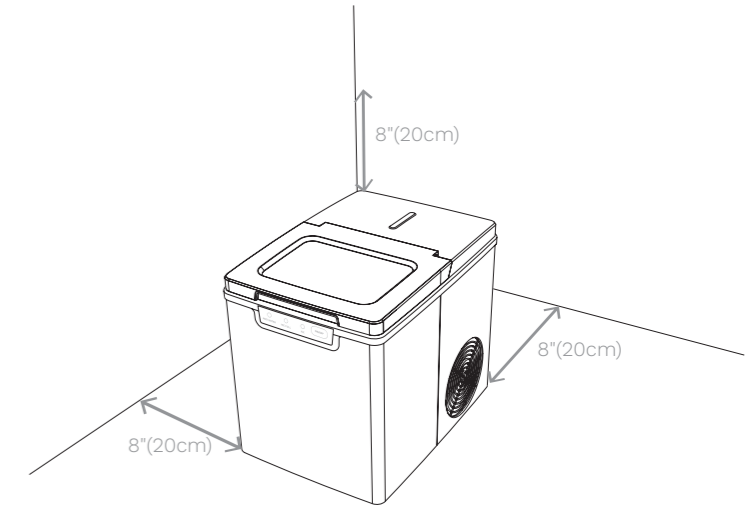

Fig. 3

## Using your Ice Maker

\*Prior to using your Ice Maker each time, wipe out the interior with a clean, damp cloth.

1. Check if the Water Drain Cap at the bottom of Water Tank is closed well (see Fig. 4).

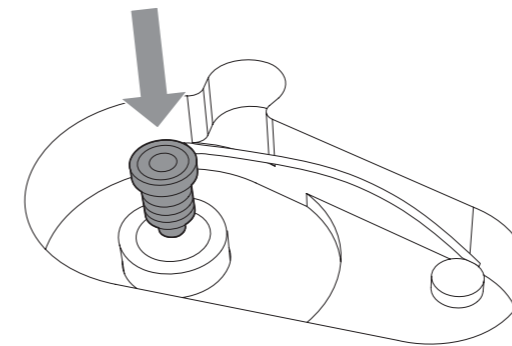

Fig. 4

2. Open the Top Lid and take out the Ice Basket. Pour water into the Water Tank up to the "MAX" Water Level Mark (see Fig. 5).

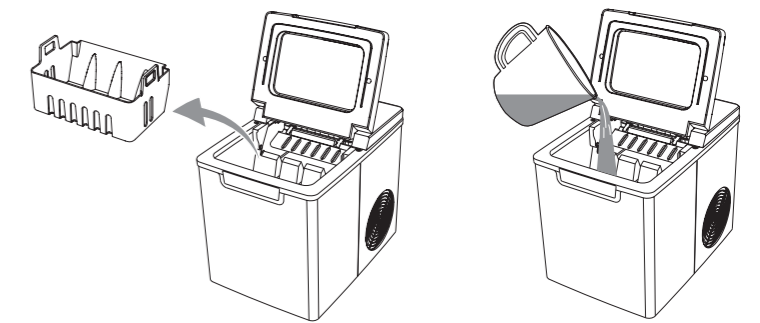

Fig. 5

3. Replace the Ice Basket and close the Top Lid.
4. Press the **"ON/OFF"** button and the indicator will light up to show that the Ice Maker is running.
  - The ice-making cycle will last approximately 8-10 minutes.
  - When the ice basket is full, the **"ICE FULL"** indicator will light up and Ice making cycle will stop, return to idle state and will not resume operation until the ice basket is emptied or reduced.
  - The **"ADD WATER"** indicator will light up when the water tank is empty and the Ice making cycle will stop, return to idle state and will not resume operation until water tank is refilled or replenished with fresh water

5. Gently remove the ice with the Ice Scoop.
  - To avoid damage to this Ice Maker, fill the Water Tank with room temperature or cooler water, instead of hot water.
  - Change the water in the Water Tank at least every 24 hours to ensure a reasonable hygiene level and avoid bad-smelling ice.

## Cleaning & Maintenance

To keep your ice tasting fresh and your Ice Maker looking great, clean your Ice Maker regularly.

1. Power off the Ice Maker and unplug it from the wall outlet.
2. If residual water is found in the Ice Tray, gently push the Ice Tray back so that all water drains into the Water Tank.
3. Take out the Ice Basket. Clean the interior with a soft cloth soaked with warm water and diluted detergent.
4. Use water to rinse the interior and drain out all the water by unplugging the Water Drain Cap on the front bottom of the Ice Maker (see Fig. 6).
5. Replace the Water Drain Cap well in position.
6. Clean the exterior with a soft, damp cloth. Use a mild dishwashing soap, if necessary.
  - Do not clean the Evaporator.
  - Do not clean your Ice Maker with flammable fluids. The fumes can create a fire hazard or explosion.
  - Empty the Water Tank and dry it for storage if the Ice Maker is not in use for an extended period of time.

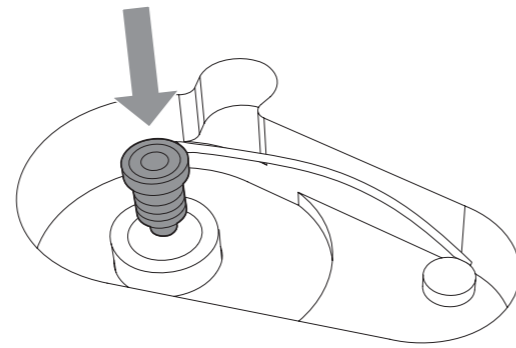

Fig. 6

## Troubleshooting

Do not try to repair the Ice Maker yourself. Doing so invalidates the warranty.

PROBLEM	POSSIBLE CAUSES	SOLUTIONS
"ADD WATER" Indicator lights up.	Low water level or out of water.	Turn the Ice Maker off, refill water, and turn it on.
"ICE FULL" Indicator lights up.	The Ice Basket is full.	Remove the ice from the Ice Basket.
	The Ice Full Sensors do not work.	<ul style="list-style-type: none"> <li>• Wipe out any objects on the Sensors and restart the Ice Maker.</li> <li>• Call us at <b>646.490.9904</b>.</li> </ul>
"ADD WATER" and "ICE FULL" Indicators light up simultaneously.	The Ice Tray is not in the right position.	<ul style="list-style-type: none"> <li>• Check if the Ice Tray is blocked by something.</li> <li>• Unplug and plug it again, then press the <b>"ON/OFF"</b> button to restart.</li> </ul>
The ice collects together.	The ice-making cycle is too long.	Stop making ice and restart after the ice melts.
	The water temperature is too cold.	Fill the Water Tank with warmer water.
The Ice Maker runs through its normal cycle but no ice is produced.	The ambient temperature or water temperature is too high.	Operate the Ice Maker at an environment with an ambient temperature between 50°F and 90°F. Fill the Water Tank with water ranges between 46°F and 77°F.
	Refrigerating system leaks or is blocked.	Call us at <b>646.490.9904</b> .
The Ice Maker does not stop working even when full.	Direct or reflected sunlight may cause malfunction of the Ice Full Sensors.	Move the Ice Maker to a darker location.
Poor ice-making result.	Poor heat dissipation.	Leave an 8-inch clearance on each side of the Ice Maker for proper ventilation.

## Specifications

\*Specifications are subject to change without notice.

Applicable climate	ST/SN/T/N
Class	I
Input	120 V ~ 60 Hz
Rated power	120 W
Dimension (D*W*H)	13.7*9.8*11.4 in / 348*248*290 mm
Net weight	20.86 lbs / 9.48 kg

## Warranty

Vremi® offers a limited one year warranty ("warranty period") on all of our products purchased new and unused from Vremi®, LLC or an authorized reseller, with an original proof of purchase and where a defect has arisen, wholly or substantially, as a result of faulty manufacture, parts, or workmanship during the warranty period. The warranty does not apply where damage is caused by other factors, including without limitation: (a) normal wear and tear; (b) abuse, mishandling, accident, or failure to follow operating instructions; (c) exposure to liquid or infiltration of foreign particles; (d) servicing or modifications of the product other than by Vremi®; (e) commercial or non-household use.

The Vremi® warranty covers all costs related to restoring the proven defective product through repair or replacement of any defective part and necessary labor, so that it conforms to its original specifications. A replacement product may be provided instead of repairing a defective product. Vremi®'s exclusive obligation under this warranty is limited to such repair or replacement.

The warranty becomes void if attempts at repair are made by non-authorized third parties and/or if spare parts, other than those provided by Vremi®, are used.

These are our general terms for warranty service, but we always urge our customers to reach out to us with any issue, regardless of warranty terms. If you have an issue with a Vremi® product, please contact us at 646-490-9904, and we will do our best to resolve it for you.

This warranty gives you specific legal rights and you may have other legal rights, which vary from state to state, country to country, or province to province. The customer may assert any such rights at their sole discretion.

# Manufacturing Info

---

This manual is to be used with all items with the model number

VRM010636N

SKU# : VRM010636N  
RATING: 120V, 60Hz, 120W, AC ONLY

# Warning

---

Keep all plastic bags away from children.

Manufacturer, distributor, importer, and seller are not liable for ANY damage caused by improper use, storage, care or failure to follow warnings associated with this product.

# E-Waste Recycling

---

This marking indicates that this item should not be thrown out with other household wastes. To prevent possible harm to the environment or human health from electronic waste disposal, recycle this item responsibly. For assistance on proper disposal, call 1-800-8-BATTERY.

# Contact Us

---

 Chat With Us

[vremi.com/chat](https://vremi.com/chat)

 Call Us

**(646) - 490 - 9904**

 Email Us

[support@vremi.com](mailto:support@vremi.com)



[vremi.com](https://vremi.com)