



MOTOR VEHICLE USE MAP 2018

**Ocala
National Forest**

**America's Great
Outdoors**

Florida ● 15 Mar 2018



United States
Department of Agriculture
Forest Service
Southern Region

Motor Vehicle Use Map



THE PURPOSE AND CONTENTS OF THIS MAP

The designations shown on this motor vehicle use map (MVUM) were made by the responsible official pursuant to 36 CFR 212.51; are effective as of the date on the front cover of this MVUM; and will remain in effect until superceded by next year's MVUM.

Kelly Russell
Forest Supervisor, National Forests in Florida

It is the responsibility of the user to acquire the current MVUM. This MVUM shows the National Forest System roads, National Forest System trails, and the areas on National Forest System lands in the Ocala National Forest that are designated for motor vehicle use pursuant to 36 CFR 212.51. This MVUM also identifies the vehicle classes allowed on each route and in each area; and any seasonal restrictions that apply on those routes and in those areas.

Designation of a road, trail, or area for motor vehicle use by a particular class of vehicle under 36 CFR 212.51 should not be interpreted as encouraging or inviting use or implying that the road, trail, or area is passable, actively maintained, or safe for travel. Motor vehicle designations include parking along designated routes and at facilities associated with designated routes when it is safe to do so and when not causing damage to National Forest System resources. Seasonal weather conditions and natural events may render designated roads and trails impassable for extended periods. Designated areas may contain dangerous or impassable terrain. Many designated roads and trails may be passable only by high-clearance vehicles or four-wheel-drive vehicles. Maintenance of designated roads and trails will depend on available resources, and many may receive little maintenance.

This motor vehicle use map identifies those roads, trails, and areas designated for the motor vehicle use under 36 CFR 212.51 for the purpose of enforcing the prohibition at 36 CFR 261.13. This is a limited purpose. The other public roads are shown for information and navigation purposes only and are not subject to designation under the Forest Service travel management regulation.

These designations apply only to National Forest System roads, National Forest System trails, and areas on National Forest System lands.

OPERATOR RESPONSIBILITIES

Operating a motor vehicle on National Forest System roads, National Forest System trails, and in areas on National Forest System lands carries a greater responsibility than operating that vehicle in a city or other developed setting. Not only must you know and follow all applicable traffic laws, you need to show concern for the environment as well as other forest users. The misuse of motor vehicles can lead to the temporary or permanent closure of any designated road, trail, or area. As a motor vehicle operator, you are also subject to State traffic law, including State requirements for licensing, registration, and operation of the vehicle in question.

Motor vehicle use, especially off-highway vehicle use, involves inherent risks that may cause property damage, serious injury, and possibly death to participants. Drive cautiously and anticipate rough surfaces and features such as mud, vegetation, and water crossings common to remote driving conditions. By your participation, you voluntarily assume full responsibility for these damages, risks, and dangers. Take care at all times to protect yourself and those under your responsibility.

Much of the Ocala National Forest is remote. Medical assistance may not be readily available. Cellular telephones do not work in many areas of the Ocala National Forest. Operators should take adequate food, water, first-aid supplies, and other equipment appropriate for the conditions and expected weather.

ALWAYS REMEMBER TO RESPECT PRIVATE LAND! PROTECT YOUR PRIVILEGE. STAY ON DESIGNATED ROADS, TRAILS, AND IN DESIGNATED AREAS.

Read and understand this map in its entirety. If you have questions, please contact the Ocala National Forest for clarification.

As a motor vehicle operator on a National Forest System road, trail, or area, you must comply with this map, as well as all Federal, State, and local laws and regulations. Compliance with these rules is your responsibility.

USDA is an equal opportunity provider, employer, and lender

SEASONAL VEHICLE DESIGNATIONS

All routes with a seasonal designation are open from 11/01 to 01/15.

ROADS IN DEVELOPED CAMPGROUNDS

Roads within all Developed Campgrounds, except Lake Delancy West, are open to only highway legal vehicles, year-round. See Map 22A for Lake Delancy West Designations.

VICINITY MAP



Motor Vehicle Use Map



EXPLANATION OF LEGEND ITEMS

Roads Open to Highway Legal Vehicles Only:

These roads are open only to motor vehicles licensed under State law for general operation on all public roads within the State.

Milepost Marker:

This symbol is used to display the beginning and ending mileposts of a road that has a change in the designation but not the symbology.

Motorized Trail Access:



This symbol indicates a trailhead for access to a motorized route. Not all motorized routes have trailheads and those that do may range from primitive to developed.

Short Route Identifier:

70333

This symbol is used for routes that are too short to show an actual symbol type on the map. The symbol contains the number of the road or trail. Users should refer to the corresponding number in the Short Route Table for designation information.

INFORMATION SOURCES

Lake George Ranger District
17147 East Highway 40
Silver Springs, FL 34488
(352) 625 - 2520
OR
Seminole Ranger District
40929 State Road 19
Umatilla, FL 32784
(352) 669 - 3153

This document is available online at
<http://www.fs.usda.gov/main/florida/maps-pubs> and select
Ocala National Forest MVUM

IN CASE OF EMERGENCY

DIAL 911

Lake County Sheriff's Office
Phone: (352) 343-9500

Marion County Sheriff's Office
Phone: (352) 732-9111

Putnam County Sheriff's Office
Phone: (386) 329-0800

To Report Forest Fires:
Florida Interagency Coordination Center
(850) 523 - 8600
Select Option 0

PROHIBITIONS

It is prohibited to possess or operate a motor vehicle on National Forest System lands on the Ocala National Forest other than in accordance with these designations (36 CFR 261.13).

Violators of 36 CFR 261.13 are subject to a fine of up to \$5,000, imprisonment for up to 6 months or both (18 U.S.C. 3571(e)). This prohibition applies regardless of the presence or absence of signs.

This map does not display nonmotorized uses and other facilities and attractions on the Ocala National Forest. Obtain forest visitor information from the local national forest office.

Designated roads, trails, and areas may also be subject to temporary, emergency closures. As a visitor, you must comply with signs notifying you of such restrictions. A national forest may issue an order to close a road, trail, or area on a temporary basis to protect the life, health, or safety of forest visitors or the natural or cultural resources in these areas. Such temporary and/or emergency closures are consistent with the Travel Management Rule (36 CFR 212.52 (b), 36 CFR 261 subpart B).

The designation "road or trail open to all motor vehicles" does not supersede vehicle size or weight limits imposed through State traffic law.

Trails Open to Wheeled Vehicles 50 inches or Less in Width:

These trails are open only to wheeled, motor vehicles less than 50 inches in width at the widest point on the vehicle.

Trails Open to Motorcycles Only:

These trails are open only to motorcycles. Sidecars are not permitted.

Special Vehicle Designation:

This symbol indicates the road or trail is open to classes of vehicles other than those listed above. Refer to the Seasonal and Special Designation Table for further instructions.

Seasonal Designation:

This symbol, used in conjunction with one of the other road or trail symbols, indicates that the road or trail is open only during certain portions of the year. Refer to Seasonal and Special Designation Table for further instructions.

Other Public Roads and Trails:

Highways, U.S., State
Other Public Roads

These symbols are used to show routes the Forest Service does not have jurisdiction over and has not designated for motorized use. These symbols are part of the reference layers showing connections to towns and cities outside the forest boundary.



Special Vehicle Designations

Route Number	Legend	Special Vehicle Designation	Dates Allowed	Beginning Mile Post	Ending Mile Post
05-10.0, 08, 08-1.0, 09-29.0, 09-29.3, 09-29.3A, 09-30.5, 09-32.7, 09-33.7, 09-33.7A, 09-33.7B, 09-35.8, 09-5.2A, 10, 10-1.81, 11-15.2A, 11-17.0, 11-17.0B, 11-18.4, 11-18.4A, 11-19.2, 11-23.4, 11-23.7, 11-15.2, 13-14.4, 13-6.7A, 14-6.0, 14-8.8, 14-9.8, 14-9.8A, 160-0.8, 160-2.1, 160-2.1A, 160-3.2, 160-3.2A, 160-3.2A3, 160-6.2, 17-1.7, 22, 22-4.6, 30-1.1B, 30-5.3, 316-3.0, 316-3.1, 316-4.2, 316-8.4, 316-8.4A, 316-8.5, 316-9.2, 40-14.2, 53, 61-4.2, 61-4.8, 61-4.8B, 61-5.5, 61-5.5A, 63-5.0, 66-0.4, 66-0.4A, 66-0.4B, 66-2.1, 66-2.1A, 66-2.1B, 66-5.1, 66-5.9, 66-7.6, 66-8.0, 70-1.4, 70-1.4A, 70-1.4C, 70-1.4C1, 70-3.4, 70-3.4A, 70-4.7, 70-4.7A, 74-3.8, 74-3.8B	-----11	Special Vehicle Designation All Highway Legal Vehicles, Wheeled Non-Highway Legal Vehicles Less than 65 Inches, All Vehicles 50 Inches Wide or Less	01/01-12/31		
42-16.6, 445-1.8, 61, 61-1.7, 61-1.7A, 66-5.5, 74-8.0A	-----11	Special Vehicle Designation All Highway Legal Vehicles, All Vehicles 50 Inches Wide or Less	01/01-12/31		
0220N-0221, 0220N-0221-A, 0221-B, 0222, 0223, 0224, 0224-A, 0224-D, 0224-E, 0520, 0520-A, 0520-B, 0520-C	-----11	Special Vehicle Designation Wheeled Non-Highway Legal Vehicles Less Than 65 Inches, All Wheeled Vehicles 50 Inches Wide or Less	01/01-12/31		
37-1.8	-----12	Special Vehicle Designation, with Seasonal Designation Wheeled Non-Highway Legal Vehicles Less than 65 Inches, All Vehicles 50 Inches Wide or Less	01/01-12/31	1.279	1.343

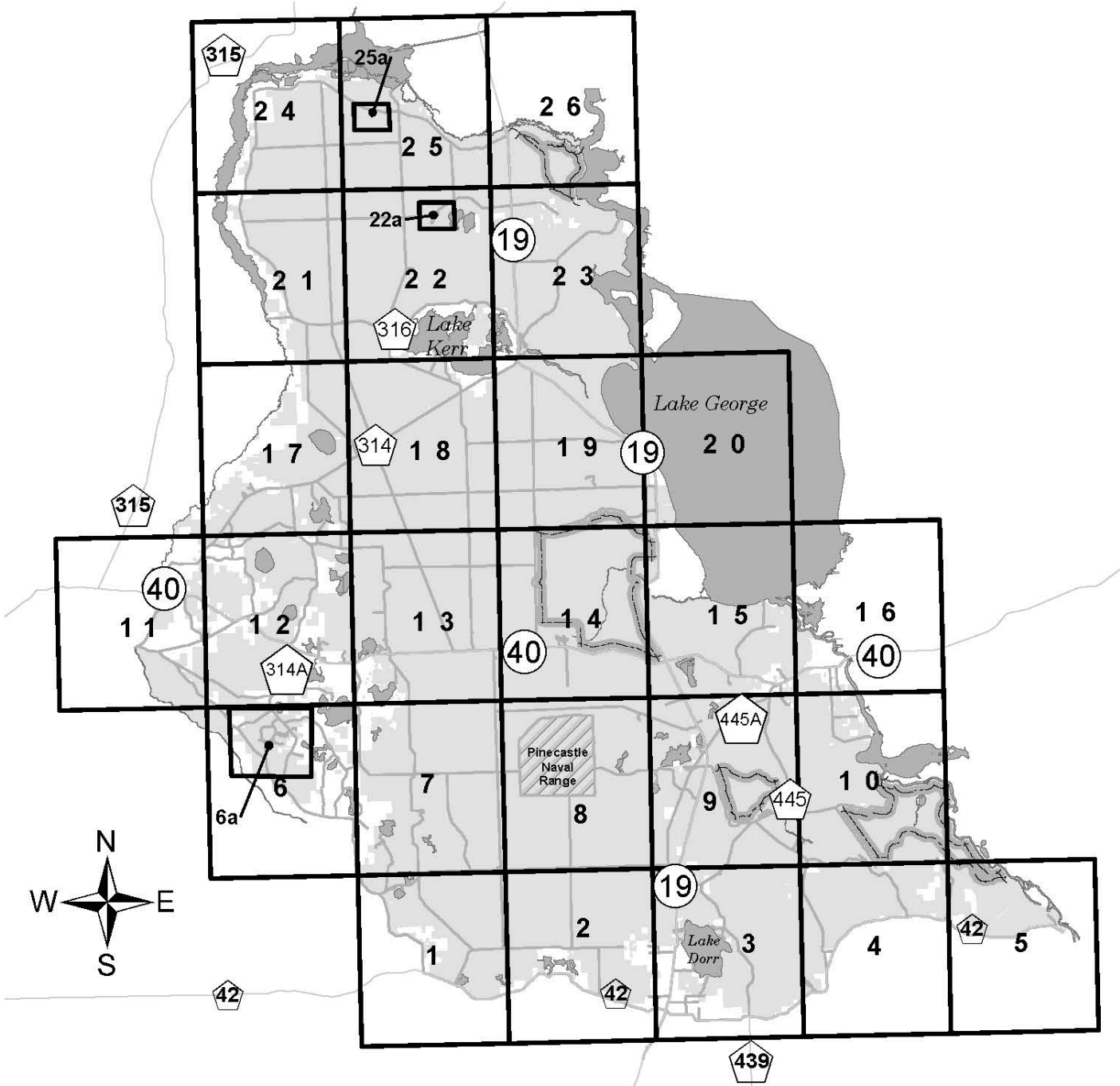

Ocala National Forest
 Motor Vehicle Use Map Index
 2018



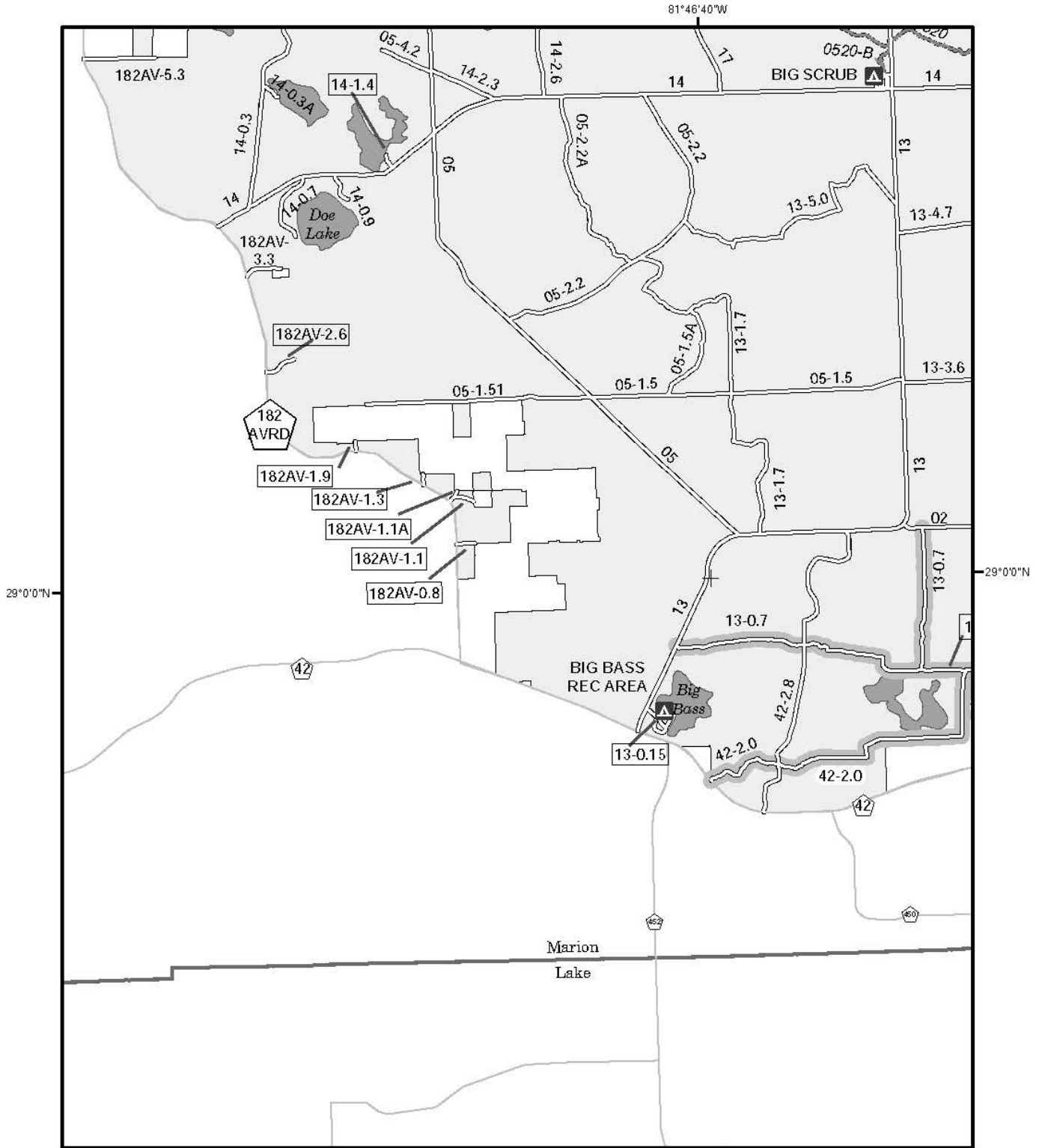

North American Datum of 1983 (NAD 83)
State Plane, zone 903

Adjacent Map Pages

6	7	8
	1	2

LEGEND

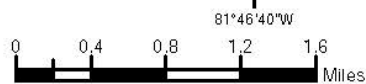

FS-873-817

Roads Open to Highway Legal Vehicles Only	Highways, US, State	Political/Administrative Boundary	Information Site
Trails Open to Wheeled Vehicles 50" or Less in Width	Other Public Roads	Forest or Unit Boundary	Milepost Marker
Trails Open to Motorcycles Only	National Forest System Lands	Lakes and Rivers	FS Campground
Special Vehicle Designation (See Table)	Non-National Forest System Lands within the National Forest	Picnic Area	Motorized Trailhead
Seasonal Designation (Used along with road or trail listed above)	Wilderness		N

Motor Vehicle Use Map 2018

<http://www.fs.fed.us/florida/maps-pubs>

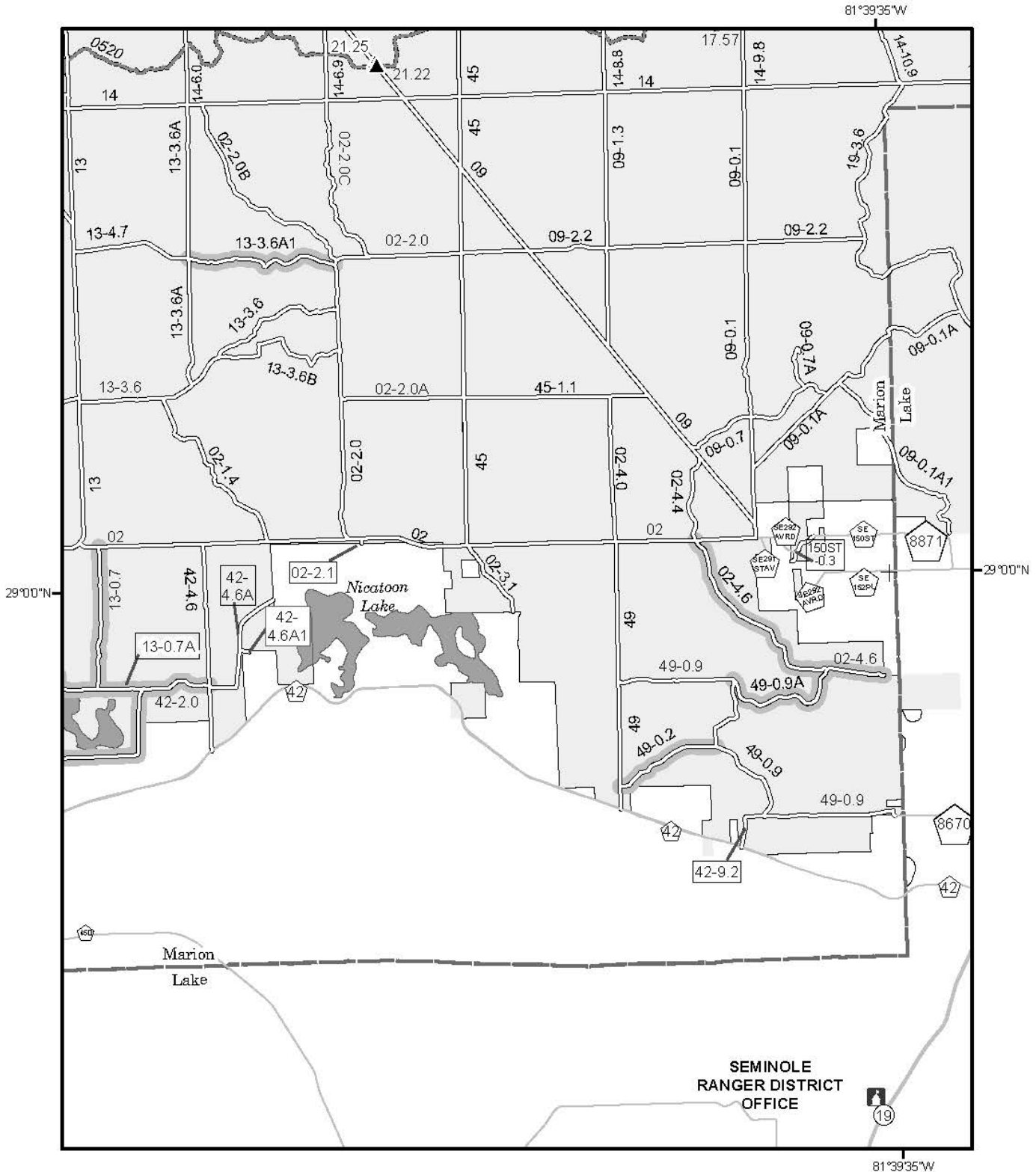

North American Datum of 1983 (NAD 83)
State Plane, zone 903

Adjacent Map Pages

7	8	9
1	2	3

LEGEND



FS-873-817

Roads Open to Highway Legal Vehicles Only	Highways, US, State	Political/Administrative Boundary	Information Site
Trails Open to Wheeled Vehicles 50" or Less in Width	Other Public Roads	Lakes and Rivers	Milepost Marker
Trails Open to Motorcycles Only	Forest or Unit Boundary	FS Campground	
Special Vehicle Designation (See Table)	National Forest System Lands	Picnic Area	
Seasonal Designation (Used along with road or trail listed above)	Non-National Forest System Lands within the National Forest	Motorized Trailhead	
	Wilderness		



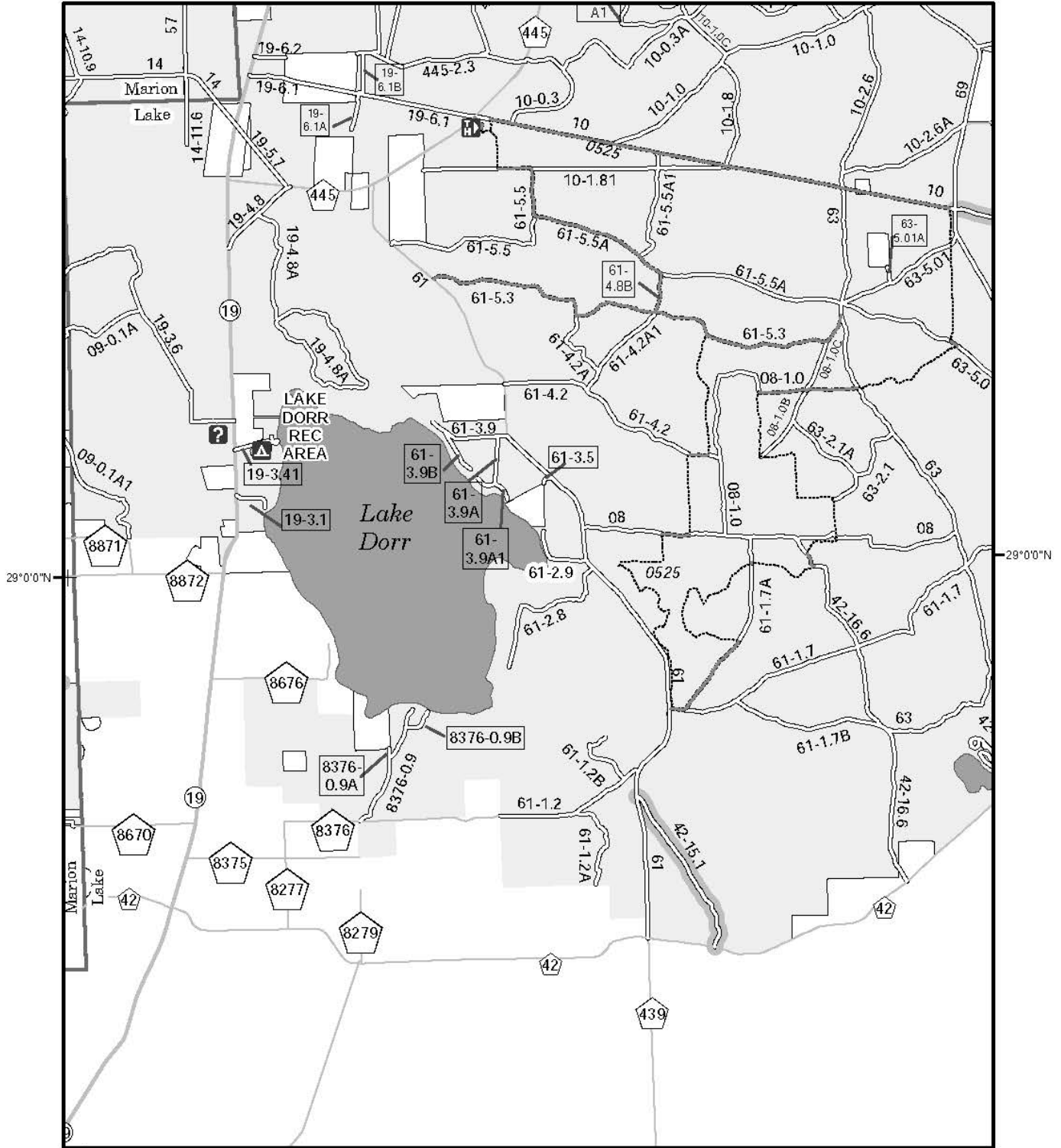

81°39'35"W
 North American Datum of 1983 (NAD 83)
 State Plane, zone 903

Adjacent Map Pages

8	9	10
2	3	4

LEGEND



FS-873-817

Roads Open to Highway Legal Vehicles Only	Highways, US, State	Political/Administrative Boundary	Information Site
Trails Open to Wheeled Vehicles 50' or Less in Width	Other Public Roads	Lakes and Rivers	Milepost Marker
Trails Open to Motorcycles Only	Forest or Unit Boundary	FS Campground	Picnic Area
Special Vehicle Designation (See Table)	National Forest System Lands	Motorized Trailhead	N
Seasonal Designation (Used along with road or trail listed above)	Non-National Forest System Lands within the National Forest	Wilderness	

Motor Vehicle Use Map 2018

<http://www.fs.fed.us/da.gov/main/florida/maps-pubs>



Map 4 of 26

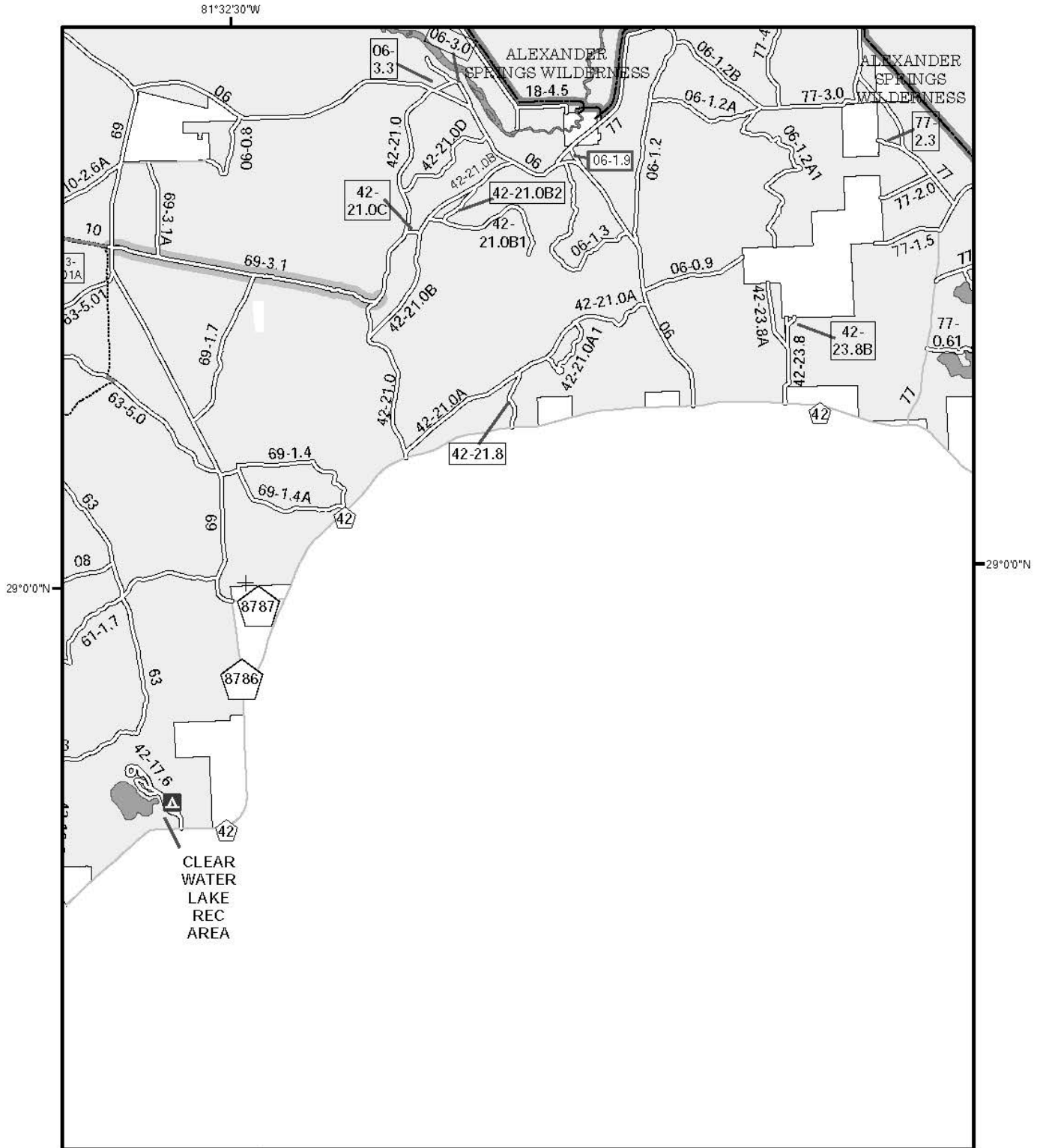

North American Datum of 1983 (NAD 83)
State Plane, zone 903

Adjacent Map Pages

9	10	
3	4	5

LEGEND



FS-873-817

Roads Open to Highway Legal Vehicles Only	Highways, US, State	Political/Administrative Boundary	Information Site
Trails Open to Wheeled Vehicles 50" or Less in Width	Other Public Roads	Forest or Unit Boundary	Milepost Marker
Trails Open to Motorcycles Only	National Forest System Lands	Lakes and Rivers	FS Campground
Special Vehicle Designation (See Table)	Non-National Forest System Lands within the National Forest	Picnic Area	N
Seasonal Designation (Used along with road or trail listed above)	Wilderness	Motorized Trailhead	



81°25'25"W

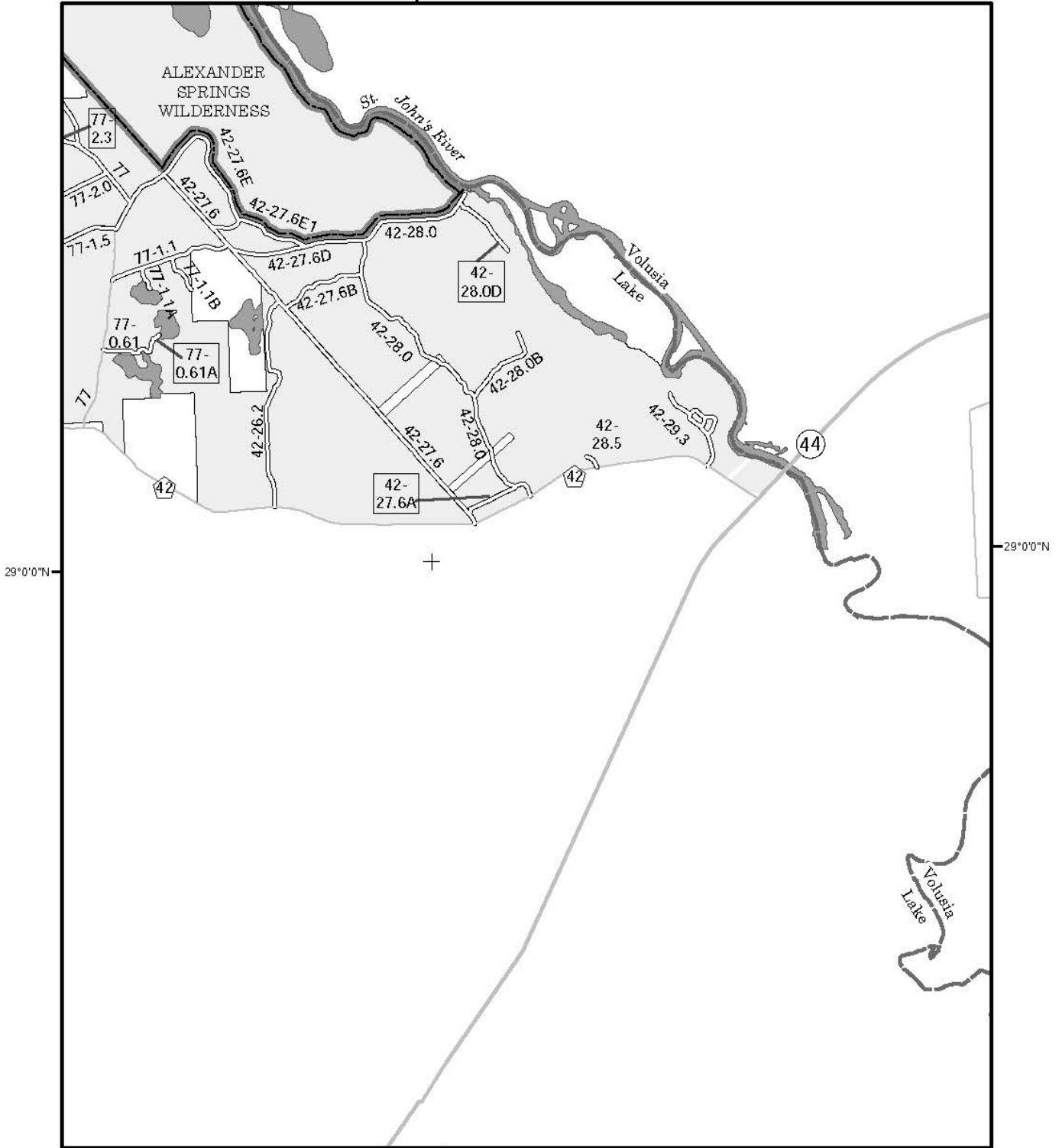

North American Datum of 1983 (NAD 83)
State Plane, zone 903

Adjacent Map Pages

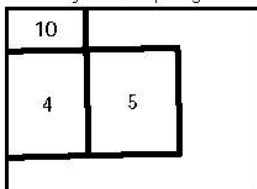

LEGEND



FS-873-817

Roads Open to Highway Legal Vehicles Only	Highways, US, State	Political/Administrative Boundary	Information Site
Trails Open to Wheeled Vehicles 50" or Less in Width	Other Public Roads	Lakes and Rivers	Milepost Marker
Trails Open to Motorcycles Only	Forest or Unit Boundary	FS Campground	
Special Vehicle Designation (See Table)	National Forest System Lands	Picnic Area	
Seasonal Designation (Used along with road or trail listed above)	Non-National Forest System Lands within the National Forest	Motorized Trailhead	
	Wilderness		N

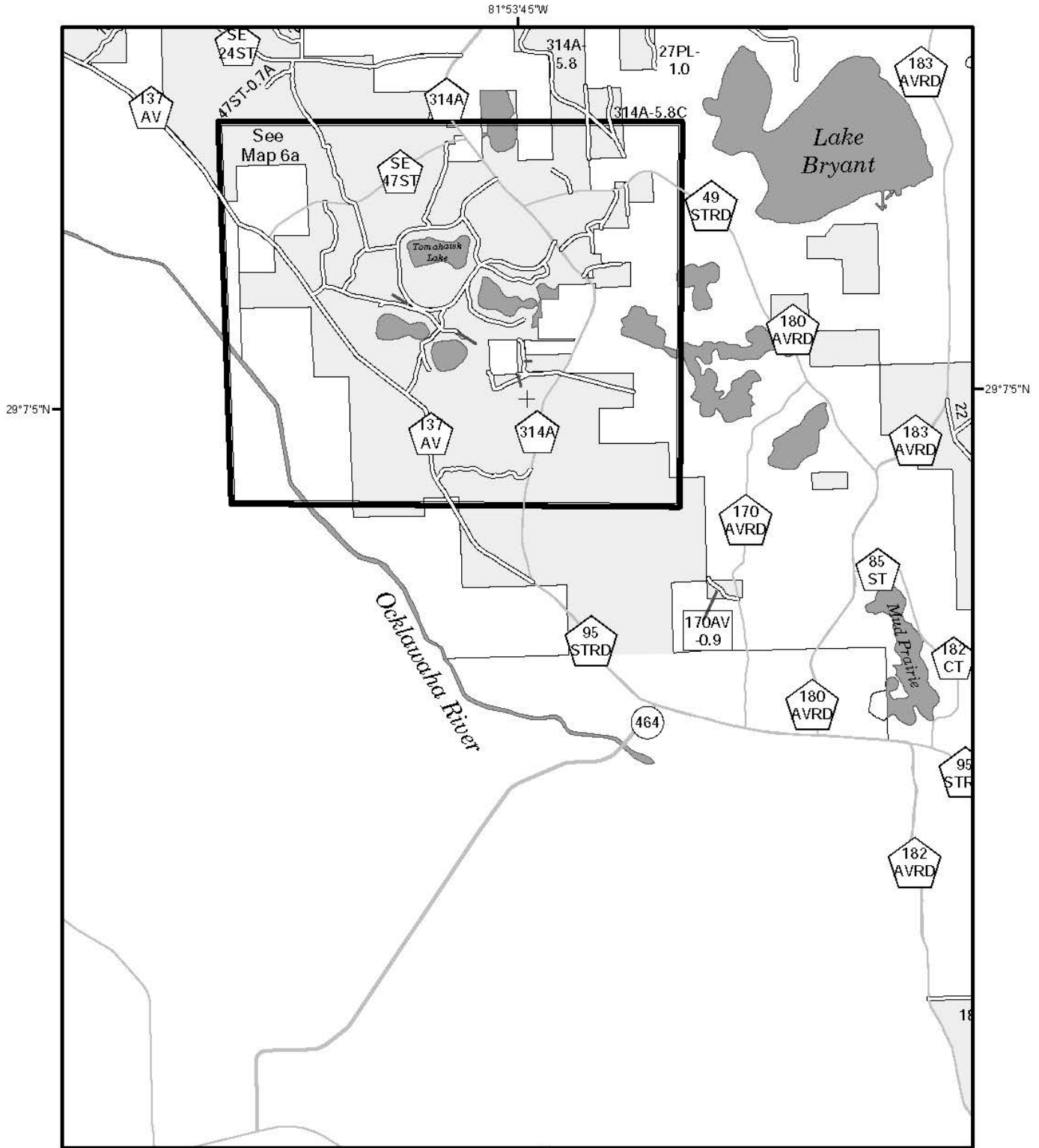

North American Datum of 1983 (NAD 83)
State Plane, zone 903

81°53'45"W

LEGEND



FS-873-817

Adjacent Map Pages

11	12	13
	6a 6	7
		1

Roads Open to Highway Legal Vehicles Only	Highways, U.S. State	Political/Administrative Boundary	Information Site
Trails Open to Wheeled Vehicles 50" or Less in Width	Other Public Roads	Lakes and Rivers	Milepost Marker
Trails Open to Motorcycles Only	Forest or Unit Boundary	FS Campground	N
Special Vehicle Designation (See Table)	National Forest System Lands	Picnic Area	
Seasonal Designation (Used along with road or trail listed above)	Non-National Forest System Lands within the National Forest	Motorized Trailhead	
	Wilderness		



81°53'45"W

29°7'5"N

29°7'5"N

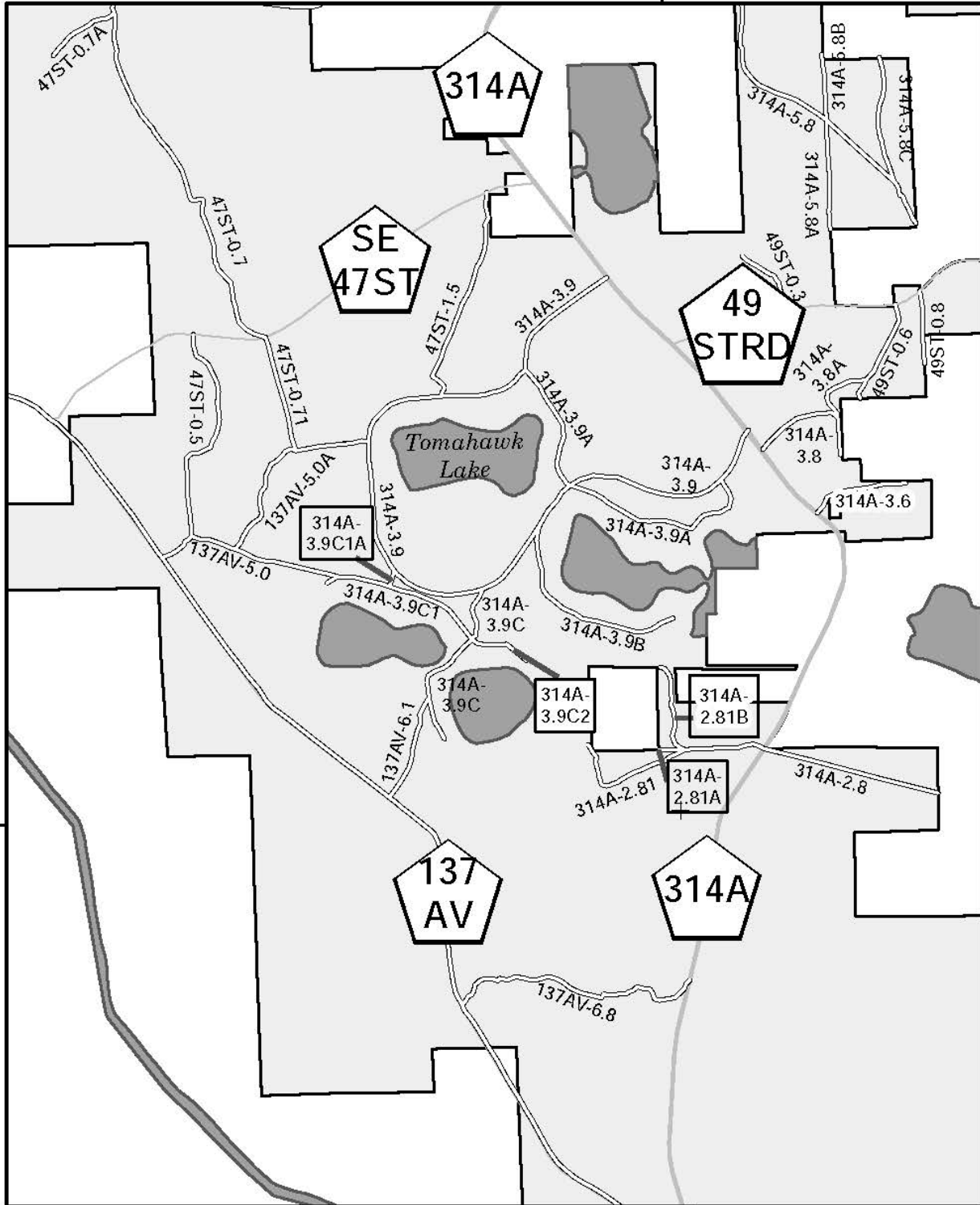

81°53'45"W

North American Datum of 1983 (NAD 83)
State Plane, zone 903

Adjacent Map Pages

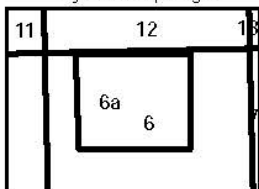

LEGEND



FS-873-817

Roads Open to Highway Legal Vehicles Only	Highways, US, State	Political/Administrative Boundary	Information Site
Trails Open to Wheeled Vehicles 50" or Less in Width	Other Public Roads	Lakes and Rivers	Milepost Marker
Trails Open to Motorcycles Only	Forest or Unit Boundary	FS Campground	N
Special Vehicle Designation (See Table)	National Forest System Lands	Picnic Area	
Seasonal Designation (Used along with road or trail listed above)	Non-National Forest System Lands within the National Forest	Motorized Trailhead	
	Wilderness		

Motor Vehicle Use Map 2018

<http://www.fs.fed.us/florida/maps-pubs>

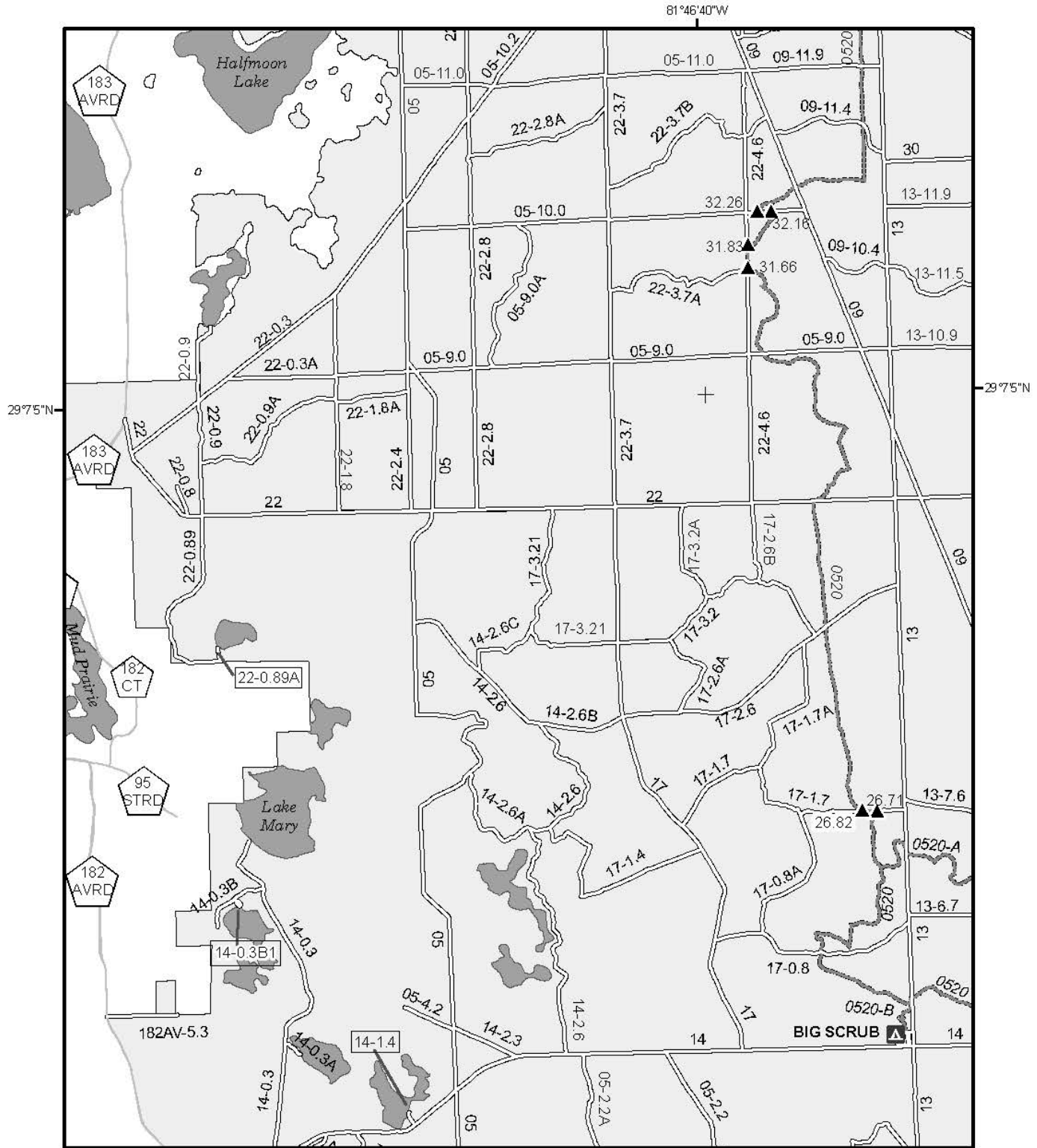

North American Datum of 1983 (NAD 83)
State Plane, zone 903

Adjacent Map Pages

12	13	14
6a	7	8
6		
	1	2

LEGEND

Roads Open to Highway Legal Vehicles Only	Highways, US, State	Political/Administrative Boundary	Information Site
Trails Open to Wheeled Vehicles 50" or Less in Width	Other Public Roads	Lakes and Rivers	Milepost Marker
Trails Open to Motorcycles Only	Forest or Unit Boundary	FS Campground	N
Special Vehicle Designation (See Table)	National Forest System Lands	Picnic Area	
Seasonal Designation (Used along with road or trail listed above)	Non-National Forest System Lands within the National Forest	Motorized Trailhead	
	Wilderness		



FS-873-817

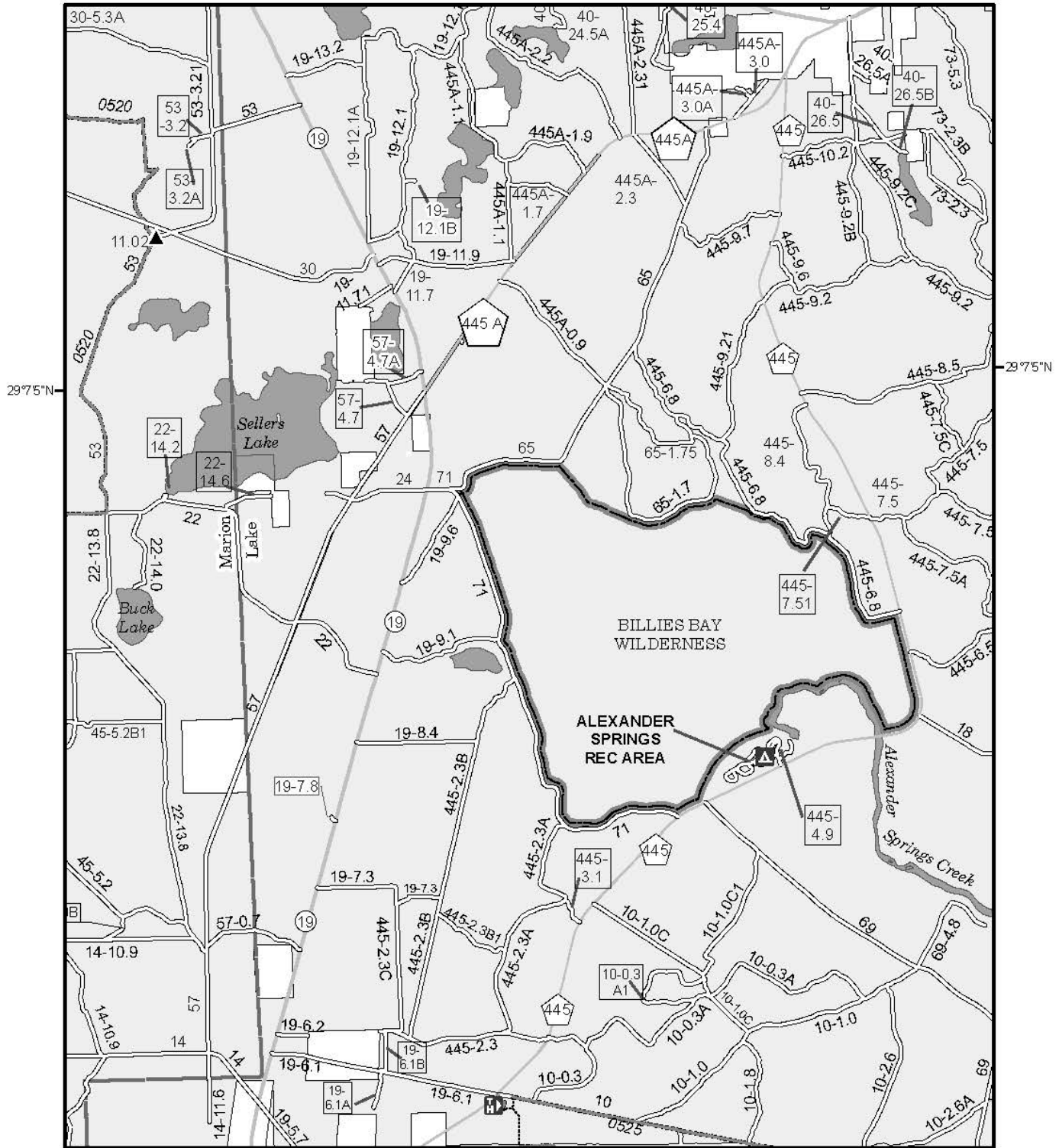

81°39'35\"/>

Adjacent Map Pages

14	15	16
8	9	10
2	3	4

LEGEND



FS-873-817

Roads Open to Highway Legal Vehicles Only	Highways, US, State	Political/Administrative Boundary	Information Site
Trails Open to Wheeled Vehicles 50\"/>	Other Public Roads	Lakes and Rivers	Milepost Marker
Trails Open to Motorcycles Only	Forest or Unit Boundary	FS Campground	N
Special Vehicle Designation (See Table)	National Forest System Lands	Picnic Area	
Seasonal Designation (Used along with road or trail listed above)	Non-National Forest System Lands within the National Forest	Motorized Trailhead	
	Wilderness		

Motor Vehicle Use Map 2018

<http://www.fs.fed.us/da.gov/main/florida/maps-pubs>

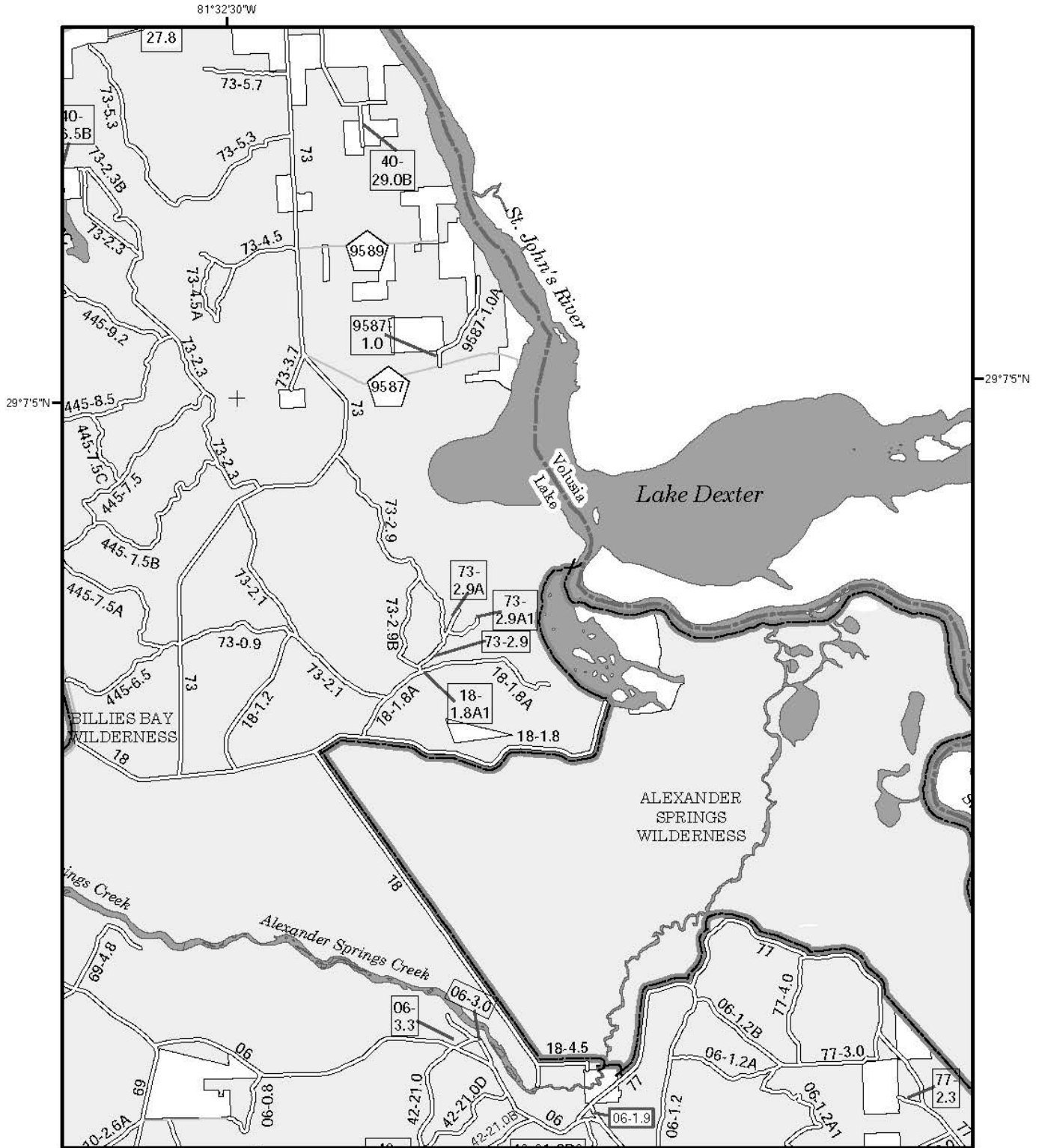

North American Datum of 1983 (NAD 83)
State Plane, zone 903

81°32'30"W

Adjacent Map Pages

15	16	
9	10	
3	4	5

LEGEND



FS-873-817

Roads Open to Highway Legal Vehicles Only	Highways, US, State	Political/Administrative Boundary	Information Site
Trails Open to Wheeled Vehicles 50" or Less in Width	Other Public Roads	Forest or Unit Boundary	Milepost Marker
Trails Open to Motorcycles Only	National Forest System Lands	Lakes and Rivers	FS Campground
Special Vehicle Designation (See Table)	Non-National Forest System Lands within the National Forest	Picnic Area	Motorized Trailhead
Seasonal Designation (Used along with road or trail listed above)	Wilderness		



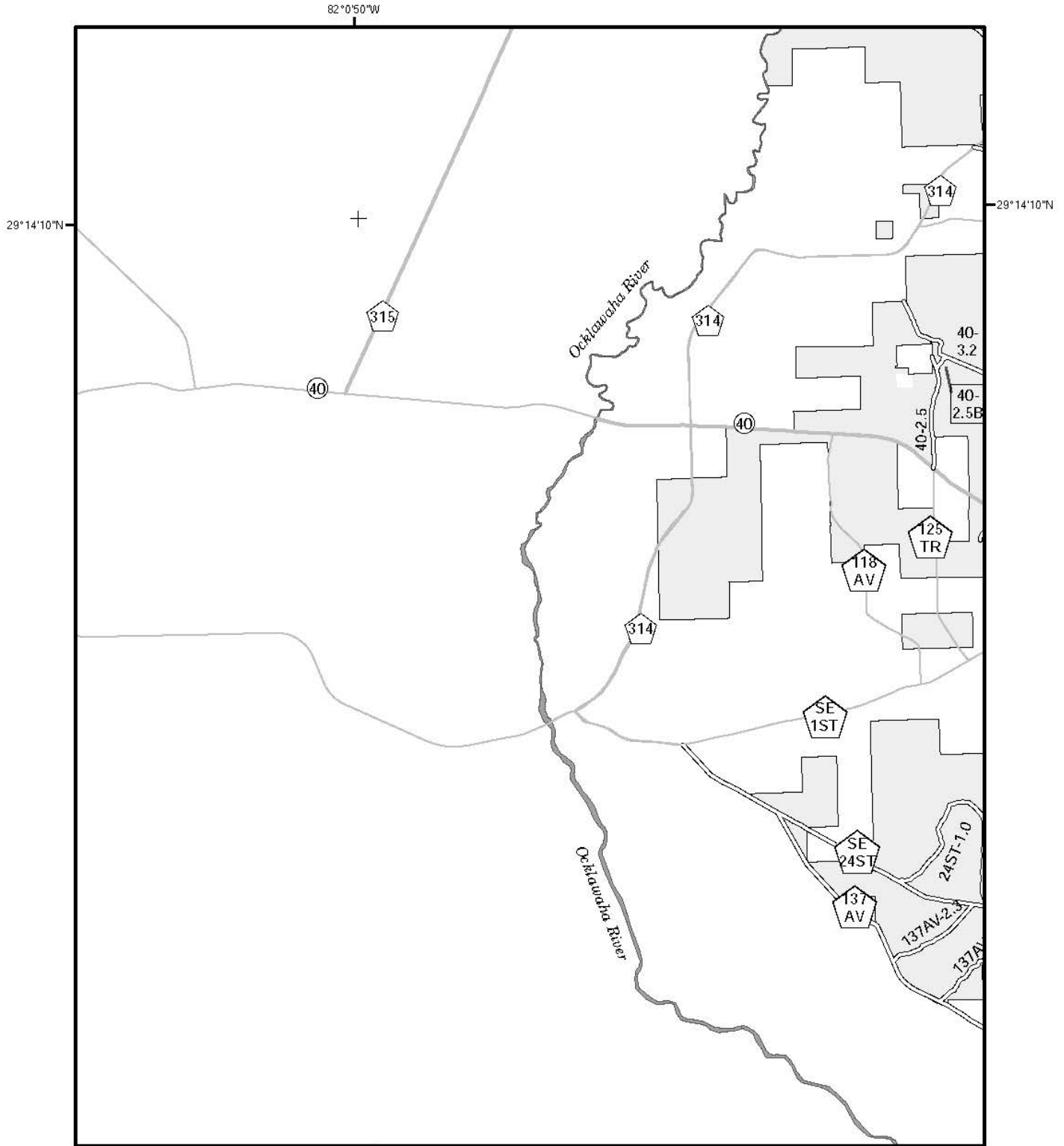

North American Datum of 1983 (NAD 83)
State Plane, zone 903

Adjacent Map Pages

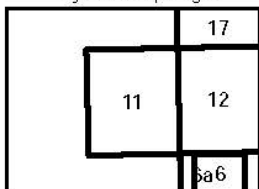

LEGEND



FS-873-817

Roads Open to Highway Legal Vehicles Only	Highways, U.S. State	Political/Administrative Boundary	Information Site
Trails Open to Wheeled Vehicles 50" or Less in Width	Other Public Roads	Lakes and Rivers	Milepost Marker
Trails Open to Motorcycles Only	Forest or Unit Boundary	National Forest System Lands	FS Campground
Special Vehicle Designation (See Table)	National Forest System Lands	Non-National Forest System Lands within the National Forest	Picnic Area
Seasonal Designation (Used along with road or trail listed above)	Wilderness	Motorized Trailhead	N

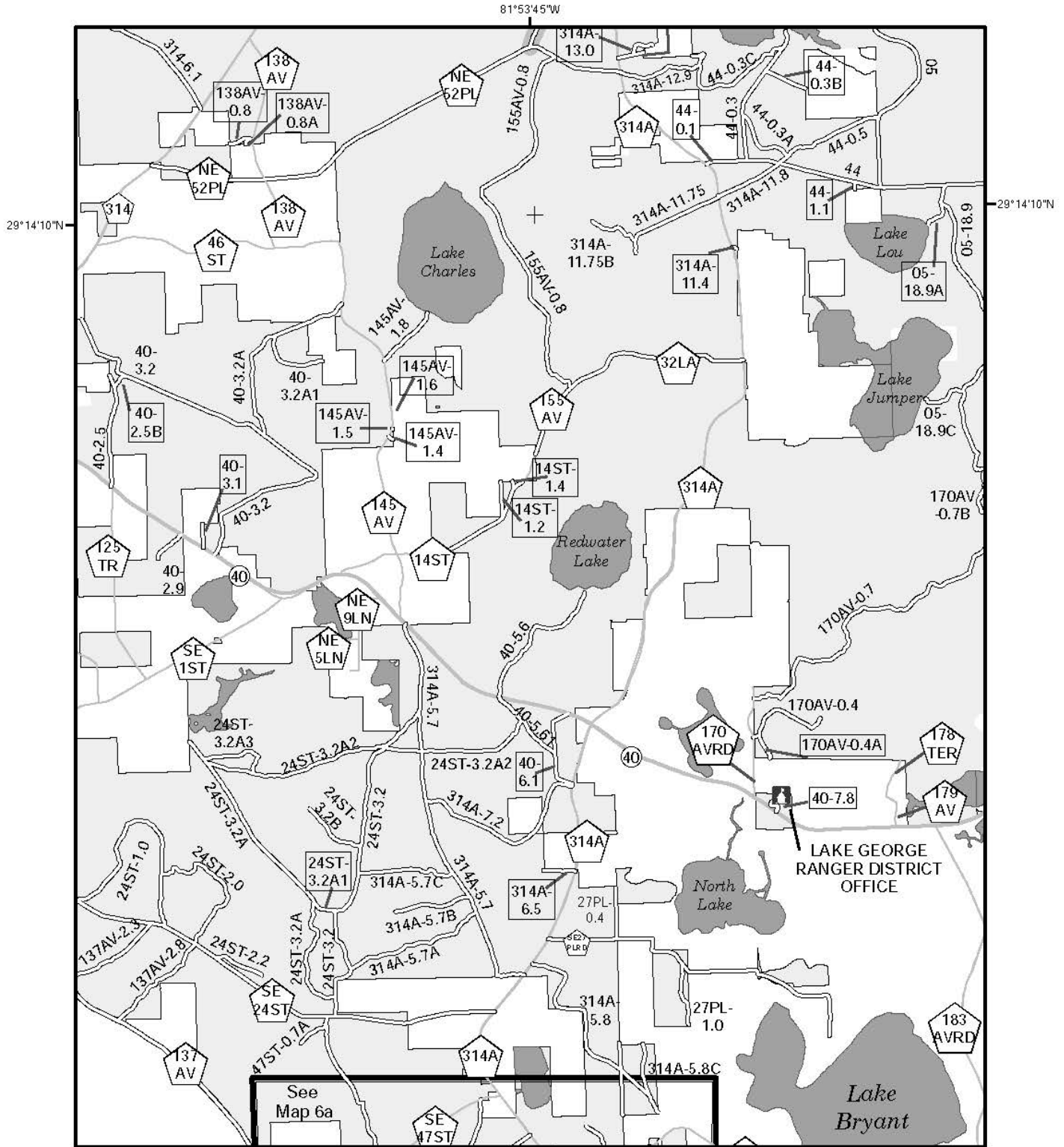

North American Datum of 1983 (NAD 83)
State Plane, zone 903

Adjacent Map Pages

	17	18
11	12	13
	6a6	7

LEGEND

Roads Open to Highway Legal Vehicles Only	Highways, U.S. State	Political/Administrative Boundary	Information Site
Trails Open to Wheeled Vehicles 50" or Less in Width	Other Public Roads	Lakes and Rivers	Milepost Marker
Trails Open to Motorcycles Only	Forest or Unit Boundary	FS Campground	Picnic Area
Special Vehicle Designation (See Table)	National Forest System Lands	Motorized Trailhead	N
Seasonal Designation (Used along with road or trail listed above)	Non-National Forest System Lands within the National Forest	Wilderness	

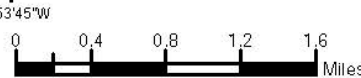

FS-873-817

Motor Vehicle Use Map 2018

<http://www.fs.fed.us/florida/maps-pubs>

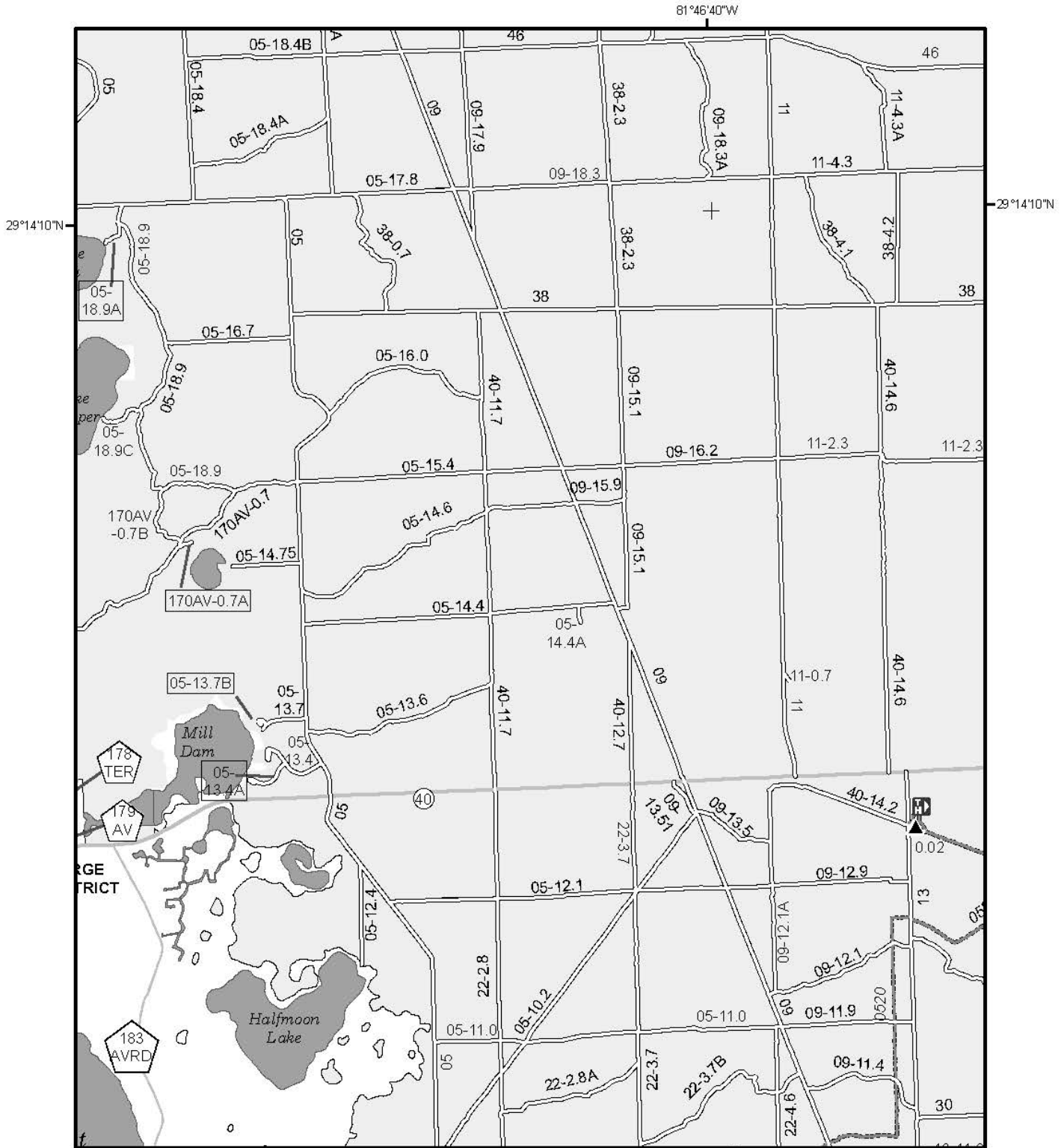

North American Datum of 1983 (NAD 83)
State Plane, zone 903

Adjacent Map Pages

17	18	19
12	13	14
6a6	7	8

LEGEND

Roads Open to Highway Legal Vehicles Only	Highways, US, State	Political/Administrative Boundary	Information Site
Trails Open to Wheeled Vehicles 50" or Less in Width	Other Public Roads	Lakes and Rivers	Milepost Marker
Trails Open to Motorcycles Only	Forest or Unit Boundary	FS Campground	
Special Vehicle Designation (See Table)	National Forest System Lands	Picnic Area	
Seasonal Designation (Used along with road or trail listed above)	Non-National Forest System Lands within the National Forest	Motorized Trailhead	
	Wilderness		



FS-873-817



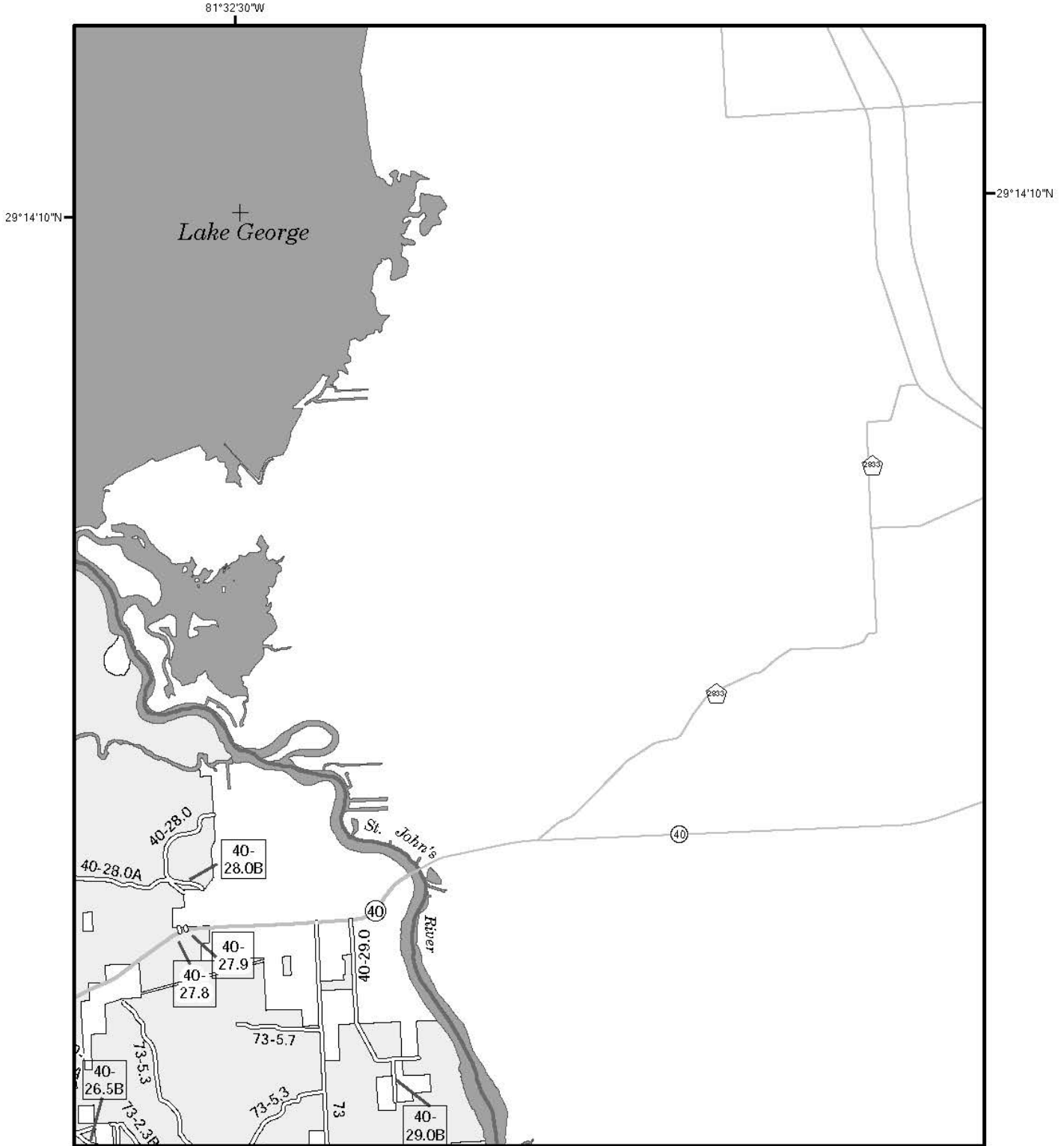

North American Datum of 1983 (NAD 83)
State Plane, zone 903

81°32'30\"/>



FS-873-817

Adjacent Map Pages

20	
15	16
9	10

LEGEND

Roads Open to Highway Legal Vehicles Only	Highways, U.S. State	Political/Administrative Boundary	Information Site
Trails Open to Wheeled Vehicles 50" or Less in Width	Other Public Roads	Lakes and Rivers	Milepost Marker
Trails Open to Motorcycles Only	Forest or Unit Boundary	FS Campground	
Special Vehicle Designation (See Table)	National Forest System Lands	Picnic Area	
Seasonal Designation (Used along with road or trail listed above)	Non-National Forest System Lands within the National Forest	Motorized Trailhead	
	Wilderness		



Motor Vehicle Use Map 2018

<http://www.fs.fed.us/da.gov/main/florida/maps-pubs>

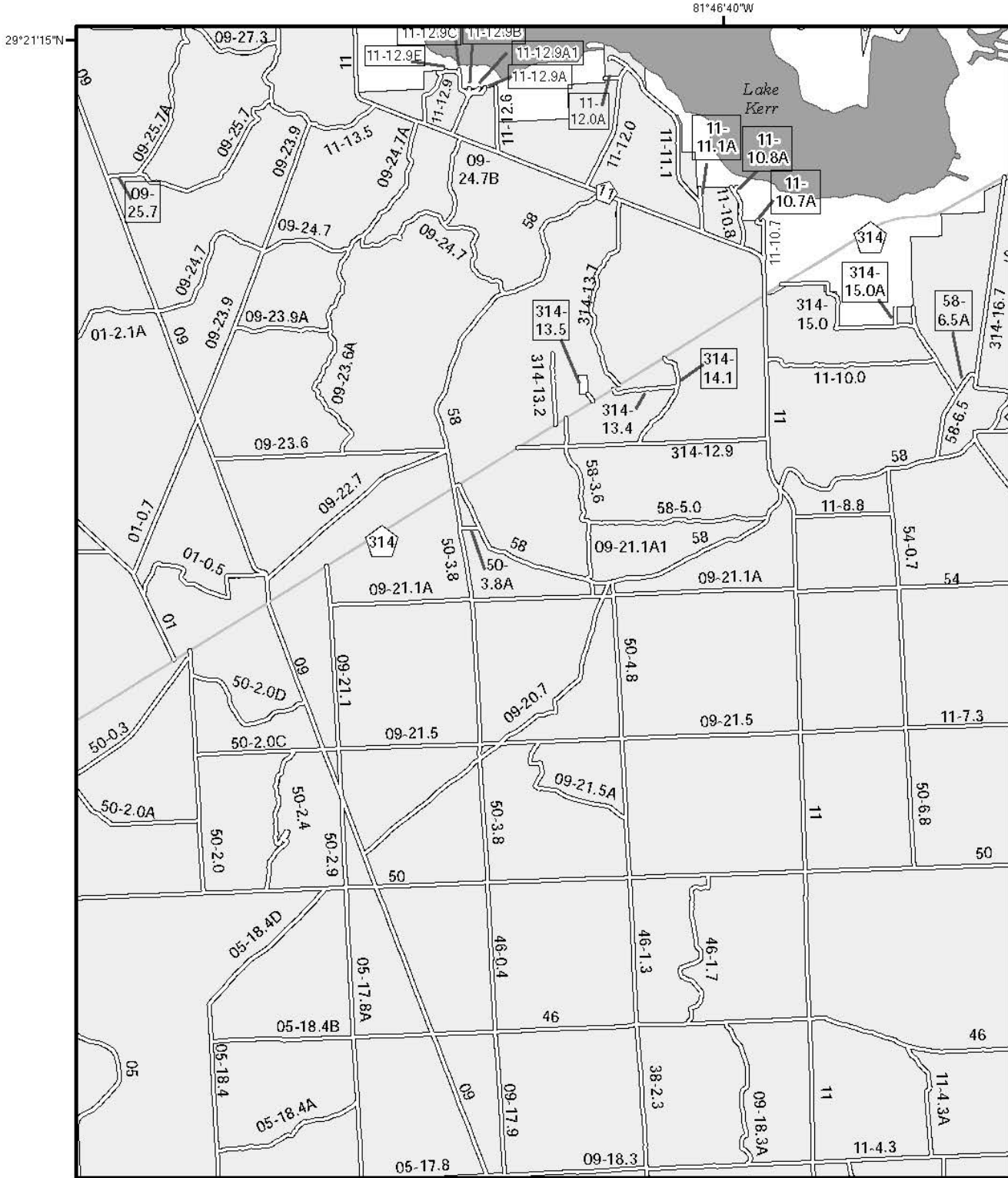

North American Datum of 1983 (NAD 83)
State Plane, zone 903

Adjacent Map Pages

21	22	23
17	18	19
12	13	14

LEGEND

Roads Open to Highway Legal Vehicles Only	Highways, US, State	Political/Administrative Boundary	Information Site
Trails Open to Wheeled Vehicles 50" or Less in Width	Other Public Roads	Lakes and Rivers	Milepost Marker
Trails Open to Motorcycles Only	Forest or Unit Boundary	FS Campground	Picnic Area
Special Vehicle Designation (See Table)	National Forest System Lands	Motorized Trailhead	
Seasonal Designation (Used along with road or trail listed above)	Non-National Forest System Lands within the National Forest	Wilderness	



FS-873-817

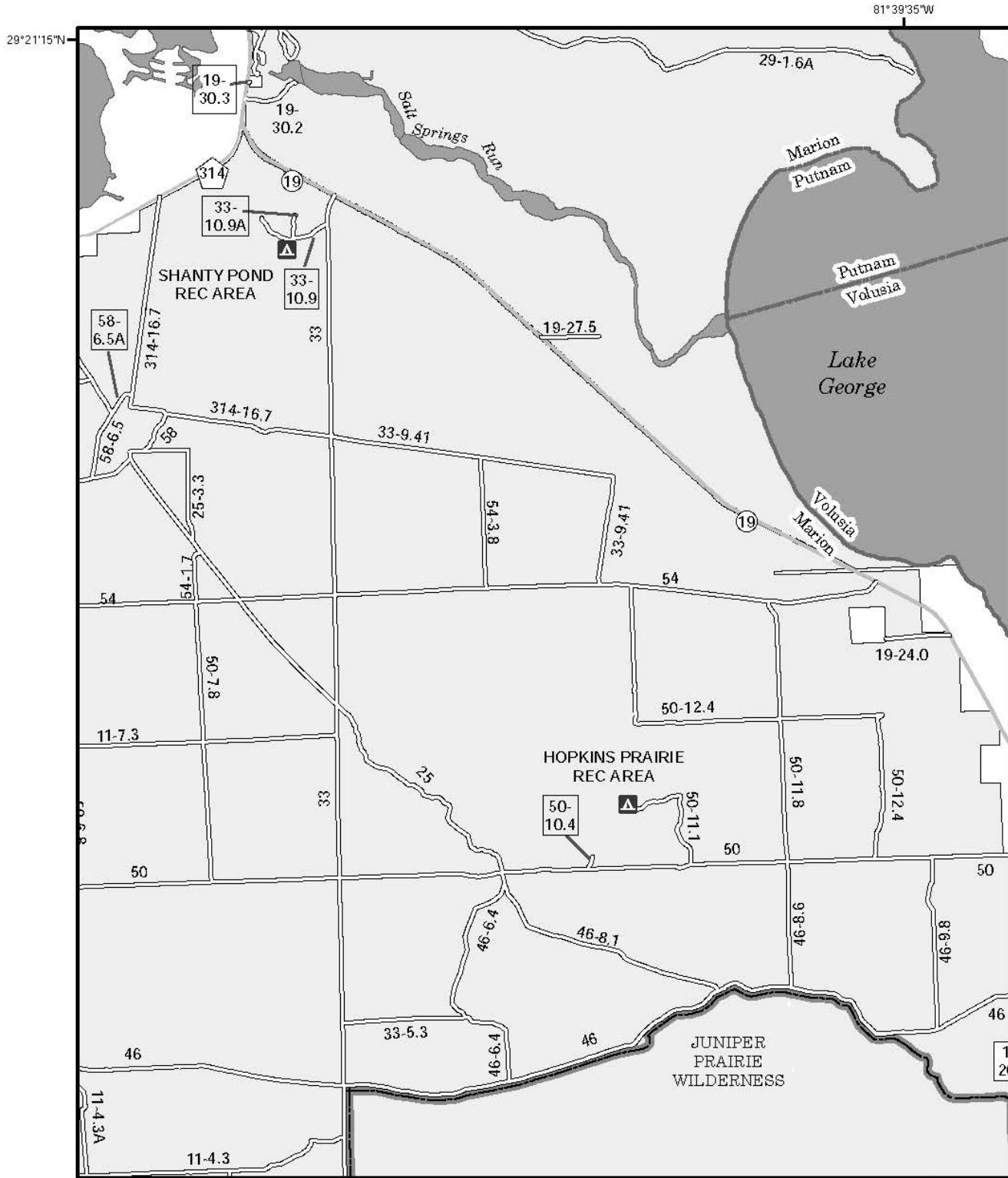

North American Datum of 1983 (NAD 83)
State Plane, zone 903

Adjacent Map Pages

22	23	
18	19	20
13	14	15

LEGEND



FS-873-817

Roads Open to Highway Legal Vehicles Only	Highways, U.S. State	Political/Administrative Boundary	Information Site
Trails Open to Wheeled Vehicles 50" or Less in Width	Other Public Roads	Lakes and Rivers	Milepost Marker
Trails Open to Motorcycles Only	Forest or Unit Boundary	FS Campground	N
Special Vehicle Designation (See Table)	National Forest System Lands	Picnic Area	
Seasonal Designation (Used along with road or trail listed above)	Non-National Forest System Lands within the National Forest	Motorized Trailhead	
	Wilderness		



29°21'15"N

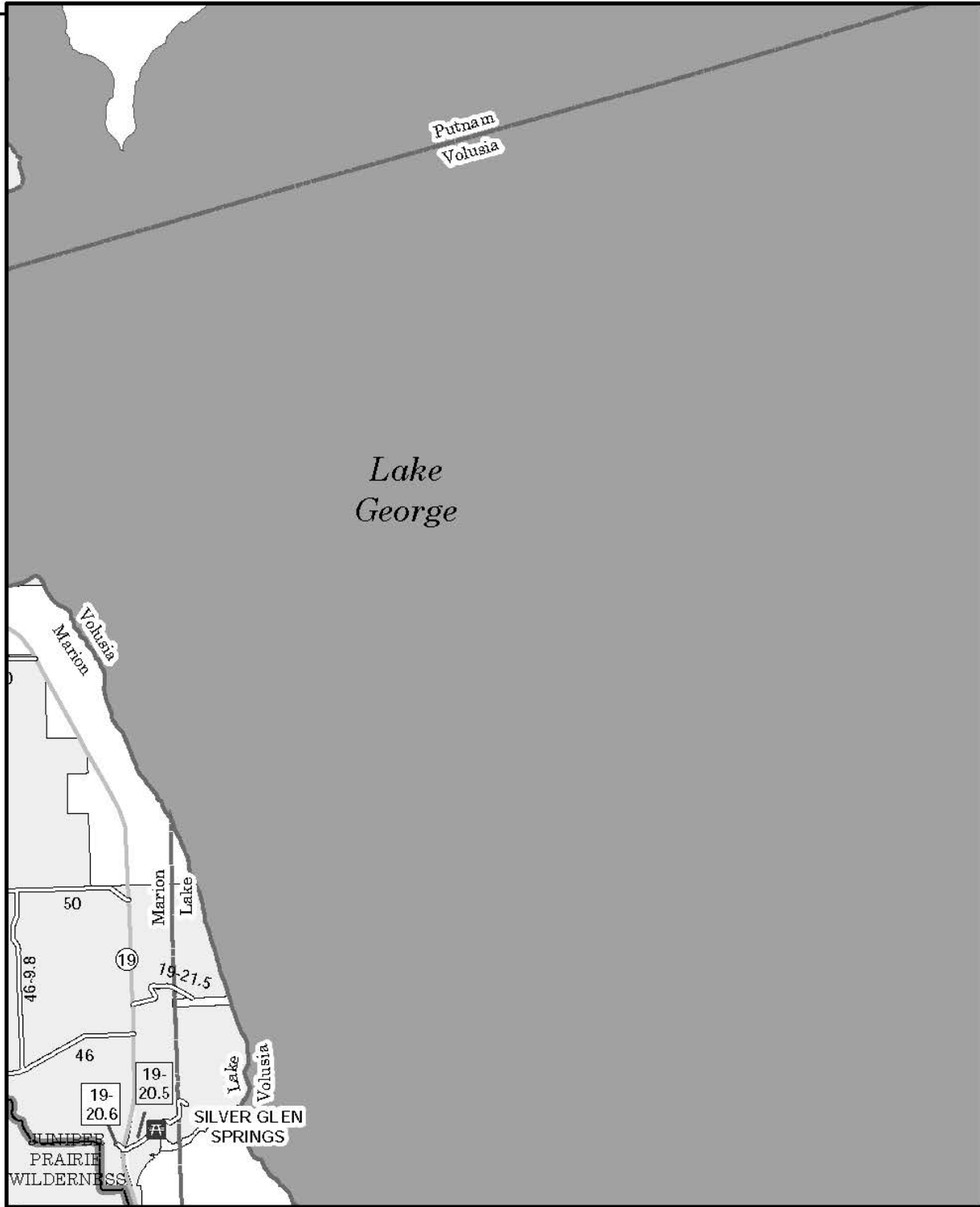

81°39'35"W
North American Datum of 1983 (NAD 83)
State Plane, zone 903

Adjacent Map Pages

23		
19	20	
14	15	16

LEGEND



FS-873-817

Roads Open to Highway Legal Vehicles Only	Highways, US, State	Political/Administrative Boundary	Information Site
Trails Open to Wheeled Vehicles 50" or Less in Width	Other Public Roads	Lakes and Rivers	Milepost Marker
Trails Open to Motorcycles Only	Forest or Unit Boundary	FS Campground	
Special Vehicle Designation (See Table)	National Forest System Lands	Picnic Area	
Seasonal Designation (Used along with road or trail listed above)	Non-National Forest System Lands within the National Forest	Motorized Trailhead	
	Wilderness		



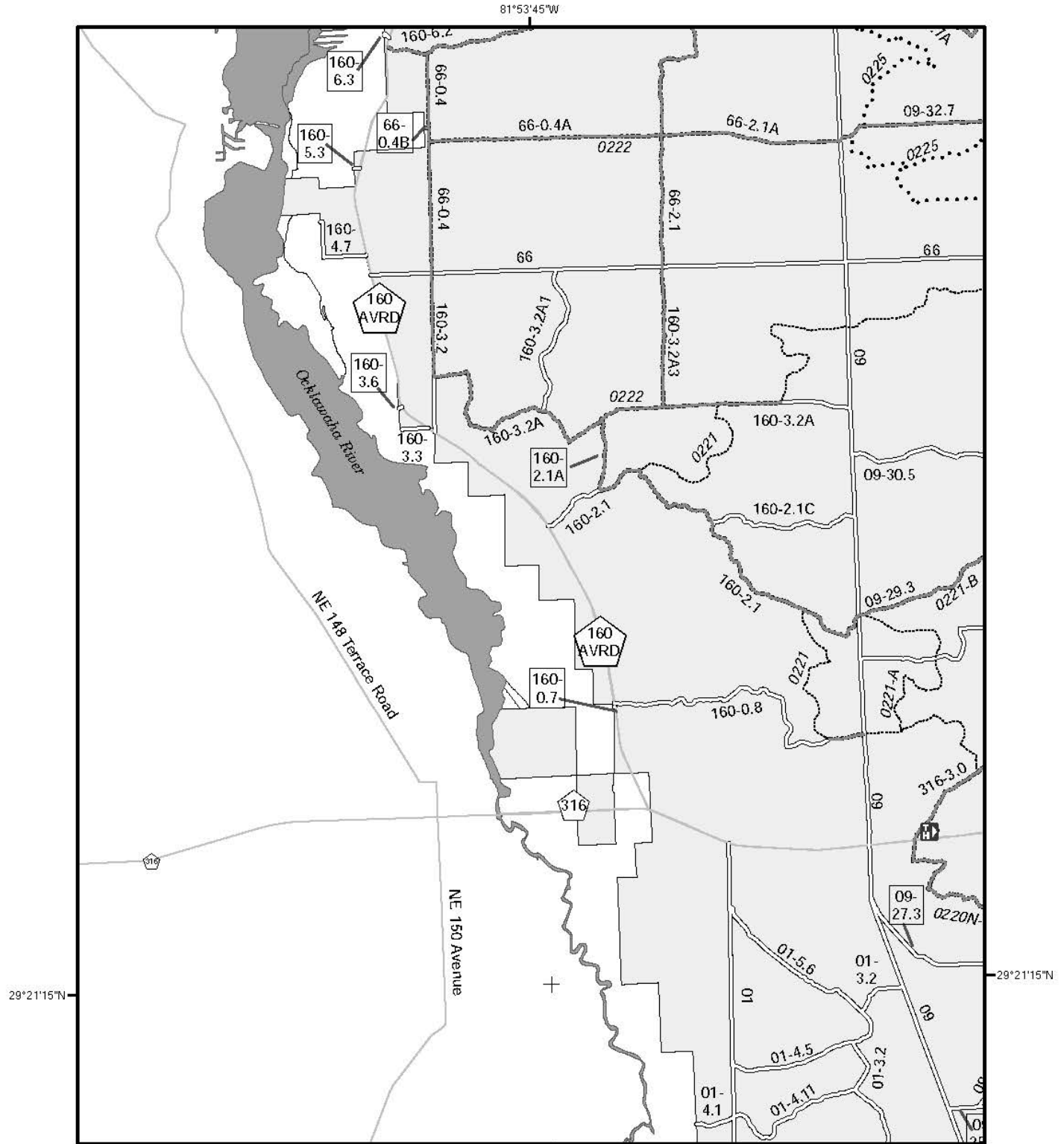

North American Datum of 1983 (NAD 83)
State Plane, zone 903

Adjacent Map Pages

24	25
21	22
17	18

LEGEND



FS-873-817

Roads Open to Highway Legal Vehicles Only	Highways, US, State	Political/Administrative Boundary	Information Site
Trails Open to Wheeled Vehicles 50" or Less in Width	Other Public Roads	Lakes and Rivers	Milepost Marker
Trails Open to Motorcycles Only	Forest or Unit Boundary	FS Campground	
Special Vehicle Designation (See Table)	National Forest System Lands	Picnic Area	
Seasonal Designation (Used along with road or trail listed above)	Non-National Forest System Lands within the National Forest	Motorized Trailhead	
	Wilderness		N

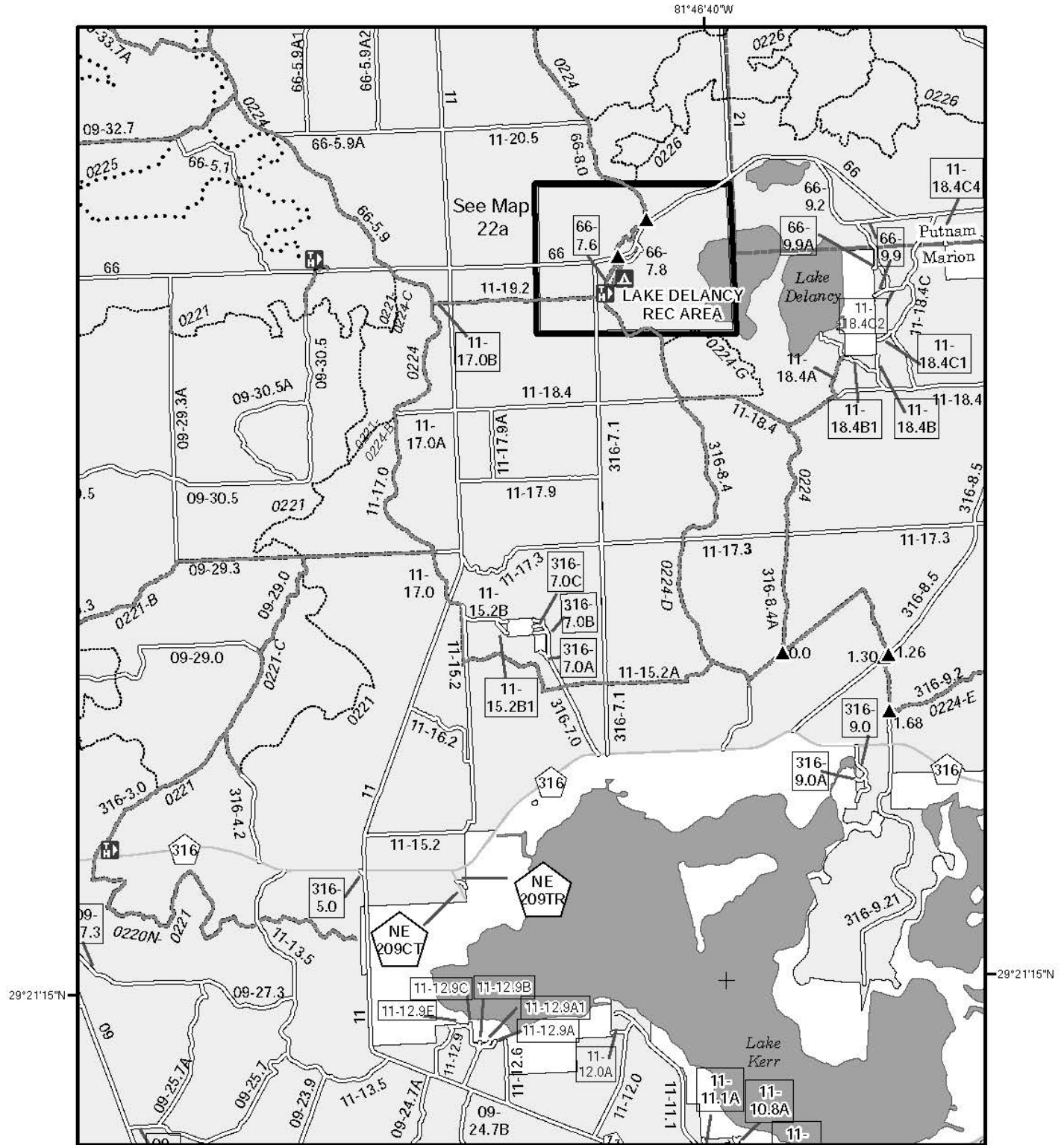

North American Datum of 1983 (NAD 83)
State Plane, zone 903

Adjacent Map Pages

24	25	26
21	22	23
17	18	19

LEGEND

Roads Open to Highway Legal Vehicles Only	Highways, US, State	Political/Administrative Boundary	Information Site
Trails Open to Wheeled Vehicles 50' or Less in Width	Other Public Roads	Forest or Unit Boundary	Milepost Marker
Trails Open to Motorcycles Only	National Forest System Lands	Lakes and Rivers	FS Campground
Special Vehicle Designation (See Table)	Non-National Forest System Lands within the National Forest	Picnic Area	Motorized Trailhead
Seasonal Designation (Used along with road or trail listed above)	Wilderness		



FS-873-817





81°46'40"W

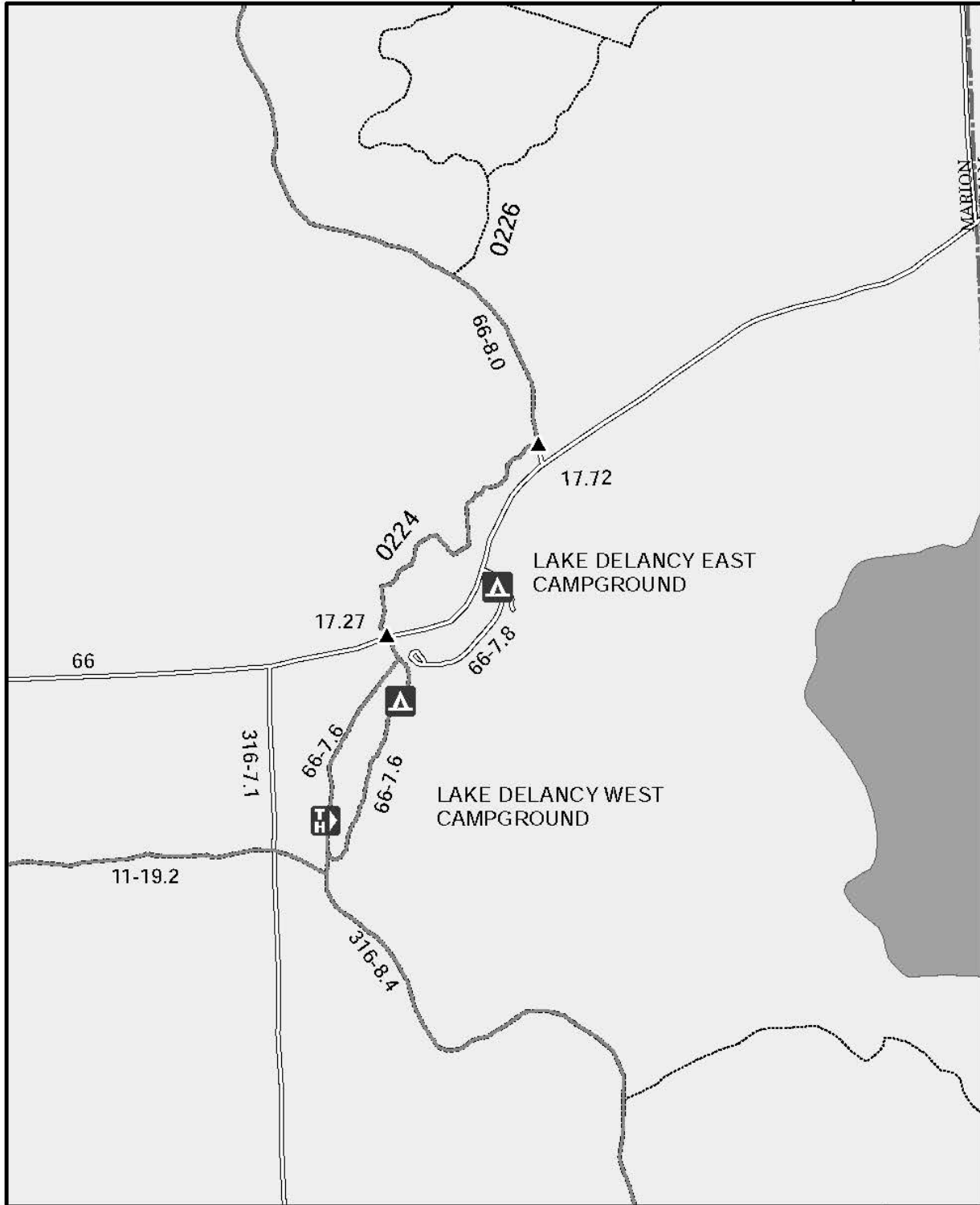

North American Datum of 1983 (NAD 83)
State Plane, zone 903

Adjacent Map Pages

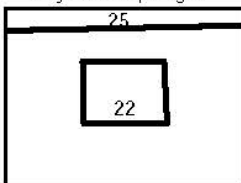

LEGEND

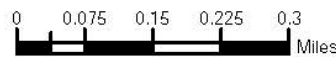

FS-873-817

Roads Open to Highway Legal Vehicles Only	Highways, U.S. State	Political/Administrative Boundary	Information Site
Trails Open to Wheeled Vehicles 50" or Less in Width	Other Public Roads	Lakes and Rivers	Milepost Marker
Trails Open to Motorcycles Only	Forest or Unit Boundary	FS Campground	N
Special Vehicle Designation (See Table)	National Forest System Lands	Picnic Area	
Seasonal Designation (See Table) (Used along with road or trail listed above)	Non-National Forest System Lands within the National Forest	Motorized Trailhead	
	Wilderness		



81°39'35"W

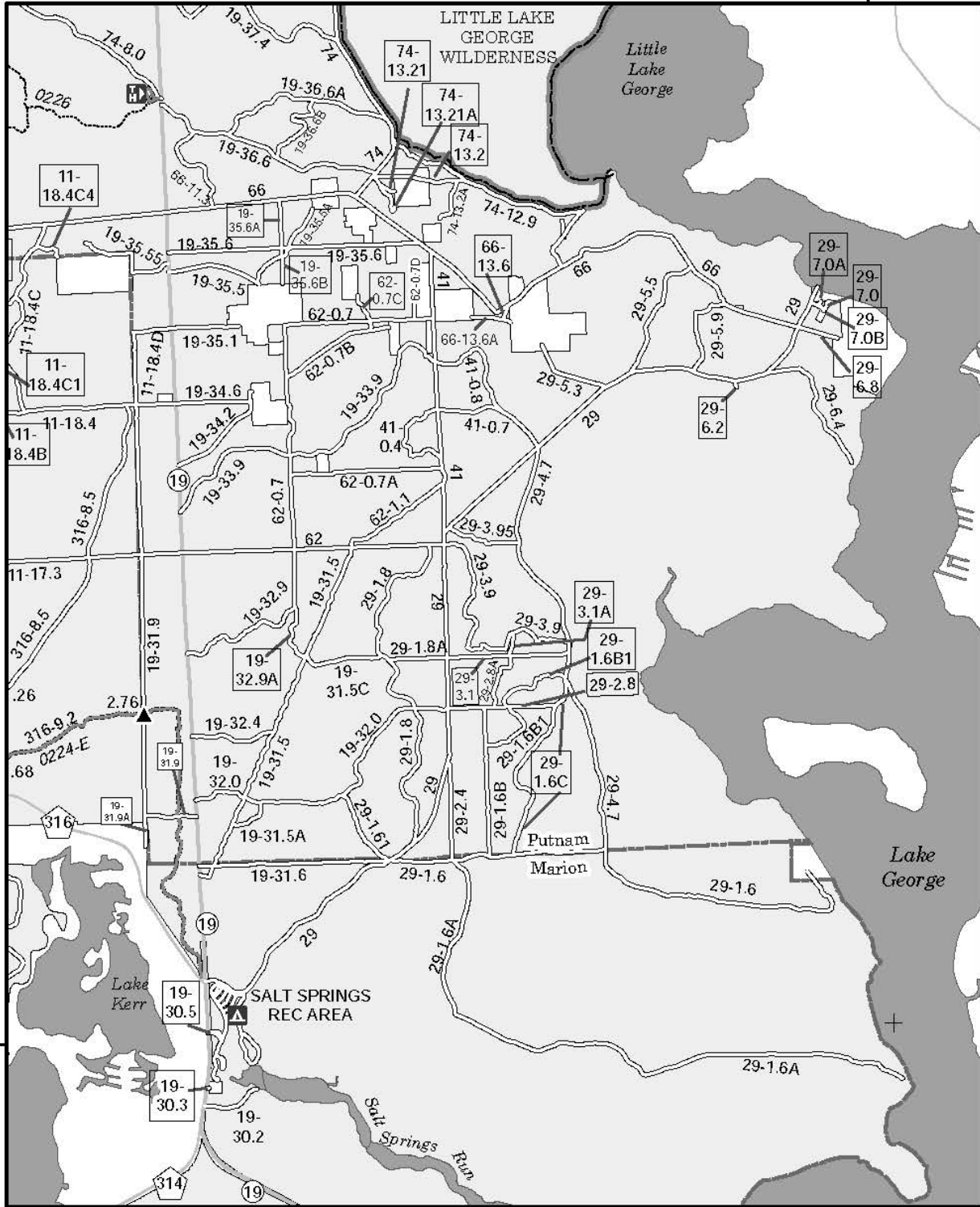

29°21'15"N

29°21'15"N

81°39'35"W

North American Datum of 1983 (NAD 83)
State Plane, zone 903

Adjacent Map Pages

25	26	
22	23	
18	19	20

LEGEND



FS-873-817

Roads Open to Highway Legal Vehicles Only	Highways, US, State	Political/Administrative Boundary	Information Site
Trails Open to Wheeled Vehicles 50" or Less in Width	Other Public Roads	Lakes and Rivers	Milepost Marker
Trails Open to Motorcycles Only	Forest or Unit Boundary	FS Campground	N
Special Vehicle Designation (See Table)	National Forest System Lands	Picnic Area	
Seasonal Designation (Used along with road or trail listed above)	Non-National Forest System Lands within the National Forest	Motorized Trailhead	
	Wilderness		



81°53'45"W

29°28'20"N

29°28'20"N

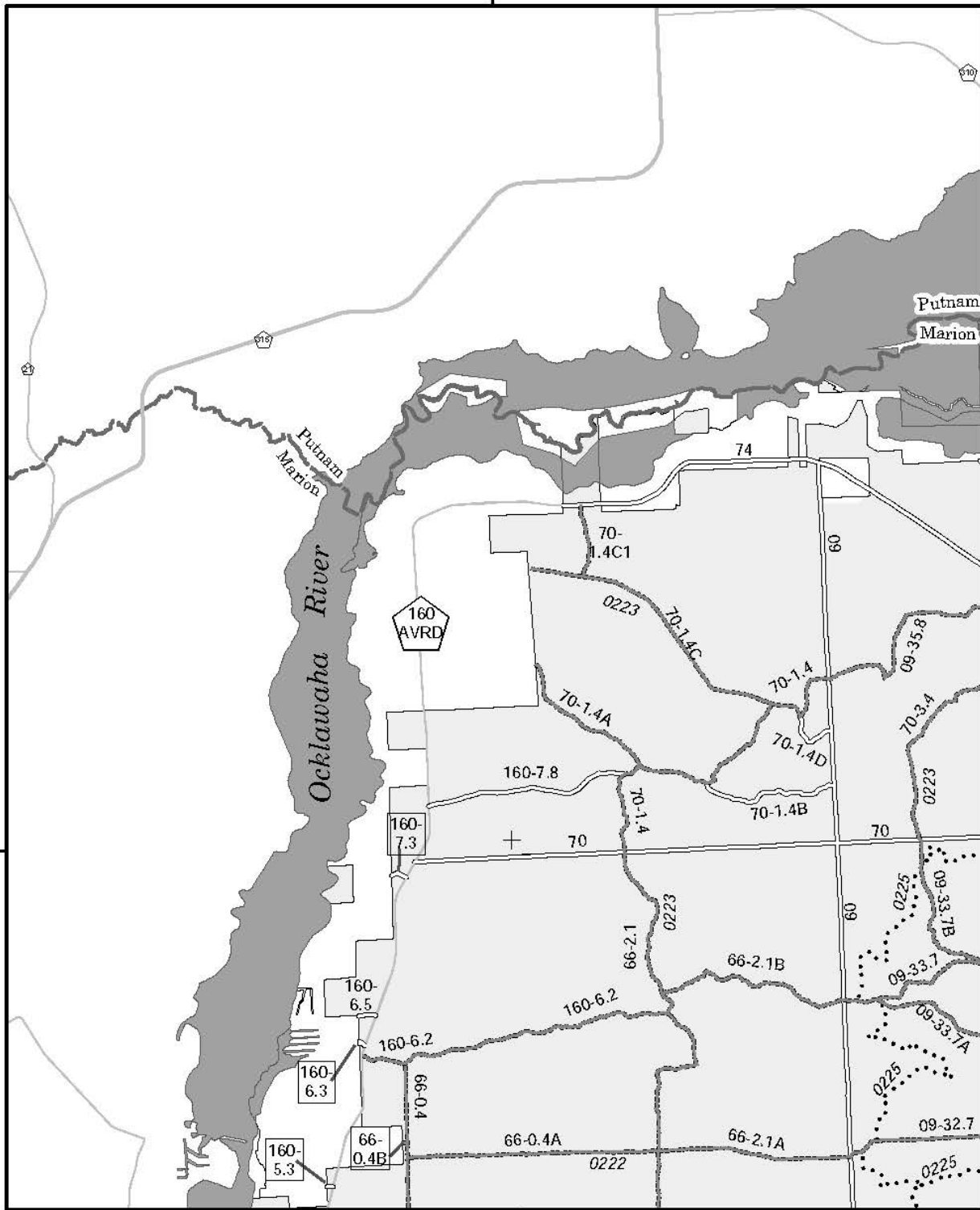

North American Datum of 1983 (NAD 83)
State Plane, zone 903

81°53'45"W

Adjacent Map Pages

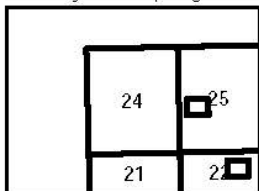

LEGEND

Roads Open to Highway Legal Vehicles Only	Trails Open to Wheeled Vehicles 50" or Less in Width	Trails Open to Motorcycles Only	Special Vehicle Designation (See Table)	Seasonal Designation (Used along with road or trail listed above)	Highways, US, State	Other Public Roads	Forest or Unit Boundary	National Forest System Lands	Non-National Forest System Lands within the National Forest	Wilderness	Political/Administrative Boundary	Information Site
					Lakes and Rivers	FS Campground	Picnic Area	Motorized Trailhead				Milepost Marker

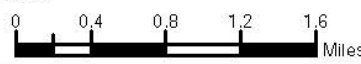

FS-873-817



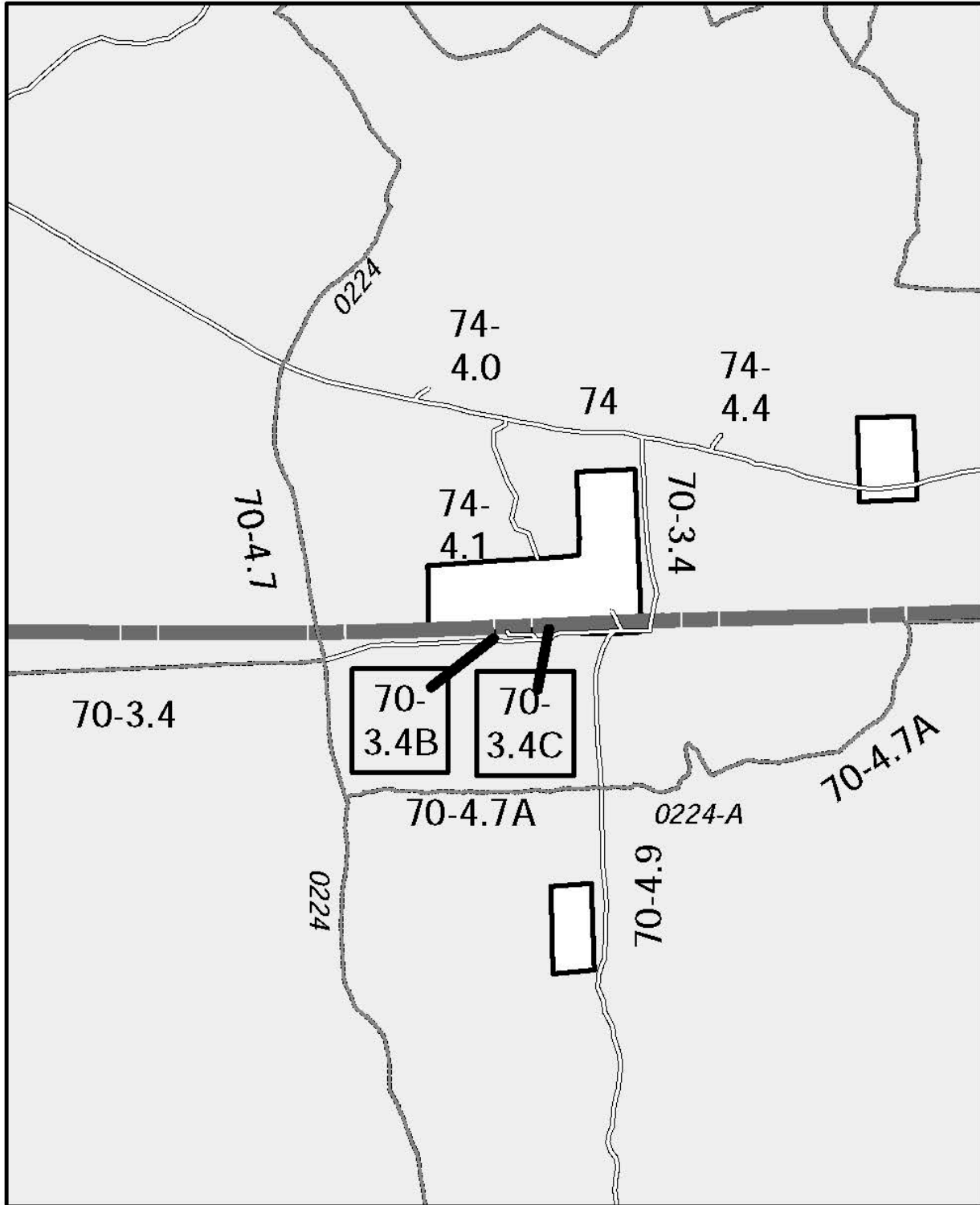

North American Datum of 1983 (NAD 83)
State Plane, zone 903

Adjacent Map Pages

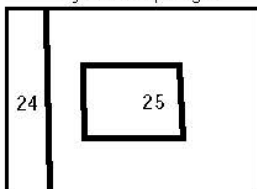

LEGEND



FS-873-817

Roads Open to Highway Legal Vehicles Only	Highways, US, State	Political/Administrative Boundary	Information Site
Trails Open to Wheeled Vehicles 50" or Less in Width	Other Public Roads	Lakes and Rivers	Milepost Marker
Trails Open to Motorcycles Only	Forest or Unit Boundary	FS Campground	N
Special Vehicle Designation (See Table)	National Forest System Lands	Picnic Area	
Seasonal Designation (Used along with road or trail listed above)	Non-National Forest System Lands within the National Forest	Motorized Trailhead	
	Wilderness		

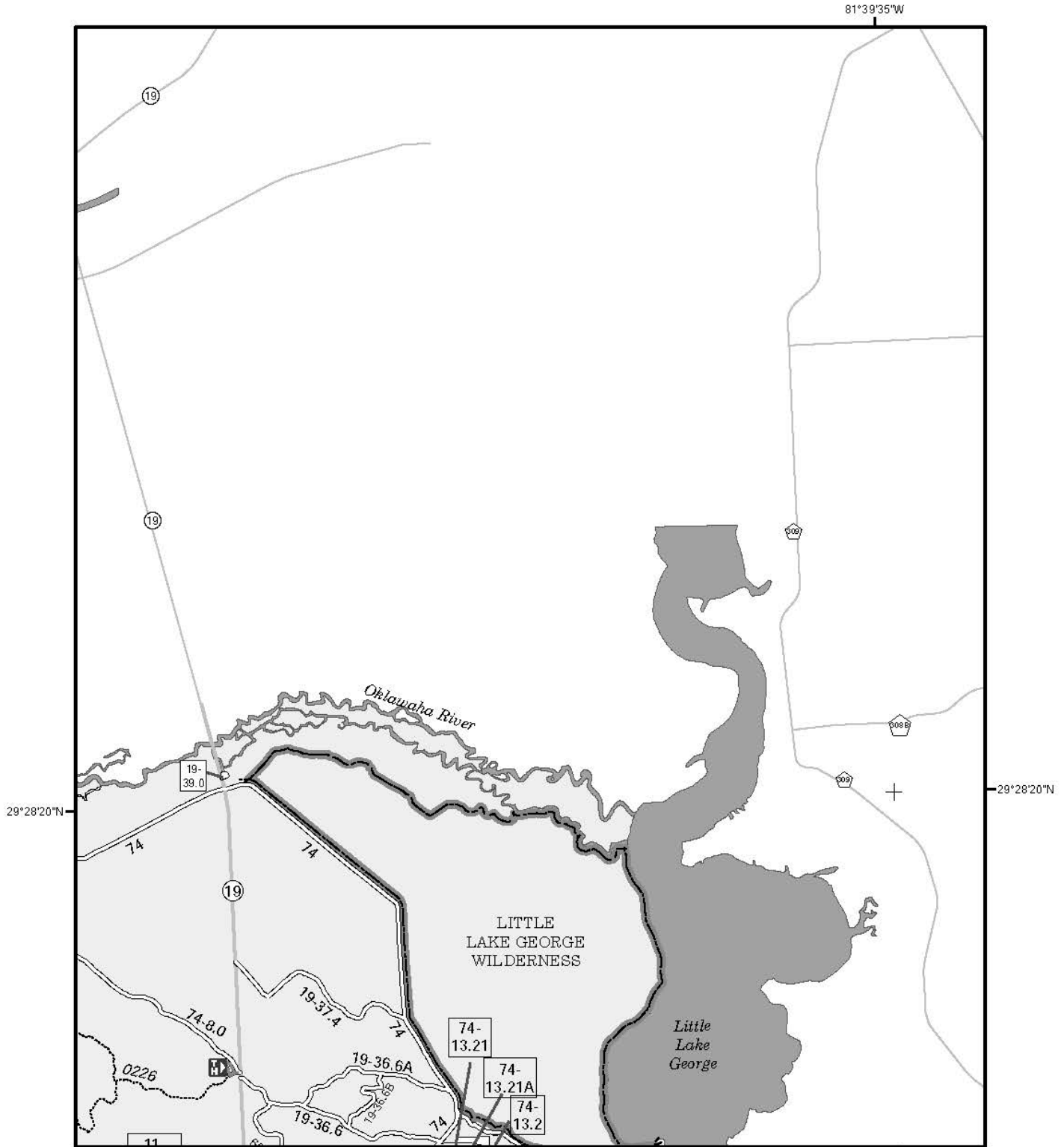

North American Datum of 1983 (NAD 83)
State Plane, zone 903

Adjacent Map Pages

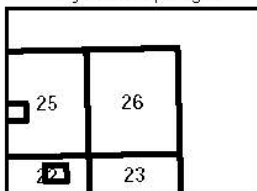

LEGEND



FS-873-817

Roads Open to Highway Legal Vehicles Only	Highways, U.S. State	Political/Administrative Boundary	Information Site
Trails Open to Wheeled Vehicles 50" or Less in Width	Other Public Roads	Lakes and Rivers	Milepost Marker
Trails Open to Motorcycles Only	Forest or Unit Boundary	FS Campground	
Special Vehicle Designation (See Table)	National Forest System Lands	Picnic Area	
Seasonal Designation (Used along with road or trail listed above)	Non-National Forest System Lands within the National Forest	Motorized Trailhead	
	Wilderness		

