

2018

AP Products

Hardware Catalog



AP Products

Adhesives.....	23-24	Hardware	5, 8, 12-15
Air Diffusers & Outlets	15	Hinges & Magnetic Catches	9
Battery Boxes	36	Keyed Alike Padlocks	1
Catches.....	11	Kwik Bandit™	33-34
Coil N' Wrap	25-26	Plug-Guard / Nappy Kamper / GTG	
Dolly Trailer Pads & RV Jack Pads	27	Fusion Tape.....	27
Door Holdbacks	7, 10	Positive Catches.....	10
Door Knobs & Door Locks.....	1-5	Shelf Hog.....	20
Drawer Hardware	17-18	Slideout Slicker / Slideout Sled.....	14
Floor Registers	15	Slim Shade™ / Vent Shade	6
Fresh Cab, Stay Away & Bug Shield..	28	Star Lights.....	29-32
Gas Props & Accessories.....	21-22	Table Legs & Support.....	16
Glow Max Cordless Light Switch.....	26	Tank Check™ / LP Tank Stand	35
Grayline Housewares.....	19-20		



Keyed-Alike Program

Most RV's come with several different keys. AP Products has worked with popular lock manufacturers to offer a Keyed Alike program for dealers to replace customers locks so one key operates the entry door, baggage doors and slam latches. Ramp doors, bar locks, slam latches, entry locks and handles can be keyed a like in just a few minutes on most coaches by dealers and service techs.

IMPORTANT - All Hardware must be from the same company. All entry handles, slams, cams, bar locks, ect. must be manufactured by the one company. The coach must have ALL Bauer or ALL Global locks to execute the rekey process. Hardware does not come from AP Products keyed a like.

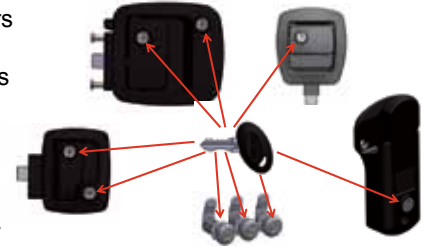

Cylinders

For Bauer & Global Locks and Cams

*A control key from the lock manufacturer is required to perform a cylinder change.

Ask your rep for part numbers and availability to order control keys.

For Bauer

· All Entry door locks, including electric locks, require (1) master cylinder (marked "P" on the cylinder) and (1) non-mastered cylinder (marked "DB" on the cylinder)

· All Bauer Slam Baggage Locks and Cam Baggage Locks use NON-MASTERED ("DB") cylinders for rekeying.

For Global

· All entry door locks require (1) mastered cylinder (marked with "M" on the cylinder) and (1) Non-mastered cylinder (with no markings on the cylinder)

· All Global Slam Baggage Locks and Cam Baggage Locks use NON-MASTERED ("Blank") cylinders for rekeying.

Replacement cylinders are packages of 10 and marked with the key number on the side.



Bauer

Replacement Master and Non-Mastered Lock Cylinders for Bauer Entrance, Slam, and Cam Locks. (Marked on cylinder: P = Paddle, DB = Dead Bolt)

Master

Key Code	Key Code
013-537	350
013-538	351
013-539	352
013-540	353
013-541	354
013-542	355
013-543	356
013-544	357
013-545	358
013-546	359

Non-Mastered

Key Code	Key Code
013-547	350
013-548	351
013-549	352
013-550	353
013-551	354
013-552	355
013-553	356
013-554	357
013-555	358
013-556	359



Global

Replacement Master and Non-Mastered Lock Cylinders for Global Entrance, Slam, and Cam Locks. (Marked on cylinder: M = Mastered, Blank = Non-Mastered)

Master

Key Code	Key Code
013-574	341
013-575	342
013-576	343
013-577	344
013-578	345
013-579	346
013-580	347
013-581	348
013-582	349
013-583	330

Non-Mastered

Key Code	Key Code
013-590	341
013-591	342
013-592	343
013-593	344
013-594	345
013-595	346
013-596	347
013-597	348
013-598	349
013-599	330

Cam Locks

Bauer Cam Lock

Baggage Door Cam Lock with replaceable cylinder. Fits most existing Cam Locks w/ 7/8 Shaft and allows cylinder to be keyed to a matching Bauer Entrance Key code.



- 013-673 Bauer 7/8" Cam
- 013-674 Bauer 1-1/8" Cam
- 013-675 Bauer 1-3/8" Cam

Global Cam Lock

Baggage Door Cam Lock with replaceable cylinder. Fits most existing Cam Locks w/ 7/8 Shaft and allows cylinder to be keyed to a matching Global Entrance Key code.



- 013-584 Global 7/8" Cam
- 013-585 Global 1-1/8" Cam
- 013-586 Global 1-3/8" Cam

Cylinder Cams

013-679 Straight 1/each



013-678 Off-Set 1/each



Barb Cam

Used for outside shower doors and leveling doors.



013-8934351

Keyed-Alike Padlock

013-704

Features a hardened steel shackle, dual latching system, and a protective boot. Secures hitches, LP tanks, battery boxes, ramp doors and more. Part of the Keyed-Alike family (can be keyed to AP Products entrance door locks, slam locks, cam locks, and more).



Keyed-Alike LP Padlock

013-705

Features a bracket to mount the LP Regulator and securely lock the tanks when mounted to the RV. The hasp prevents the wing nut from being turned and is easily installed and removed. Comes with a Keyed-Alike padlock and can be re-keyed to other lock such as entrance door locks and more.



Locks

Standard Entrance Travel Trailer Locks

Bauer

Direct replacement for standard RV entry door locks. Fits in a 2-3/4"x3-1/4" cutout. Features Bauer's SCI technology to prevent tampering with lock cylinders. Low profile inside egress to prevent interference with screen door.

- Corrosion resistant
- Lightweight
- UV resistant

- 013-520 Entrance Lock - Black
- 013-534 Entrance Lock - White
- 013-535 Entrance Lock - Chrome



Global

Entrance lock with paddle and deadbolt. Directly replaces most entrance locks on travel trailers and 5th wheels.

- 013-570 Trailer Lock w/Keys - Black
- 013-571 Trailer Lock w/Keys - White
- 013-572 Trailer Lock w/Keys - Chrome



Standard Motor Home - Bauer

Entrance Door Lock designed for motorhomes. Exceeds Federal motorhome vehicle safety standards. Replaces the L300. Will replace Trimark 060-0600 and 060-0650.

- 013-257 RV Entrance Motorhome Lock



Slam Baggage Locks

Bauer Slam Baggage Lock

RV Baggage Door Latch and Lock. "Slam Latch" allows baggage door to be closed with force with a positive latch. Direct replacement for existing slam latch on the market.

- 013-671 Black



Global Slam Baggage Lock

RV Baggage Door Latch and Lock. "Slam Latch" allows baggage door to be closed with force with a positive latch. Direct replacement for existing slam latch on the market.

- 013-573 Black

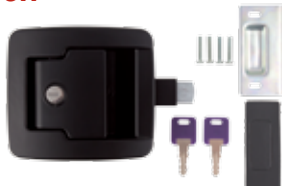

Fastec Slam Baggage Lock

RV Baggage Door Latch and Lock. "Slam Latch" allows baggage door to be closed with force with a positive latch. Direct replacement for existing slam latch on the market.

- 015-246219 Black



Keyless Travel Trailer / 5th Wheel - Bauer

Directly upgrades most travel trailer locks. Offers hassle free touch pad access - no key or fob to carry with you. No wiring needed - uses 4 AA batteries to operate (not included). Comes with key for overriding forgotten code or dead battery.

*** Now has AISentis HSS Technology**

- No "waking up" function as with captive touch technology
- Longer battery life than captive touch locks.
- Features Intelligent Touch Technology Recognition which distinguishes between water and human touch. A glove can also be worn while using the lock.

- 013-509 RH
- 013-530 LH



Keyless Motor Home - Bauer

Meets DOT specifications for motor home use. Offers hassle free touch pad access - no key or fob to carry with you. No wiring needed - uses 4 AA batteries to operate (not included). Comes with key for overriding forgotten code or dead battery.

*** Now has AISentis HSS Technology**

- No "waking up" function as with captive touch technology
- Longer battery life than captive touch locks.
- Features Intelligent Touch Technology Recognition which distinguishes between water and human touch. A glove can also be worn while using the lock.

- 013-531 Electric Motor Home Lock



Horse Trailer Locks - Bauer



- 013-529 Black
- 013-688 Black

Vise Lock - Bauer

For ramp doors

- 013-680 Black



Replacement Keys

Key Blanks

Bauer

013-515 Bauer RV300 Key Blanks (Bulk)

Global

013-676 Global Key Blanks (Bulk)

Fastec

015-269629 Fastec Key Blanks (Bulk)



CH751 Key

013-751 CH751 Cam Lock Key



Bauer AE Series Replacement Keys

Commonly used in horse trailer locks.
Chrome

013-700



Key Codes
001-060



Bauer OEM RV Series Replacement Keys

New series used by trailer manufactures
for the keyed a like program.
Grey

013-699



Key Codes
701-760



Part#	Qty	Key Code	Part#	Qty	Key Code	Part#	Qty	Key Code
013-689001	5	001	013-689022	5	022	013-689043	5	043
013-689002	5	002	013-689023	5	023	013-689044	5	044
013-689003	5	003	013-689024	5	024	013-689045	5	045
013-689004	5	004	013-689025	5	025	013-689046	5	046
013-689005	5	005	013-689026	5	026	013-689047	5	047
013-689006	5	006	013-689027	5	027	013-689048	5	048
013-689007	5	007	013-689028	5	028	013-689049	5	049
013-689008	5	008	013-689029	5	029	013-689050	5	050
013-689009	5	009	013-689030	5	030	013-689051	5	051
013-689010	5	010	013-689031	5	031	013-689052	5	052
013-689011	5	011	013-689032	5	032	013-689053	5	053
013-689012	5	012	013-689033	5	033	013-689054	5	054
013-689013	5	013	013-689034	5	034	013-689055	5	055
013-689014	5	014	013-689035	5	035	013-689056	5	056
013-689015	5	015	013-689036	5	036	013-689057	5	057
013-689016	5	016	013-689037	5	037	013-689058	5	058
013-689017	5	017	013-689038	5	038	013-689059	5	059
013-689018	5	018	013-689039	5	039	013-689060	5	060
013-689019	5	019	013-689040	5	040			
013-689020	5	020	013-689041	5	041			
013-689021	5	021	013-689042	5	042			

Part#	Qty	Key Code	Part#	Qty	Key Code	Part#	Qty	Key Code
013-689701	5	701	013-689721	5	721	013-689741	5	741
013-689702	5	702	013-689722	5	722	013-689742	5	742
013-689703	5	703	013-689723	5	723	013-689743	5	743
013-689704	5	704	013-689724	5	724	013-689744	5	744
013-689705	5	705	013-689725	5	725	013-689745	5	745
013-689706	5	706	013-689726	5	726	013-689746	5	746
013-689707	5	707	013-689727	5	727	013-689747	5	747
013-689708	5	708	013-689728	5	728	013-689748	5	748
013-689709	5	709	013-689729	5	729	013-689749	5	749
013-689710	5	710	013-689730	5	730	013-689750	5	750
013-689711	5	711	013-689731	5	731	013-689751	5	751
013-689712	5	712	013-689732	5	732	013-689752	5	752
013-689713	5	713	013-689733	5	733	013-689753	5	753
013-689714	5	714	013-689734	5	734	013-689754	5	754
013-689715	5	715	013-689735	5	735	013-689755	5	755
013-689716	5	716	013-689736	5	736	013-689756	5	756
013-689717	5	717	013-689737	5	737	013-689757	5	757
013-689718	5	718	013-689738	5	738	013-689758	5	758
013-689719	5	719	013-689739	5	739	013-689759	5	759
013-689720	5	720	013-689740	5	740	013-689760	5	760

Key Cabinets

Bauer 013-689
Key Cabinet With Drawers
(5) Keys Each Of (60) Key Codes

Global 013-690
Key Cabinet With Drawers
(5) Keys Each Of (50) Key Codes

Fastec 013-691
Key Cabinet With Drawers
(5) Keys Each Of (51) Key Codes

Cabinets measure: 15" wide x 19" tall x 7" deep



Bauer Key Codes 301-360



Global Key Codes 301-350



Fastec Key Codes 301-351

Precut Factory Replacement Keys

Bauer

Part#	Qty	Key Code	Part#	Qty	Key Code
013-689301	5	301	013-689331	5	331
013-689302	5	302	013-689332	5	332
013-689303	5	303	013-689333	5	333
013-689304	5	304	013-689334	5	334
013-689305	5	305	013-689335	5	335
013-689306	5	306	013-689336	5	336
013-689307	5	307	013-689337	5	337
013-689308	5	308	013-689338	5	338
013-689309	5	309	013-689339	5	339
013-689310	5	310	013-689340	5	340
013-689311	5	311	013-689341	5	341
013-689312	5	312	013-689342	5	342
013-689313	5	313	013-689343	5	343
013-689314	5	314	013-689344	5	344
013-689315	5	315	013-689345	5	345
013-689316	5	316	013-689346	5	346
013-689317	5	317	013-689347	5	347
013-689318	5	318	013-689348	5	348
013-689319	5	319	013-689349	5	349
013-689320	5	320	013-689350	5	350
013-689321	5	321	013-689351	5	351
013-689322	5	322	013-689352	5	352
013-689323	5	323	013-689353	5	353
013-689324	5	324	013-689354	5	354
013-689325	5	325	013-689355	5	355
013-689326	5	326	013-689356	5	356
013-689327	5	327	013-689357	5	357
013-689328	5	328	013-689358	5	358
013-689329	5	329	013-689359	5	359
013-689330	5	330	013-689360	5	360

Global

Part#	Qty	Key Code	Part#	Qty	Key Code
013-690301	5	301	013-690326	5	326
013-690302	5	302	013-690327	5	327
013-690303	5	303	013-690328	5	328
013-690304	5	304	013-690329	5	329
013-690305	5	305	013-690330	5	330
013-690306	5	306	013-690331	5	331
013-690307	5	307	013-690332	5	332
013-690308	5	308	013-690333	5	333
013-690309	5	309	013-690334	5	334
013-690310	5	310	013-690335	5	335
013-690311	5	311	013-690336	5	336
013-690312	5	312	013-690337	5	337
013-690313	5	313	013-690338	5	338
013-690314	5	314	013-690339	5	339
013-690315	5	315	013-690340	5	340
013-690316	5	316	013-690341	5	341
013-690317	5	317	013-690342	5	342
013-690318	5	318	013-690343	5	343
013-690319	5	319	013-690344	5	344
013-690320	5	320	013-690345	5	345
013-690321	5	321	013-690346	5	346
013-690322	5	322	013-690347	5	347
013-690323	5	323	013-690348	5	348
013-690324	5	324	013-690349	5	349
013-690325	5	325	013-690350	5	350

Fastec

Part#	Qty	Key Code	Part#	Qty	Key Code
013-691301	5	301	013-691327	5	327
013-691302	5	302	013-691328	5	328
013-691303	5	303	013-691329	5	329
013-691304	5	304	013-691330	5	330
013-691305	5	305	013-691331	5	331
013-691306	5	306	013-691332	5	332
013-691307	5	307	013-691333	5	333
013-691308	5	308	013-691334	5	334
013-691309	5	309	013-691335	5	335
013-691310	5	310	013-691336	5	336
013-691311	5	311	013-691337	5	337
013-691312	5	312	013-691338	5	338
013-691313	5	313	013-691339	5	339
013-691314	5	314	013-691340	5	340
013-691315	5	315	013-691341	5	341
013-691316	5	316	013-691342	5	342
013-691317	5	317	013-691343	5	343
013-691318	5	318	013-691344	5	344
013-691319	5	319	013-691345	5	345
013-691320	5	320	013-691346	5	346
013-691321	5	321	013-691347	5	347
013-691322	5	322	013-691348	5	348
013-691323	5	323	013-691349	5	349
013-691324	5	324	013-691350	5	350
013-691325	5	325	013-691351	5	351
013-691326	5	326			

Door Locks, Latches, & Stops

Entrance Lock Set Knob-Knob

May be used as 2-3/8" or 2-3/4" backset, includes both standard and drive-in latches. Offered in Polish Brass or Stainless Steel Finish.

- 013-220** Entrance Lock Set Knob - Knob Polish Brass Finish
013-220-SS Entrance Lock Set Knob - Knob Stainless Steel



Privacy/Passage Lock Set

Privacy offers turn button lock; passage does not. May be used as either a 2-3/8" or 2-3/4" backset. Offered in Stainless Steel or Polish Brass Finish. *Privacy Lock Set Shown Only*

- 013-202** Privacy Knob - Knob Polish Brass Finish
013-202-SS Privacy Knob - Knob Stainless Steel Finish
013-203 Passage Knob - Knob Polish Brass Finish
013-203-SS Passage Knob - Knob Stainless Steel Finish



Entrance Lock Set Knob-Lever

Knob-Lever Entrance Lock Set may be used as 2-3/8" or 2-3/4" backset, includes both standard and drive-in latches. Offered in Polish Brass or Stainless Steel Finish.

- 013-235** Entrance Knob - Lever Polish Brass Finish
013-235-SS Entrance Knob - Lever Stainless Steel Finish



Combo Lock Set

Offers both a Knob-Knob and a Dead Bolt Lock with matching keys. May be used as a 2-3/8" or 2-3/4" backset, includes both standard and drive-in backsets. Offered in Polish Brass or Stainless Steel Finish.

- 013-234** Combo Lock Set Polish Brass Finish
013-234-SS Combo Lock Set Stainless Steel Finish



Deadbolt Lock Set

Single Deadbolt may be used as a 2-3/8" or 2-3/4" backset. Includes both standard and drive latches. Offered in Polish Brass or Stainless Steel Finish.

- 013-222** Dead Bolt Single Polished Brass
013-222-SS Dead Bolt Single Stainless Steel



Privacy/Passage Entrance Lock Set Lever-Lever

Lever-Lever Entrance Lock may be used as 2-3/8" or 2-3/4" backset, includes both standard & drive in latches. Offered in privacy and passage.

- 013-231** Lever Privacy Lock - Polished Brass
013-231-SS Lever Privacy Lock - Stainless Steel
013-230 Lever Passage Lock - Polished Brass
013-230-SS Lever Passage Lock - Stainless Steel



Door Stops

- 013-193-SP** Floor Mount - Satin Pewter (1/Ctn)
013-193 Floor Mount - Brass (1/Ctn)
013-193-BL Floor Mount - Black (1/Ctn)
013-193-AB Floor Mount - Antique Brass (1/Ctn)
013-193-OB Floor Mount - Oiled Bronze (1/Ctn)



Bath Door Latch Low Pro

- 1 Set w/Screws
013-063 Bath Door Latch Brass



Plastic Flush Mount Latch w/Strike & Screws

- 013-015** Flush Mount Latch - Brown
013-015-T Flush Mount Latch - Tan





RV Vent Shade

- Mylar Backed Shade Blocks Most Light From Crank Vents
- Simply Installs Over Current Trim With Existing Screws
- Conforms To Curved Ceilings Without Modification
- Shade Can Be Replaced
- Reduces Heat
- Easily Retracted To Allow Natural Light In

015-201612
RV Vent Shade
White

SLIM SHADE™

Patent Pending

**Shade When You Need It...
See Out When You Don't!**

Directly replaces existing window and frame or add to door with no window with the template that is provided.

Complete unit comes with black frame, tinted window glass and recessed pleated shade.

Easily installs with only a screwdriver. Screws included. Fits most RV Doors



015-201512
Slim Shade™ Complete Unit
Black

**Replacement Parts*



015-2014782
Slim Shade™ Window
Frame Only
Black



015-201496
Tinted Window Glass
12-1/2" x 21"
Black



015-201502
Slim Shade™ Replacement
Shade Only
Black

Also see page 13 in Service Catalog

DOOR HOLDBACKS

Plastic Door Holdback 1 Set w/Screws



- 3-1/2" Door Holdback
- 013-084** Colonial White
- 013-084W** White
- 013-084BL** Black
- 6" Door Holdback
- 013-085** Colonial White
- 013-085W** White
- 013-085BL** Black
- 8" Door Holdback
- 013-064BL** Black

Plastic Door Holdbacks 1 Set w/Screws

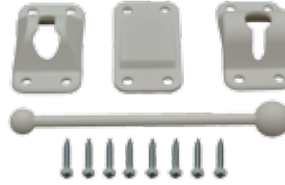

- 013-237**
- 4" Plastic Door Holdback
- White
- 013-238**
- 6" Plastic Door Holdback
- White
- 013-239**
- 10" Plastic Door Holdback
- White



- 5-1/2" Door Holdback
- 013-087** Colonial White
- 013-087-W** White

Metal Door Holdback 1 Set w/Screws



- 013-147**
- 2-5/8" Door Holdback
- 013-104**
- 3" Door Holdback

Metal Door Holdback 2 Sets w/Screws



- 013-246**
- 3" Metal Door Holdback
- Zinc
- 013-247**
- 4" Metal Door Holdback
- Zinc

013-086
3" Door Holdback
Colonial White

013-086-W
3" Door Holdback
White

013-088
3" Male Piece Only
Colonial White

013-088-W
3" Male Piece Only
White

013-089
Female Piece Only
Colonial White

013-089-W
Female Piece Only
White

Nylon Bumper 1 Piece

- 1-1/4" Nylon Bumper
- 013-090** Colonial White
- 013-090-W** White
- 2-7/8" Nylon Bumper
- 013-091** Colonial White
- 013-091-W** White
- 013-091-BL** Black

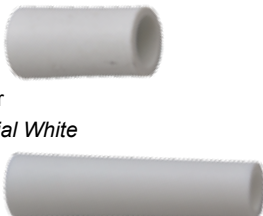

Rubberized Magnets are an easy-to-install and simple to use powerful magnetic connection system perfect for replacing traditional latches. For the exterior they can be used for applications such as the baggage/storage compartments and on the interior the magnets can be used for various cabinet applications. Are also great when used individually (interior or exterior) for hanging small objects such as: keys, tools, USB/device chargers, bottle openers, fly swatters, brooms, lighters, and small flashlights. The applications are endless!

- 013-09801** Polar White (2 sets)
- 013-09802** Black (2 sets)

Magnetic Door Holdbacks



RV & MH Hardware

Window Crank Handles

Part#	Size	Description	Color	Qty
013-408	3/4"	Plastic w/Screw	Beige	1
013-408-4	3/4"	Plastic w/Screw	Beige	4
013-408B	3/4"	Plastic w/Screw	Black	1
013-408B-4	3/4"	Plastic w/Screw	Black	4
013-408W	3/4"	Plastic w/Screw	White	1
013-185	1"	Metal		1
013-185-2	1"	Metal		2
013-410	1-1/4"	Plastic w/Screw	Beige	1
013-410-4	1-1/4"	Plastic w/Screw	Beige	4
013-410B	1-1/4"	Plastic w/Screw	Black	1
013-410B-4	1-1/4"	Plastic w/Screw	Black	4
013-184	1-3/4"	Metal		1
013-184-2	1-3/4"	Metal		2
013-409	1-3/4"	Plastic w/Screw	Beige	1
013-409-4	1-3/4"	Plastic w/Screw	Beige	4
013-409B	1-3/4"	Plastic w/Screw	Black	1
013-409B-4	1-3/4"	Plastic w/Screw	Black	4
013-409W	1-3/4"	Plastic w/Screw	White	1
013-407	2-3/16"	Plastic w/Screw	Beige	1
013-407-4	2-3/16"	Plastic w/Screw	Beige	4
013-407B	2-3/16"	Plastic w/Screw	Black	1
013-407B-4	2-3/16"	Plastic w/Screw	Black	4
013-405	3"	Plastic w/Screw	Beige	1
013-405-4	3"	Plastic w/Screw	Beige	4
013-405B	3"	Plastic w/Screw	Black	1
013-405B-4	3"	Plastic w/Screw	Black	4
013-405W	3"	Plastic w/Screw	White	1



Plastic Window Crank Handle Extension

Part#	Size	Description	Color	Qty
013-422	2"	Plastic Crank Extension	Beige	1
013-422B	2"	Plastic Crank Extension	Black	1
013-406	3"	Plastic Crank Extension	Beige	1
013-406B	3"	Plastic Crank Extension	Black	1



Exit Window Latch

- 013-242 Exit Window Latch - RH
- 013-245 Exit Window Latch - LH



Part#	Description	Shaft	Color	Qty
013-510	Window Knob - Short w/Screw	1/2"	White	1
013-511	Window Knob - Long w/Screw	1"	White	1
013-512	Window Knob - Short w/Screw	1/2"	Black	1
013-513	Window Knob - Long w/Screw	1"	Black	1
013-713	Mini Window Knob w/Screw		Black	1



Round Window Crank Handles

Part#	Shaft Size	Description	Color
013-186	7/8" shaft	Round Window Crank Handle w/Screws	Black
013-417-W	7/8" shaft	Round Window Crank Handle w/Screws	White
013-416	5/16" shaft	Round Window Crank Handle w/Screws	Black
013-415W	5/16" shaft	Round Window Crank Handle w/Screws	White



Window Operators

- 013-183 Window Operator
1/4" Hub projection

- 013-182 Window Operator
5/8" Hub projection



Folding Shelf Bracket

- 013-243 Brown



Hinges & Magnetic Catches

3/8" Offset Self-Closing Hinge



013-048
English 3/8" Offset Hinge
2 Sets

Self-Closing Hinge



013-045
English Self-Closing Hinge
2 Sets



013-045-B
Brass Self-Closing Hinge
2 Sets

Non Self-Closing Hinge



013-049-B
Brass Non Self-Closing Hinge
2 Sets

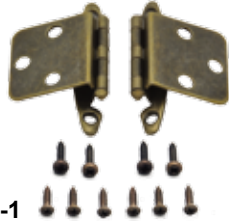

013-049-1
English Non Self-Closing Hinge
1 Set
013-049
English Non Self-Closing Hinge
2 Sets

English Adjustable Hinge



013-053
Adjustable Hinge
2 Sets

Overhead Hinge



013-043
Overhead Hinge
2 Sets

Deluxe Non-Mortise Hinge



013-136
Brass 2/Ctn
013-136-SN
Satin Nickel 2/Ctn (no screws)

Non-Mortise Hinge

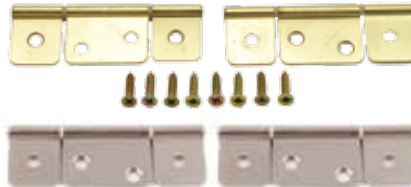

013-046
Brass 2/Ctn
013-046-SN
Satin Nickel 2/Ctn (no screws)

Non-Mortise Hinge



013-248
Non-Mortise Hinge w/ Extended Center -
Satin Nickel
2/Ctn (no screws)

Concealed Magnetic Catch



013-012
Side Mount Magnetic Catch
w/ Flat Strike
2 Sets



013-013
Magnetic Catch w/ Flat Strike
2 Sets



013-030
Universal Magnetic Catch
1 Set



013-014-1
Magnetic Catch w/ L Strike
1 Set
013-014
Magnetic Catch w/ L Strike
2 Sets

Positive Catches

English Positive Thumb Catch - 1 Set

013-009
Thumb Catch
3/8" Strike

013-007
Thumb Catch
1/2" Strike

013-010
Thumb Catch
5/8" Strike

013-008
Thumb Catch
3/4" Strike



English Positive Thumb Catch - 1 Set

013-020
Thumb Catch
3/8" Strike

013-018
Thumb Catch
1/2" Strike

013-021
Thumb Catch
5/8" Strike

013-019
Thumb Catch
3/4" Strike



Part#	Stem	Qty
013-024-1	5/8"	1
013-024	5/8"	2
013-028-1	3/4"	1
013-028	3/4"	2
013-025-1	7/8"	1
013-025	7/8"	2

Part#	Stem	Qty
013-022-1	1"	1
013-022	1"	2
013-027-1	1-1/4"	1
013-027	1-1/4"	2
013-023-1	1-3/8"	1
013-023	1-3/8"	2

Concealed Positive Catch



Door Holdbacks

**Metal Door Holdback
Straight
1 Set w/Screws**



013-092
3" Door Holdback



013-092-B
3" Door Holdback
Plunger Only



013-094
4-3/4" Door Holdback



013-192
Metal Socket for
092/093/094/095



013-093
3" Angle Door Holdback
Holdback



013-093-B
3" Angle Door Holdback
Plunger Only



013-095
4-3/4" Angle Door Holdback

**Metal Door Holdback
Angle
1 Set w/Screws**



013-058
Rubber Replacement (1)

Catches

Friction Catches



013-037-1
Bulldog Catch
1 Set
013-037
Bulldog Catch
2 Sets

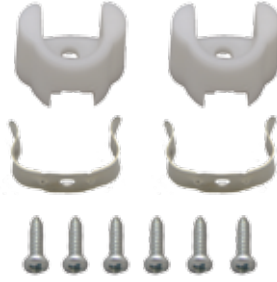

013-032
Friction Catch
2 Sets



013-066-1
Barrel Catch
1 Set
013-066
Barrel Catch
2 Sets
013-066-6
Barrel Catch
6 Sets

Roller Catches



013-017
Single Roller Catch
2 Sets



013-033-1
Single Roller Catch
1 Set
013-033
Single Roller Catch
2 Sets



013-031
Double Roller Catch
2 Sets



013-006-1
Double Roller Catch
1 Set
013-006
Double Roller Catch
2 Sets

Rear Socket With Screws

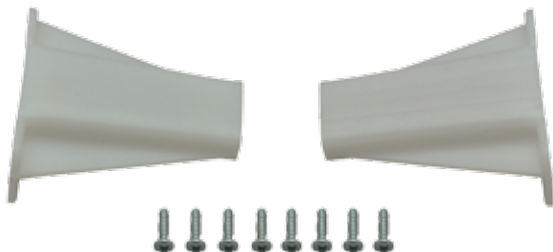

013-137
Left & Right

Brass Bead Catch

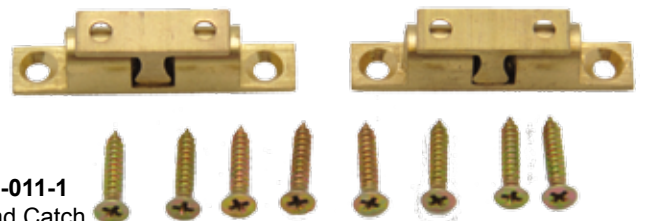

013-011-1
Bead Catch
1 Set
013-011
Bead Catch
2 Sets

RV & MH Hardware

**Baggage Door Holdbacks
Metal Stainless Steel 2 Sets**



013-106
110 Degree Door Holdback

**Baggage Door Holdbacks
Plastic Colors - 2 Sets**



013-097
110 Degree Door Holdback
Colonial White
013-097-W
110 Degree Door Holdback
White
013-097-BL
110 Degree Door Holdback
Black

Draw Pull Latch - Zinc



013-042
Draw Pull Latch Zinc
1 Set

Camper Latch - 1 Set



013-055
Locking Camper Latch
Zinc
013-258
Locking Camper Latch
Black



013-056-W
Non-Locking Camper Latch
White

Baggage Door Camlocks



013-180
Camlock 5/8" w/Key



013-181
Camlock 7/8" w/Key

**Adjustable Latch
for 5/16" Shaft**



013-132
2" Adjustable Latch

RV & MH Hardware

Spring Door Support - Brass



013-057
Door Support
2 Sets

Brass Door Support - 1 Set



013-061
6-1/4" Door Support

Spring Door Support Plastic



013-096
Door Support
Black
2 Piece

013-096-1
Door Support
Black
1 Piece

Bunk Latch With Flat Strike



013-081
Bunk Latch
Brass
1 Piece

013-081-E
Bunk Latch
English
1 Piece

English Knob

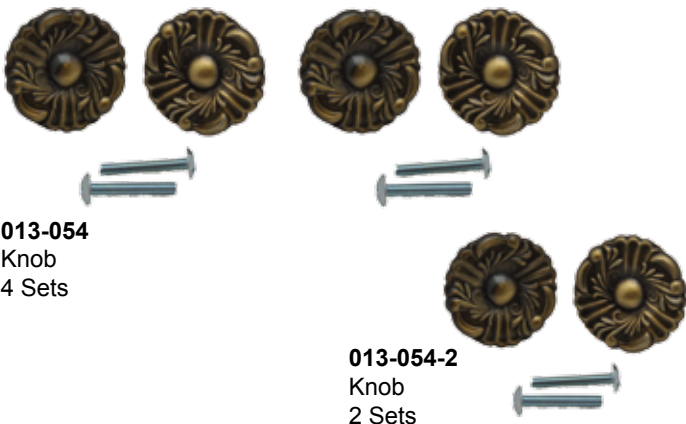

013-054
Knob
4 Sets

013-054-2
Knob
2 Sets

RV & MH Hardware

Mirror Clips

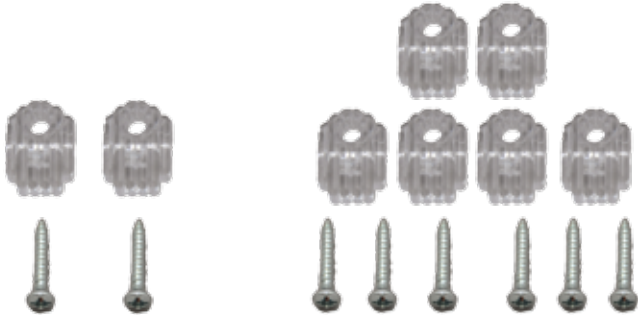

013-149
Clear Plastic Clips
2 Pieces

013-149-6
Clear Plastic Clips
6 Pieces

Rosettes With Screws

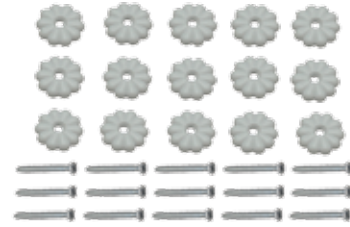

013-134
White Rosettes
15 Pack

Screen Clips



013-414
Double Wing Screen Clip
White
6 Pack

013-465
Screen Clip 3/16" Shank
Gray
6 Pack

013-436
Screen Clip 1/16" Shank
White
6 Pack
013-440
Screen Clip 5/16" Shank
White
6 Pack

013-467
Screen Clip 3/8" Shank
White
6 Pack
013-468
Screen Clip 7/16" Shank
White
6 Pack

3M Self-Stripping Electrical Pigtail Connectors



014-122084-100 100 Pack
014-122084-20 20 Pack
014-122084-5 5 Pack

Slide-Out Slicker / Slide-Out Sled

013-410051
Protect the carpet at both ends of a slide-out room from rain, dirt and wear.

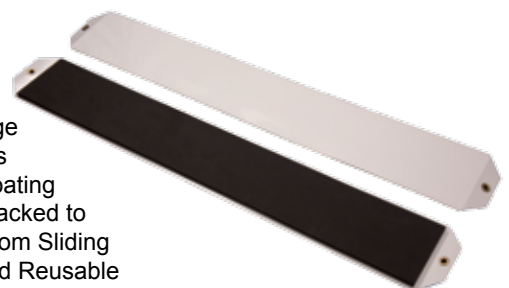

013-4300

- Prevents Damage to Hard Surfaces
- Durable PVC Coating
- Rubber Foam Backed to Prevent Sleds from Sliding
- Long Lasting And Reusable
- 2 Sleds Per Package

RV & MH Hardware

Replacement Caps



013-213
Replacement Cap for City Water
(013-115 & 013-116)

Rivets



013-139
1" Plastic Rivet
Almond
25 Pack



013-140
1" Plastic Rivet
White
25 Pack

Air Diffusers & Outlets

4" Rotaire Register 3840R With Damper



013-060
Walnut
013-062
Beige
013-068
White
013-638
Black

Flexible Air Duct



013-3100-M
4" x 25'
013-665
2" x 25'

Metal Floor Registers



Part #	Size	Overall Size	Color
013-640	2-1/4x10	3-5/8x11-3/8	<i>White</i>
013-641	2-1/4x10	3-5/8x11-3/8	<i>Brown</i>
013-625	4 x 8	5-1/4 x 10	<i>White</i>
013-626	4 x 8	5-1/4 x 10	<i>Brown</i>
013-627	4 x 10	5-1/4 x 12	<i>White</i>
013-628	4 x 10	5-1/4 x 12	<i>Brown</i>
013-629	4 x 12	5-1/4 x 14	<i>White</i>
013-630	4 x 12	5-1/4 x 14	<i>Brown</i>

Metal Face Plates



Part #	Size	Overall Size	Color
013-642	2-1/4x10	3-5/8x11-3/8	<i>White</i>
013-643	2-1/4x10	3-5/8x11-3/8	<i>Brown</i>
013-631	4 x 8	5-1/4 x 10	<i>White</i>
013-632	4 x 8	5-1/4 x 10	<i>Brown</i>
013-633	4 x 10	5-1/4 x 12	<i>White</i>
013-634	4 x 10	5-1/4 x 12	<i>Brown</i>



Table Legs & Support

Adjustable Table Leg Folding

Adjustable legs fold up for easy compact storage when not in use. Adjustments allow for universal applications, brown in color and made from Steel. 29 lb. weight capacity



- 013-070** Adjusts from 26" - 31-1/2" in 1/2" increments
- 013-135** Adjusts from 19-1/2" - 31-1/2" in 1" increments

Non Adjustable Table Leg Folding

This folding Leg offers a fixed length for those that do not need the adjustability. Brown in color and made of steel for long lasting support. Folds away flush for storage.



- 013-071** Leg measures 30-1/2" extended 30 lb. weight capacity
- 013-621** Leg measures 16" extended 100 lb. weight capacity

Table Hinge Bracket Kit

Heavy Metal Hinge swings up and down for support in both Table and Gaucho positions. No need for bedding box cleats. Buy as a complete Kit or, individual pieces as needed.

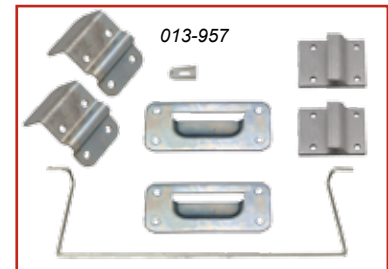

- 013-957** Complete Kit includes all pieces
- 013-958** Wire only
- 013-959** Wall Plate - 2 ea
- 013-960** Bracket Hinge - 2 ea
- 013-961** Table Plate - 2 ea

Folding Shelf Bracket

Fits any type of wall hung shelf. Ideal for heavy shelf loads. Top flange is 9" long and wall flange is 6" long. No other fill in or frames needed.



013-6090 Folding Shelf Bracket 2/Pack

Pedestal Table Legs & Bases

Pedestal Legs and Bases offer strong support for use with a table and easily stow out of the way when wanting to convert to a Gaucho. Chrome plated Legs feature tapered ends to securely fit into bases for steady fast support. Aluminum bases are offered in either Surface Mount or Recessed Models. All legs and bases come packaged 1 per.



- 013-913** 18" Leg Chrome
- 013-916** 21" Leg Chrome
- 013-926** 25-1/2" Leg Chrome
- 013-939** 27-1/2" Leg Chrome
- 013-939B** 27-1/2" Leg Black
- 013-951** 29-1/2" Leg Chrome
- 013-956** 31-1/2" Leg Chrome
- 013-1119** Round Surface Mount Base Chrome
- 013-1119B** Round Surface Mount Base Black
- 013-1112** Round Flush Mount Base Chrome
- 013-1112B** Round Flush Mount Base Black

Folding Table Leg

Folding Table Leg offers strong support for table and folds away when using as Gaucho. Large attachment base measures 4-1/2" x 4-7/8". Leg measures 30-1/2" long and offers positive lock in both positions with convenient release latch.



013-251 Folding Table Leg

Table Wall Mount Support

Table - Wall support bracket measures 30" in length and may be cut to desired length. Two pieces hinge together as one side mounts to wall and one side mounts to table. Slide units together and bracket provides strong secure support for removable table. Use with separate Table Leg.



013-164922 Table - Wall Support bracket

Folding Table Bracket

Small compact design offers strong support in a smaller space. 1-1/2" wide by 2-1/2".



013-250 Folding Table Bracket, 4/pkg

Grace Drawer Hardware

Drawer Slide System

800 SERIES GRACE DRAWER SLIDE SYSTEM
 013-207 (21-1/2")
 013-208 (24")

The 800 Series Drawer Slide System features fast and easy undermount installation coupled with smooth drawer action at a truly economical price. The rolled edges of the 800 Series Rail provide greater strength when coupled with our many varied component parts and mounting options (featured on this page). This rail provides a versatile drawer slide system adapted to your specific needs.

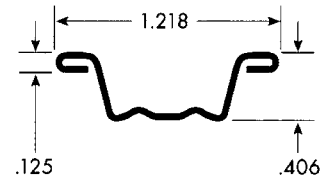
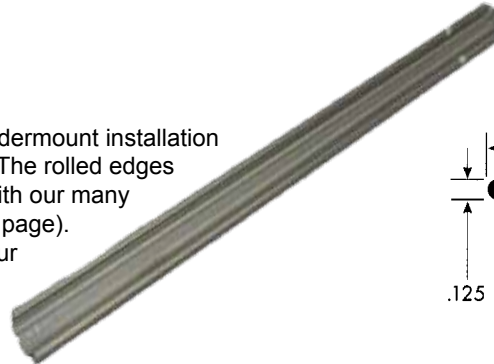

Plastic Components

013-209 GRACE Model No. 100 Backplate (6 pcs)

This natural-color, HDPE backplate is used with our 800 Series Rail. Molded mounting holes, height alignment tabs, and centering guides provide for easy screw or staple installation.

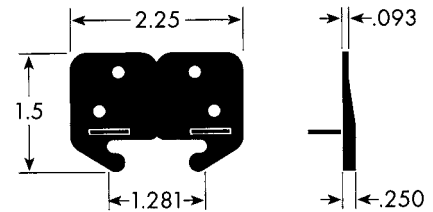
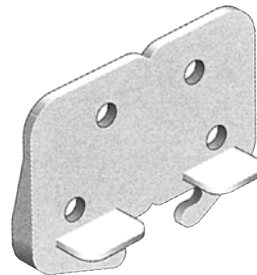

013-210 GRACE Model No. 110 Socket (6 pcs)

Provides for secure attachment of our 800 Series Rail to the case back or framing member. Molded mounting slots for easy screw or staple installation. Socket depth allows for rail length adjustment up to .375 inch.

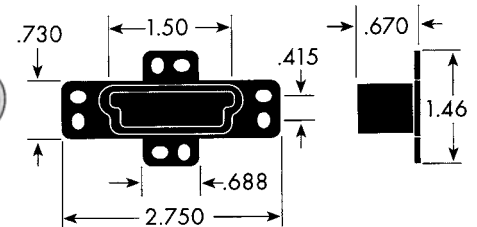
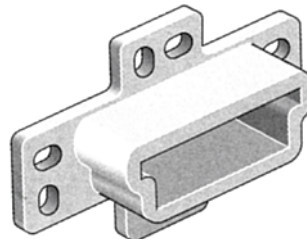

Tech Tip

Our model No. 110 Socket is designed for use in two orientations. the socket may be anchored so as to provide side-to-side adjustability, or inverted for precision alignment.

Corner Glide

013-211 GRACE Model No. 200 Corner Glide

This corner glide possesses superior wear and lubricity for smooth and quiet drawer action. Easy staple installation through the staple pads provided.

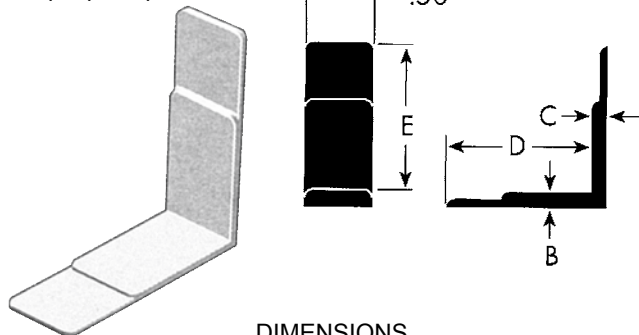

DIMENSIONS

Model	B	C	D	E	Weight/1000
200	0.093	0.093	0.969	0.969	3 lbs.

Drawer Slide Kit

013-212 GRACE Drawer Slide Kit (24" slide)

This corner glide possesses superior wear and lubricity for smooth and quiet drawer action. Easy staple installation through the staple pads provided.

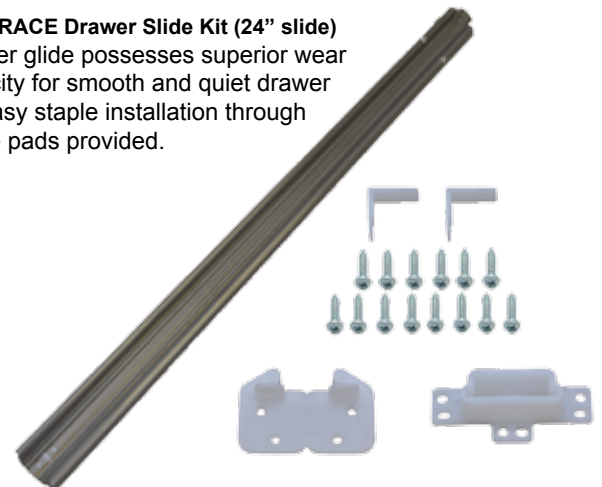

Also available
 013-227 GRACE Drawer Slide Kit (21 1/2" slide)

Delta Drawer Guides

Hanger & Drawer Guide Sets w/Screws

013-083
22-1/2" Drawer Guide



Delta Drawer Slide

013-102
24" Drawer Slide



013-103
21-1/2" Drawer Slide



DELTA Roller Pad

013-107
Roller Pads
6 pack
Standard Base for all
universal applications



Deluxe Drawer Guide

013-082-6
Deluxe Drawer Guide
6/Ctn



DELTA Travel Stop

013-109
DELTA Travel Stop
1 Piece



DELTA Drawer Plate

013-110
DELTA Drawer Plate



DELTA Adjust-O-Mount

013-111
DELTA Adjust-O-Mount
1 Piece

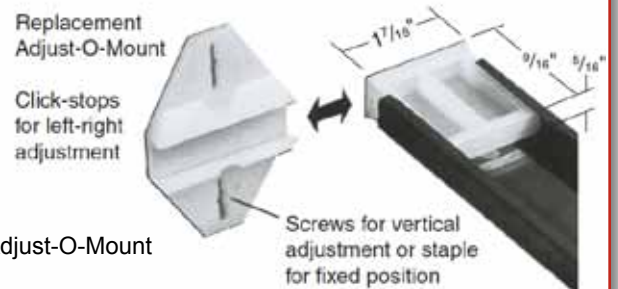

Grayline Housewares



004-213 Plate Rack



004-710 Jumbo Helper Shelf



004-702 Extendible Helper Shelf



004-201 Bowl & Saucer Stack & Tote



004-322 Twin Sink Saver



004-220 Garbage Bag Kaddy



004-231 Wrap Rack (Door or Wall)



004-259 12 Can Beverage Dispenser



004-225 Waste Basket



004-505 Spice Rack



004-506 Double Spice Rack

Grayline Housewares



004-500 Medium Cabinet Rack



004-1102 Handy Portable Shower Caddy



004-1722 Compact Over The Door Towel Bar



004-501 Large Cabinet Rack







004-310 Double Towel Bar



004-1723 Narrow Back-Of-the Door Towel Bar

Shelf Hog 004-514



The premier organizational product for today's RV. The Shelf Hog holds everything in place - stabilizing the contents of refrigerators, cabinets, and all other storage spaces. Simply inflate to the size necessary to fill empty spaces between or on top of items and hog up the extra space. The fatter the Shelf Hog is the tighter it holds. Easy to store and clean.

Gas Props & Accessories

AP Products Hardware Gas Springs

Suspa No.	Part No.	P1 Force	Stroke Length	Extended Length C/L	Refer to Fit Chart
C-16-26210	010-612	15 lb	2.25"	7.50"	
C-16-03213	010-224	13 lb	3.10"	9.80"	1
C-16-10334	010-226	22 lb	3.10"	9.80"	1
C-16-17522	010-177	55 lb	3.15"	9.84"	7-8
C-16-09322	010-178	40 lb	3.15"	9.84"	1
C-16-09903	010-255	24 lb	3.94"	11.57"	8-2
C-16-03795	010-065	24 lb	3.94"	12.20"	1-2-6
C-16-11028	010-112	40 lb	3.94"	12.20"	1
C-16-13313	010-175	30 lb	3.94"	12.20"	6-1
C-16-02716	010-176	13 lb	3.94"	12.20"	8
C-16-10788	010-195	35 lb	3.94"	12.20"	1
C-16-12107	010-636	100 lb	3.94"	12.20"	
C-16-22360	010-143	35 lb	4.92"	13.03"	1
C-16-08584	010-072	60 lb	5.47"	13.98"	1
C-16-10176	010-076	35 lb	5.47"	13.98"	1
C-16-09461	010-173	40 lb	5.47"	13.98"	1
C-16-06389	010-174	24 lb	5.47"	13.98"	1
C-16-11543	010-130	40 lb	4.92"	14.53"	1
C-16-22127	010-196	50 lb	5.47"	15.08"	1
C-16-08941	010-254	28 lb	6.30"	15.71"	1
C-16-21945	010-142	20 lb	6.46"	15.98"	1
C-16-21949	010-189	60 lb	6.46"	15.98"	1
C-16-06867	010-050	60 lb	6.30"	17.13"	1
C-16-02648	010-073	35 lb	6.30"	17.13"	1-6
C-16-06874	010-074	40 lb	6.30"	17.13"	1-6
C-16-04445	010-075	55 lb	6.30"	17.13"	1
C-16-08789	010-170	79 lb	6.30"	17.13"	1
C-16-02622	010-172	28 lb	6.30"	17.13"	1-6
C-16-15645	010-225	20 lb	6.30"	17.13"	1-9
C-16-04270	010-253	45 lb	6.30"	17.13"	1
C-16-21871	010-602	100 lb	12.80"	29.75"	

Suspa No.	Part No.	P1 Force	Stroke Length	Extended Length C/L	Refer to Fit Chart
C-16-06889	010-624	97 lb	6.30"	17.13"	
C-16-21947	010-144	30 lb	7.28"	17.48"	1
C-16-21948	010-146	45 lb	7.28"	17.48"	1
C-16-20651	010-623	40 lb	7.87"	18.70"	
C-16-08054	010-051	100 lb	7.87"	19.69"	1-5-2
C-16-08053	010-077	80 lb	7.87"	19.69"	1-5-2
C-16-17566	010-164	150 lb	7.87"	19.69"	1-5-2
C-16-08376	010-165	135 lb	7.87"	19.69"	
C-16-17796	010-167	110 lb	7.87"	19.69"	1-5-2-3
C-16-08260	010-168	60 lb	7.87"	19.69"	1-5-2-3
C-16-08316	010-169	40 lb	7.87"	19.69"	1-2-5
C-16-08055	010-171	120 lb	7.87"	19.69"	1-5-2
C-16-09786	010-197	30 lb	7.87"	19.69"	1
C-16-21478A	010-521	180 lb	7.87"	19.69"	1
C-16-19222	010-603	90 lb	7.87"	19.69"	5
C-16-24764	010-608	13 lb	7.87"	19.69"	
C-16-08568	010-609	20 lb	7.87"	19.69"	
C-16-21950	010-190	60 lb	8.86"	20.83"	5
C-16-04650	010-293	160 lb	7.87"	21.00"	5
C-16-12181	010-158	150 lb	10.24"	26.34"	1
C-16-12038	010-159	120 lb	10.24"	26.34"	1
C-16-12666	010-160	100 lb	10.24"	26.34"	1
C-16-13334	010-161	87 lb	10.24"	26.34"	5
C-16-12492	010-162	74 lb	10.24"	26.34"	5
C-16-16142	010-163	60 lb	10.24"	26.34"	
C-16-20373	010-522	40 lb	12.24"	26.34"	1-5-7
C-16-13677	010-604	200 lb	11.81"	28.07"	4-7
C-16-23717	010-610	100 lb	12.38"	28.00"	
C-16-21871	010-602	100 lb	12.80"	29.75"	
C-16-10944	010-155	80 lb	16.14"	35.43"	5
C-16-10198	010-156	60 lb	16.14"	35.43"	5
C-16-27007A	010-123	250 lb	16.14"	35.43"	w/Clip

Fit Chart

- | | |
|----------------------------|-----------------------------|
| 1) MH - Motor Homes | 5) TL - Truck Lids |
| 2) TT - Travel Trailer | 6) Truck Cap Door / Windows |
| 3) TC - Tent Camper | 7) Cargo Trailer |
| 4) ST - Snowmobile Trailer | 8) Catering Truck |
| | 9) Goshen Coach |

Gas Props & Accessories

MEASUREMENTS

All lengths are measured from center to center of the cylinders end fittings.

A) is the extended length
B) is the compressed length
C) is the stroke length

The weight measurement should be stated on the chamber.

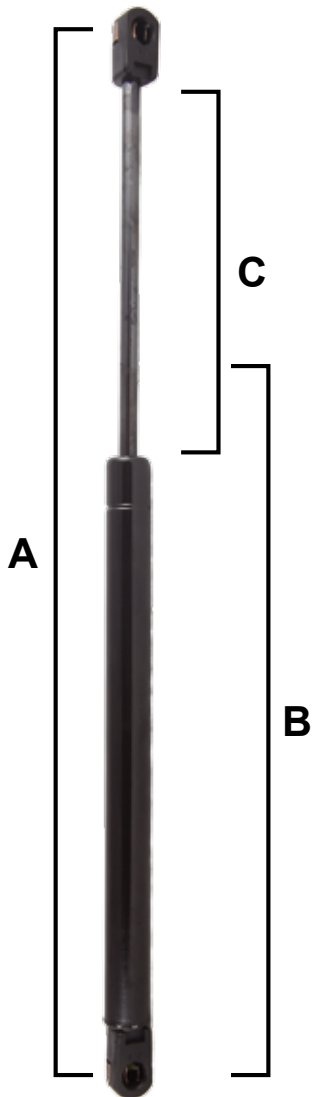

Installation Instructions

Have someone hold the hatch, hood, trunk, or rear window open while replacing the lift support. Do not use a prop.

Before removing the old lift support, examine any hardware provided to determine which components must be reused.

The new lift support must be installed in the same position as the one which was removed. Do not scratch rod.

When installing the rod, the chamber side must be placed upward while the rod side is down.

Removable Ball Connectors

Remove old lift support by prying off the retaining ring, cap lock, or the security lock ring.

Press new lift support onto ball stud and properly install retainer.

End Fittings



10mm Plastic Ball Socket w/ Integral Clip

010-233
fits 10" to 20" Prop

010-232
fits 21" to 36" Prop



8mm (5/16") Eyelet Style w/ Plastic Bushing Hole and Width .709" (18mm)

010-523
fits 10" to 20" Prop
(2/Ctn)

010-524
fits 21" to 36" Prop
(2/Ctn)

Gas Prop Brackets / Ball Studs

010-079
3/4" L Shaped
10mm Ball Stud
(1/Ctn)
010-079-2
(2/Ctn)



010-187
Hat Shaped Slotted
10mm Ball Stud
(1/Ctn)
010-187-2
(2/Ctn)



010-145
1-1/4" L Shaped
10mm Ball Stud
(1/Ctn)
010-145-2
(2/Ctn)



010-080
10mm Ball
(1/Ctn)
010-080-2
10mm Ball
(2/Ctn)
010-525-2
13mm Ball
(2/Ctn)



010-188
3" L Shaped
10mm Ball Stud
(1/Ctn)
010-188-2
(2/Ctn)



010-078
Flat Shaped
10mm Ball Stud
(1/Ctn)
010-078-2
(2/Ctn)



Adhesives

Automotive Black Silicone



Part No. 002-27039
Quantity 85 g
12/ctn

1200 Series Clear Silicone



Part No. 002-12007
Quantity 14 fl. oz.
24/ctn

1200 Series Black Silicone



Part No. 002-12270
Quantity 14 fl. oz.
24/ctn

Bulb Grease



Part No. 002-85184
Quantity 3 oz.
6/ctn

Black Silicone



Part No. 002-27039
Quantity 3 oz.
12/ctn

Fuel Tank Repair Kit



Part No. 002-90180
Quantity 30 g
6/ctn

Plastic Welding System



Part No. 002-47809
Quantity 25 ml
6/ctn

Flowable Windshield Silicone



Part No. 002-75009
Quantity 12/ctn

Yellow Weatherstrip Adhesive



Part No. 002-80050
Quantity 5 fl. oz.
12/ctn



Adhesives**Self-Fusing
Silicone
Tape**

Part No.
002-82112
Quantity
6/ctn

**Self-Fusing
Silicone
Tape
High Temp
Range**

Part No.
002-82114
Quantity
6/ctn

**WrapIt™
Repair
Silicone
Tape**

Part No.
002-82110
Quantity
6/ctn

**Threadlock
Blue**

Part No.
002-24536
Quantity
36 ml
12/ctn

**Plastic Tank
Repair Kit**

Part No.
002-90214
Quantity
30 g
6/ctn

**Fiberglass,
Porcelain, &
Plastic
Repair Kit**

Part No.
002-90216
Quantity
30 g
6/ctn

**Threadlock
Red**

Part No.
002-27536
Quantity
36 ml
12/ctn

**H2 Hold™
Underwater
Epoxy**

Part No.
002-22445
Quantity
25 ml
6/ctn

**Flow Mix®
Cold Weld
Epoxy**

Part No.
002-24445
Quantity
14 ml
6/ctn

**Clear Weld
Epoxy**

Part No.
002-47609
Quantity
25 ML
6/ctn

COIL N' WRAP Products

Water Hose Coiler

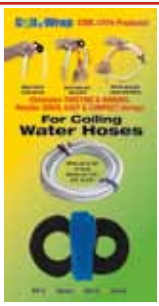

Part No.
006-1
Quantity
12/ctn

TV Cable Coiler

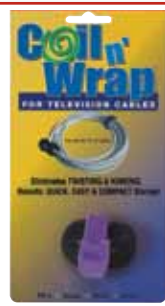

Part No.
006-2
Quantity
12/ctn

16 Gauge Extension Cord Coiler

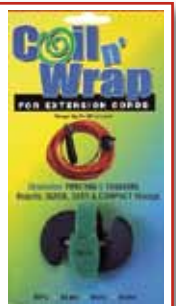

Part No.
006-3

30 Amp Electrical Cable Coiler

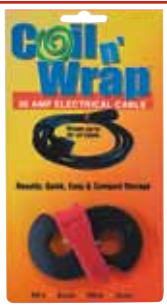

Part No.
006-4

10 Gauge Cords, Air & Propane Hoses Coiler

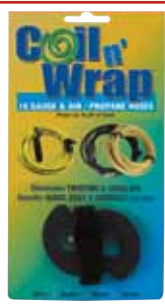

Part No.
006-5

12-14 Gauge Extension Cord Coiler

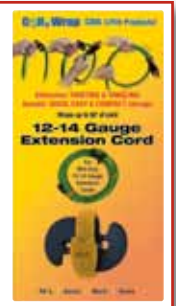

Part No.
006-43

Awning Cinch Straps



Part No.
006-6

Main/Patio Awning Pull Strap 96"



Part No.
006-17

Window Awning Pull Strap



Part No.
006-18

Awning Hangers



Part No.
006-20
Quantity
12/ctn

Clip n' Clamps



Part No.
006-21
Quantity
12/ctn

Velcro One Wrap Buckle Straps 6 Pack



Part No.
006-7
Quantity
12/ctn

Grommet Strap 18" Long - 1/pkg



Part No.
006-37
Quantity
12/ctn

Hi Temp Sticky Back Hook & Loop



Part No.
006-71
Quantity
12/ctn

Wonder Wrap (Singles)



Part No.
006-73
Quantity
12/ctn

COIL N' WRAP Products

16" Clinch Straps



Part No. 006-75
Quantity 12/ctn

Heavy Duty Carry Strap



Part No. 006-8

Bling Bling Blinker 6-Pack



2 each of Jade & Pink, Blue & White, and Red, White & Blue
Part No. 006-85-6

30 Amp Plug Dog 3 Prong



Part No. 006-15

50 Amp Plug Dog 4 Prong



Part No. 006-16

Bling Bling Blinker Display 36 Units



Part No. 006-85
Quantity 2/ctn

Light Check & Safety Plug



Part No. 006-114
Quantity 12/ctn

Xtreme Vent Coupler Kit



Part No. 006-99

Water Check Test Kit Display 12 Units



Part No. 006-115
Quantity 12/ctn

Xtreme Vent Grey



Part No. 006-80
Quantity 10/ctn

Xtreme Vent White



Part No. 006-79
Quantity 10/ctn

Glow Max Cordless Light Switch

- No Wiring Needed
- New C.O.B. Technology
- Batteries Included

- 3 Different Mounting Options
- Easy to Install
- Offered in 200 Lumens and 400 Lumens



025-020
200 Lumens



025-040
400 Lumens

Plug-Guard  **Total Plug Protection**

Clean, efficient and secure protection from the elements for the male plug of your trailer's wiring harness, while the trailer is not in use. Plug Guards attach to the hitch frame or to the 5th wheel box with two self rapping screws (included).



008-324
4-way Plug-Guard™



008-326
6-way Plug-Guard™



008-320
7-way Plug-Guard™

Nappy Kamper **Trailer Light Plug**

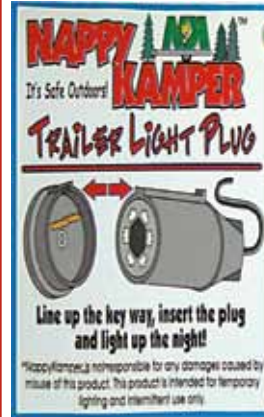

No tools or batteries needed. This unique device reroutes your battery charge line to light up your running lights on your trailer. Ideal for when you are plugged into Shore Power AC hook up. You will enjoy the festive light atmosphere as well as the safety of added light.



008-100 Trailer Light Plug

Fusion Wrap

Quick Emergency Repairs
No Adhesives
Bonds Only To Itself... Even If Wet!
Extreme Temperature Resistant
90°C to 260°C (550°F)
Insulates to 12,000 Volts
Uses for Wrap-id: Indoor/Outdoor, Electrical/Plumbing, House and Shop, Automotive/Trucking, RV/ Marine, Sport/Tool Handle Grip Wraps and Cable Wraps



006-WFP2012
Fusion Wrap 12' Roll



006-WFP2036
Fusion Wrap 36' Roll



006-WS25
Wrap-id Smooth 25' Roll

Super RV Jack Pad



- Great for every RV Owner in preventing the jack legs from sinking into the ground.
- Available in 2 packs or 4 packs
- Dimensions: 10" x 14" x 0.75" Thick
- Five Year Replacement Warranty
- Lightweight and easy to use
- Tested to handle 40,000 lbs.

007-27257 2 Pack
007-47257 4 Pack

Super Dolly Trailer



- The Super Dolly Trailer & Bus pad provides a safe and easy way to prevent stabilizer legs from sinking into the ground.
- Dimensions: 15" x 17" x 1" Thick
- Five Year Replacement Warranty
- Tested to handle 100,000 lbs.
- Use Perforated Side Up (Smooth Side Down)

007-87825 2 Pack

A mouse or rat problem in your RV is not only annoying, it can also be hazardous.

If mice or rats have infested your 'getaway', then your vehicle is prone to the expensive damage resulting from them chewing through wiring and nesting in vital components. Even worse, you and your family could be prone to offensive odors, potential messes and even disease.

Fresh Cab botanical rodent repellent is a 100% natural blend of corn cob chips, plants and herbal extracts that freshens and protects. Our all-natural repellent has the ability to repel mice & rats in leisure vehicles and hunting equipment and has been:

- Proven by several independent studies
- Registered by the federal EPA
- Awarded the USDA Green Seal of Approval

How it Works

Fresh Cab Pouches are made with a natural blend of plant fiber and botanical extracts that rodents find offensive, but people find pleasant. Simply place pouches in your recreational vehicles and property, depending on size and components, to immediately start controlling your mouse problem.



Fresh Cab

- 020-126**
U.S. Version
4 Pouches per Box
- 020-127**
Canadian Version
(meets local codes)
4 Pouches per Box
- 020-129**
12 Pack Clip Strip
U.S. Version
1 Pouch per Box
- 020-128**
8 Pack Display Tray
U.S. Version
1 Pouch per Box



Stay Away®

Place where food particles are present. Keeps ants out by emitting a scent pleasant to people, but offensive to super-sensitive ants.

020-130
Stay Away® Ants

Place around windows, doors, or anywhere you want to keep beetles and bugs from entering. Emits a rosemary scent that sends them back outdoors.

020-131
Stay Away® Beetles

Moths seek quiet, undisturbed areas to lay their eggs. Place pouches in these areas to protect your garmets. Pouches emit a scent pleasant to humans, but offensive to moths.

020-132
Stay Away® Moths

Place pouches to disrupt a spider's sophisticated senses, keeping them out of treated areas with a scent pleasant to humans, but offensive to spiders.

020-133
Stay Away® Spiders

Stay Away® Pouch Pod™

- Preserves the essential oils for up to 3x longer
- Prevents curious children and pets from tampering with pouch
- Protects finished wooded surfaces and clothing that may be affected by essential oils

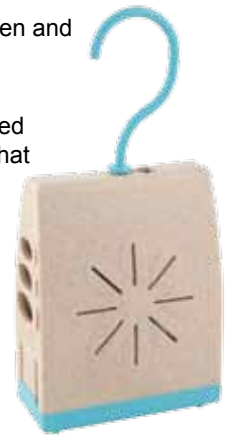

020-134
Stay Away® Pouch Pod™



Bug Shield



008-644
Climate Bug Shield
Hatch Door Seal
Seals gap between Electrical Cord and Hatch Door

008-645
Climate Bug Shield
Hatch Door Seal- Blank
Seals Hatch Door hole when not using cord

008-646
Climate Bug Shield
Hatch Door Seal- Round
Seals hole where Electrical Cord exits Hatch

Trailer/RV Shield keeps bugs, mice, and weather from infiltrating your living quarters. High quality, long lasting rubber. Made in the USA.

Star Lights - LED Lighting Solutions

Brilliant Light Fixture with LED Array Light fixture features advanced LED Array for greater light output, longer life and less power consumption than conventional incandescent bulbs. Fixture comes with standard "on/off switch" module. Additional modules may be purchased separately in order to add custom features/ Pick and choose the features that best suit your situation or environment.

Customizable Ceiling Light Brilliant Light 3002



016-BL3002 (4200K)
Single LED Light Fixture
016-BL3000
Single Incandescent Light Fixture
(5 1/4"H x 8 1/2"W x 2"D)

Customizable Ceiling Light Brilliant Light 3003



016-BL3003 (4200K)
Dual LED Light Fixture
016-BL3001
Dual Incandescent Light Fixture
(5 1/4"H x 12"W x 2"D)

Brilliant Modules/Accessories

Brilliant Modules are designed to be used with any Brilliant fixture. Select a module that offers the specific feature you desire and simply plug it into your fixture. Modules will allow you to enhance your fixture capabilities with features such as dimmer, motion light, etc...



Dimmer Dial
Enables user to adjust brightness of light output to meet desired effect.
016-BL3004



Night Light
Gives fixture a soft light at night allowing you to move about without disturbing others.
016-BL3005



Motion Detector
Enables fixture with motion sensing capabilities. Light will automatically come on at night when motion is detected.
016-BL3006



PCB Adapter
Allows you to insert a variety of custom modules, including a dimmer dial, led night light, motion sensor and more.
016-BL3007



Day/Night Sensor
Light will come on automatically at night time and turn off automatically when day time arrives.
016-BL3008



Replacement Lens
Replacement lens for Brilliant Light Single and Dual Dome Lights.
016-BL3009



12 Volt Jack
Can be inserted into any Brilliant Light Fixture. The module will power bunk lights, fans, and many other 12 volt accessories.
016-BL3010



Replacement LED
(4200K) **016-BL250**
Also available in 300 lumens
(4200K) **016-BL300**

Star Lights - Exterior/Interior Light Fixtures

12v Exterior Lighting Replacement Scare Light 2000

Flush mount easy install replacement scare light fixture. DOT compliant and LED compatible. May be connected with any motion activated Smart Light to turn on and off simultaneously (using the 2000FB fused switch box). 9 1/4"H x 11 1/4"W x 2 1/4"D
016-RSL2000 WHITE
016-RSL2000B BLACK



Solarian LED Round Light Fixture

Surface mount interior LED replacement fixture. Produces 330 LMS of warm light. State of the art PWM ensures voltage spikes will not damage the unit (8-30 volts). Specially designed lens disperses light evenly allowing the entire face to glow. Simple 2 wire installation. Low profile. 5"R x 1"D
016-SON 102 BLACK
016-SON 103 WHITE
016-SON 104 BRUSHED NICKEL



Motion Activated Lighting Fixtures



Illuminates those areas around your RV for safety and security. Motion range can be set for 10-25 feet. Installs easily, uses same hole pattern and wiring as most standard lights. Star Monitor indicates RV's battery condition and helps preserve your coach battery.
 4 1/4"H x 10"W x 2"D
016-SL1000 WHITE
016-SL1000B BLACK
016-RL1000 CLEAR LENS KIT
016-AL1000 AMBER LENS KIT
 9 1/4"H x 12 1/4"W x 2"D
016-SL2000 WHITE
016-SL2000B BLACK
016-RL2000 CLEAR LENS KIT
016-AL2000 AMBER LENS KIT

LED Motion Sensor Light Fixture Solarion 300™

Motion activated, surface mounted ceiling replacement LED light fixture. 2-way switch allows for continuous on or motion activated mode. Simple two wire installation. Long Life- unit will last 50,000 hours. 330 lumens; 3200 kelvins; 3.599 watts; 8-30 voltage. For interior use only.
016-SON 300 WHITE
016-SON 301 BRUSHED NICKEL

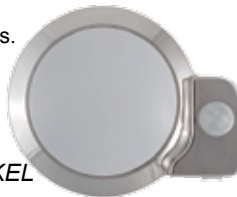

Universal 12v Dimmer Switch Brilliant Light 4000™

This universal dimmer switch will dim any 12 volt LED or incandescent fixture. Dims multiple lights on the same circuit. Unit will dim from 12 to 0 volts. Internal fuse protection. Smooth incremental dimming stages create an even and pleasant light at any level. For interior use only. Dimmer can be reset by holding the switch in down position for 5 seconds.
016-BL4000 BLACK
016-BL4001 WHITE



Amberizer Anti Bug Bulb

Can be used with 1000 or 2000 Light Series. 2 Pack
016-AB10



Fused Relay Box

Synchronizes lighting fixtures and other electrical components to safely turn on and off simultaneously.
016-2000FB



Revolution SL-5000 RGB Color Changing LED Strip Light

Revolution 5000 LED Strip Light-RF Controller

Red industrial strength 3M tape ensures the light will adhere to nearly any surface. PU glue is water and UV resistant. Customizable- can be cut every 2 inches to desired length. Remote can program the light to dim, fade, strobe, change color and more. 3mm Thickness, RF Control, 16' Long
016-SL-5100



Strip Light Connector Kit

10 piece strip light connector kit. Customize your strip lights by cutting, splicing, and extending the rope light with the help of this kit.
016-SL5001



Music Box

The patented program allows your lights to turn on and off to the beat of the music. Lights will illuminate a single color, or multiple variations if chosen. Dial allows for many strobe patterns and speeds.
016-SL5002



Strip Light 110 Adapter

110v AC/12 v DC adapter. Universal plug allows high power 12 volt DC items to operate on 110v AC power. Compatible with LED light strips, and many other DC applications. 5 amp max.
016-SL5004



Strip Light Controller

Strip light remote control and IR RGB receiver. This remote can control the rope lights' brightness, color (16 different colors), or lighting effects- such as strobe, dim, fade and more. May be used on nearly any 12 volt strip/rope light.
016-SL5003



Controller Battery

Universal 3 volt lithium replacement battery.
016-CR2025



Star Lights - 12V Interior Replacement Bulbs & Lighting Fixtures

921-160/250

Patented design allows all 250 LMS of light to be directed where the light is needed. State of the art PWM (8-30v). Produces a warm light, and is available in 160 LMS option.
016-921-160 (3200K)
016-921-250 (3200K)



1141-150/200/300

Patented rotating design allows the light to be directed. State of the art PWM (8-30v). Available in cool and warm white, as well as white and black housings.
016-1141-150 (6500K)
016-1141-200 (6500K)
016-1141-200B (6500K)
016-1141-250 (3200K)
016-1141-300 (6500K)
016-1141-300B (6500K)



921-280/290

Fully dimmable, no EMI omnidirectional replacement. interior, exterior back up and brake lights. Available in cool white, warm white, and red.
016-921-280 (3200)
016-921-280R (RED)
016-921-290 (6500)



T8-18 & T8-15 LED

Patented quick connect wiring harness makes for easy installation, no need to cut out ballast or remove wires. State of the art PWM ensures voltage spikes will not damage the unit (9-25v). Extremely bright 810 LMS lasts 12 times longer. No mercury or other harmful chemicals. Runs cooler with no humming or buzzing. Produces a very clean, bright white light (85 CRI).
016-T818 18" LED
016-T512 12" LED



G4-160/205

Bi pin JC10 halogen replacement. Patented copper ribbon heat sync draws heat away from the components. Patented adjustable tilted housing allows for easy installation in small fixtures. State of the art PWM ensures voltage spikes will not damage the unit (8-30v). Available in side pin and back pin configurations.
016-G4-160SP (4200K) **016-G4205SP (4200K)**
016-G4160BP (4200K) **016-G4205BP (4200K)**



1141-350/400

Patented design allows the head to swivel. Available in warm and cool white. State of the art PWM ensures voltage spikes will not damage the unit (8-18v). Water proof design allows for interior and exterior use.
016-1141-350 (4100K)
016-1141-400 (6500K)



2099-230/270

Very bright frosted vanity bulb. State of the art PWM ensures voltage spikes will not damage the unit (8-30v). Available in cool and warm white.
016-2099-270 (3100)
016-2099-230 (6500)



1383-220/230

Standard BA15S base flood reading light. State of the art PWM ensures voltage spikes will not damage the unit (8-30v). Available in cool and warm white.
016-1383-220 (3100k)
016-1383-230 (6500k)



921-220/230

Wedge based flood reading light. State of the art PWM ensures voltage spikes will not damage the unit (8-30v). Available in cool and warm white.
016-921-220 (3100K)
016-921-230 (6500K)



1076-205/255

Dual contact single circuit dimmable omnidirectional replacement. No EMI.
016-1076-205 (3200K)
016-1076-255 (3200K)



Delux LED Cool White Bulb Replacements

SX T5

12" LED quick connect tube replacement.
 Lumens - 400
 Amp Draw - .340
016-781T5



SX T8

18" LED quick connect tube replacement.
 Lumens - 810
 Amp Draw - .326
016-781T8



SX G4

Bipin hogen replacement bulb. Replaces JC10
 Lumens - 135
 Amp Draw - .183
016-781G4



SX 921

Wedge base LED replacement.
 Lumens - 135
 Amp Draw - .183
016-781921



SX 1000

Universal adaptor kit & light board. (Replaces 1156, 921 & 1036 festoon fitting.)
 Lumens - 230
 Amp Draw - .233
016-7811000

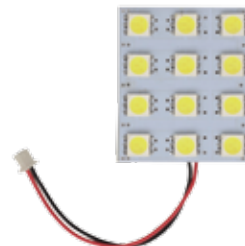

SX 1156

Bayonet LED replacement.
 Lumens - 150
 Amp Draw - .266
016-7811156



Star Lights - 12V Exterior Replacement Bulbs (EMI Free)

7440-280

2 pack single circuit tail light bulb.

016-7440-280 (6500K)
016-7440-280A (Amber)
016-7440-280R (Red)



7443-280

2 pack dual circuit tail light bulb.

016-7443-280 (6500K)
016-7443-280A (Amber)
016-7443-280R (Red)



1141-280/290

1 pack single circuit tail light bulb

016-1141-280 (3200K)
016-1141-280R (Red)
016-1141-290 (6500K)



3157-280

2 pack dual circuit tail light bulb.

016-3157-280 (6500K)
016-3157-280A (Amber)
016-3157-280R (Red)



1156-170

2 pack single circuit tail light bulb.

016-1156-170 (6500K)
016-1156-170A (Amber)
016-1156-170R (Red)



1036-25

2 pack single circuit running light bulb.

016-1036-25 (6500K)
016-1036-25R (Red)



194-70

2 pack single circuit running light bulb.

016-194-70 (6500K)
016-194-70A (Amber)
016-194-70R (Red)



3156-280

2 pack single circuit tail light bulb.

016-3156-280 (6500K)
016-3156-280A (Amber)
016-3156-280R (Red)



1157-170

2 pack dual circuit tail light bulb.

016-1157-170 (6500K)
016-1157-170A (Amber)
016-1157-170R (Red)



LOAD RESISTOR

Simulates a filament bulb load in case of increase turn signal flash rate.

016-157LR



57-75

Replaces BA95 base 57 incandescent. Used for side marker, parking lights, instrument panel and more. 2 pack

016-57-75



Incandescent Bulb Replacements

57 BASE

016-02-57



194 BASE

016-02-194



921 BASE

016-02-921



JC 10 BASE

016-02-JC10



1036 BASE

016-02-1036



1003 BASE

016-02-1003



1156 BASE

016-02-1141-1156



1157 BASE

016-02-1157



1076 BASE

016-02-1076



1383 BASE

016-01-1383



2099 BASE

016-01-2099



3156 BASE

016-02-3156



3157 BASE

016-02-3157

BANDING THE WORLD TOGETHER.

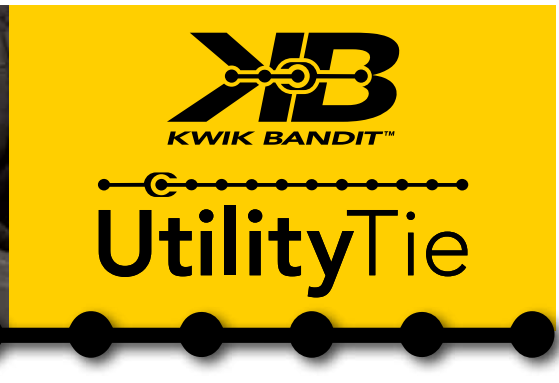

KWIK BANDIT™ THE UTILITY TIE THAT YOU CAN'T LIVE WITHOUT, OR SHOULDN'T.

This easy connect system makes **Kwik Bandit™** very simple to use, just Stretch it, Wrap it and Lock it in place. If you spend any time outdoors then you need the best single piece of gear that has unlimited uses – **Kwik Bandit™**.

No knots to tie, and no rope to cut; replaces all bungee cords, zip ties and straps in your possession. Our product lasts longer than conventional binding and banding products, **Kwik Bandit™** stands strong, and is ready to use, again and again.

Available in 8, 14 and 24 inch lengths the **Kwik Bandit™** is super strong and resilient. Easy on the hands, no snap back like traditional bungee cords and are good in temperatures from -55°C to 120°C.



Available in 8, 14 and 24 inch lengths

Check out our introductory offer, and wrap your minds around this great new innovation.

STRETCH, WRAP, LOCK.



EASY TO USE



SAFER THAN ROPES

KWIK BANDIT™ Versatile, safe and easy to use banding product that is long lasting and reusable. **Stretch** it, **Wrap** it and **Lock** it in place.

Mini 008-7825



THE SMALLEST VERSION OF OUR PRODUCT LINE; COMPACT, EASY TO USE - PERFECT FOR QUICK, SMALL JOBS.

Made with a highly durable rubber compound that resists extreme weather, sun damage and repeat usage.

Kwik Bandit™ can be stored in a glove box, tool box, drawer or even your pocket. No cumbersome, knotted ropes, ratchets, or clumsy and dangerous bungee hooks. Great for around the house, shop, cottage, garden, and vineyard.

The Mini **Kwik Bandit™** has a 10lb. axial Work Load Limit (WLL), 8 inches in length, cord diameter of 1/8" and 1/4" ball stops.

Heavy Duty 008-7242



THE LARGEST OF THE **KWIK BANDIT™** PRODUCT LINE, HAS THE HIGHEST TENSILE STRENGTH AND CAN BE USED IN INDUSTRIAL SETTINGS FOR SECURING THOSE HEAVY LOADS.

Combined with either the Standard (UT14-2LP) or Heavy Duty (UT24-2LP) Lock Pin options, you can easily combine several together, forming a strong chain. A great way to work with very large objects or securing and bundling all your industrial materials.

Kwik Bandit™ replaces those other dangerous binding products that have caused serious workplace injuries from normal operation. Perfect for organizing large cables and hoses, for binding pipes, tubes and cam lock safety straps.

The Heavy Duty **Kwik Bandit™** has a 75lb. axial Work Load Limit (WLL), 24 inches in length, cord diameter of 5/16" and 3/8" ball stops. (Maximum bundling diameter of 8 inches using a single band).

Standard 008-7142



THE MID-SIZED **KWIK BANDIT™** IS LONGER AND PERFECT FOR TYING DOWN LOADS FOR TRANSPORT AND SECURING EQUIPMENT.

The standard **Kwik Bandit™** with the Lock Pin (UT14-2LP) option can be easily combined to form long chain of rubber bands which are ideal for securing small to medium sized sports equipment to a roof rack, organize musical equipment, yard and garden tools hang easily and quickly.

These easy to use locking straps require no knots or complex ratchet straps, just a simple **Stretch, Wrap, Lock.**

The Standard **Kwik Bandit™** has a 50lb. axial Work Load Limit (WLL), 14 inches in length, cord diameter of 1/4" and 1/2" ball stops.

Kwik Bandit™ offers a 30 day guarantee on its products from defect in workmanship or materials.



Tank Check™

Accurately Measures Level Of LP

The LPG Tank Check is able to accommodate a variety of LP Tanks and provide you with up to date levels. Tank Check's unique Sensors accurately measure your Tanks LP level and communicate that information to you via the optional Monitor or through the use of most any device equipped with Blue Tooth. The Sensor's Blue Tooth communications range enables remote monitoring up to 50' away, depending upon obstructions such as walls and other material. Monitoring the Sensor with a smart device requires downloading the free App. Visit www.mopeka.com



MANY USES



Fork Lift Tank



RV Tanks



Home LP Tank



Home BBQ



Save The Hassle Of Constantly Checking Your LP Tank Level

Monitor It With Tank Check!

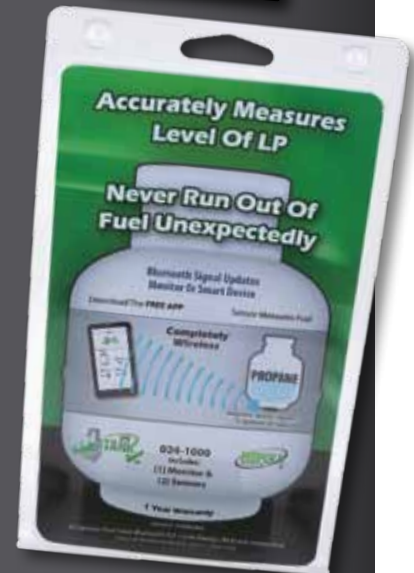

Part#	Description
024-1000	LP Tank Check Dual Sensor w/Monitor Kit
024-1001	LP Tank Check Single Sensor
024-1002	LP Tank Check Dual Sensor
024-1003	LP Tank Check 15 Pack
024-1004	LP Tank Check Monitor
024-1005	LP Tank Check Spacers
024-2001	LP Tank Check XL Sensor



LP Tank Stand 024-5001

- Light Weight and Folds Easily for Storage
- Stabilizes Cylinders on Uneven Surfaces
- Made from Heavy Duty Industrial Plastic
- For Use with 20, 30 or 40lb. Cylinders

NOCO® Snap-Top

SNAP-TOP® BATTERY BOXES



Injection molded polypropylene plastic boxes collect battery electrolytes, allow ventilation, and prevent accidental contact of ungrounded battery terminals. The patented Snap-Top® lid secures the lid to the base, heavy-duty handles resist cracking, and vent hole cover plugs limit water entry.

- 013-199** HM300BK, Standard Box, Black
Standard Box Fits Group 24 Batteries
Inside: (11"L x 7.87"W x 9.75"H),
Outside: (13.38"L x 10.13"W x 11"H)
- 013-200** HM327BK, Medium Box, Black
Medium Box Fits Group 27 Batteries
Inside: (13.38"L x 7.75"W x 10" H),
Outside: (16"L x 9.25"W x 10.25"H)
- 013-236** HM318BK, Large Box, Black
Large Box Fits Group 24-31 Batteries
Inside: (14.50"L x 7.87"W x 10"H),
Outside: (17.75"L x 10.13"W x 10.50"H)
- 013-526** HM306BK, 6V Single
Fits 6V Batteries
Inside: (11"L x 7.87"W x 12"H)
Outside: (13.38"L x 10.13"W x 12.25"H)

HEAVY-DUTY BATTERY BOXES

Dual, 6V battery boxes are rotationally molded from LLDPE. Feature a four-corner fastening system, captive lid, large cable entry holes, a large electrolyte reservoir, and full flow ventilation. Resists acid, gasoline, oil, salt, and chemicals. Impact resistant to -40°F (-40°C)



- 013-668** HM408, 6V Dual, End to End
Inside: (21"L x 9"W x 10.5"H),
Outside: (24.5"L x 12.5"W x 13"H)
- 013-669** HM426, 6V Dual, Side by Side
Inside: (14.75"L x 10.75"W x 12"H),
Outside: (18.25"L x 14.25"W x 14"H)

BATTERY TRAYS & STRAPS

Heavy-duty injection molded plastic battery tray is corrosion resistant. External mounting holes to resist battery movement.



- 013-11124** BT24, Battery Tray (Group 24)
(11.5"L x 8.4"W x 1.3"H)
- 013-11127** BT27, Battery Tray (Group 27)
(13.3"L x 8.4"W x 1.3"H)
- 013-670** BT31, Battery Tray (Group 31)
(14"L x 8.4"W x 1.3"H)
- 013-201** HM001, Replacement Battery Strap 42"L
- 013-607** HM006, Replacement Battery Strap 54"L



UV
RESISTANT

MADE IN USA

2018[©]

AP *Products*

200 Jay Street
Coldwater, MI 49036
www.approducts.net
517-278-8521
800-417-2477
Fax: 517-278-2457